

Iron Pipe Fittings

Galvanized & Black Pipe Fittings



1/8" Nipples

Galv. Order No.	Price Ref. #	Black Order No.	Price Ref. #	Size (in)	Wt (lbs)
N18*CLG	MM00001	N18*CLB	MM00002	1/8 x close	0.02
N18*112G	MM00003	N18*112B	MM00004	1/8 x 1-1/2	0.02
N18*2G	MM00005	N18*2B	MM00006	1/8 x 2	0.04
N18*212G	MM00007	N18*212B	MM00008	1/8 x 2-1/2	0.05
N18*3G	MM00009	N18*3B	MM00010	1/8 x 3	0.06
N18*312G	MM00011	N18*312B	MM00012	1/8 x 3-1/2	0.07

1/4" Nipples

N14*CLG	MM00019	N14*CLB	MM00020	1/4 x close	0.02
N14*112G	MM00021	N14*112B	MM00022	1/4 x 1-1/2	0.05
N14*2G	MM00023	N14*2B	MM00024	1/4 x 2	0.06
N14*212G	MM00025	N14*212B	MM00026	1/4 x 2-1/2	0.08
N14*3G	MM00027	N14*3B	MM00028	1/4 x 3	0.1
N14*312G	MM00029	N14*312B	MM00030	1/4 x 3-1/2	0.1
N14*4G	MM00031	N14*4B	MM00032	1/4 x 4	0.1
N14*412G	MM00033			1/4 x 4-1/2	0.2

3/8" Nipples

N38*CLG	MM00044	N38*CLB	MM00045	3/8 x close	0.04
N38*112G	MM00046	N38*112B	MM00047	3/8 x 1-1/2	0.07
N38*2G	MM00048	N38*2B	MM00049	3/8 x 2	0.09
N38*212G	MM00050	N38*212B	MM00051	3/8 x 2-1/2	0.1
N38*3G	MM00052	N38*3B	MM00053	3/8 x 3	0.2
N38*312G	MM00054			3/8 x 3-1/2	0.2

1/2" Nipples

N12*CLG	MM00064	N12*CLB	MM00065	1/2 x close	0.06
N12*112G	MM00066	N12*112B	MM00067	1/2 x 1-1/2	0.09
N12*2G	MM00068	N12*2B	MM00069	1/2 x 2	0.1
N12*212G	MM00070	N12*212B	MM00071	1/2 x 2-1/2	0.2
N12*3G	MM00072	N12*3B	MM00073	1/2 x 3	0.2
N12*312G	MM00074	N12*312B	MM00075	1/2 x 3-1/2	0.2
N12*4G	MM00076	N12*4B	MM00077	1/2 x 4	0.3
N12*412G	MM00078	N12*412B	MM00079	1/2 x 4-1/2	0.3
N12*5G	MM00080	N12*5B	MM00081	1/2 x 5	0.3
N12*512G	MM00082	N12*512B	MM00083	1/2 x 5-1/2	0.4

3/4" Nipples

N34*CLG	MM00107	N34*CLB	MM00108	3/4 x close	0.9
N34*112G	MM00109	N34*112B	MM00110	3/4 x 1-1/2	0.1
N34*2G	MM00111	N34*2B	MM00112	3/4 x 2	0.2
N34*212G	MM00113	N34*212B	MM00114	3/4 x 2-1/2	0.2
N34*3G	MM00115	N34*3B	MM00116	3/4 x 3	0.3
N34*312G	MM00117	N34*312B	MM00118	3/4 x 3-1/2	0.3
N34*4G	MM00119	N34*4B	MM00120	3/4 x 4	0.4
N34*412G	MM00121	N34*412B	MM00122	3/4 x 4-1/2	0.4
N34*5G	MM00123	N34*5B	MM00124	3/4 x 5	0.4
N34*512G	MM00125	N34*512B	MM00126	3/4 x 5-1/2	0.5

- Economical iron pipe fittings
- Galvanized: Galvanized finish resists rusting & corrosion
- Black: Excellent for use w/ oil, hot water, & air



Galv. Order No.	Price Ref. #	Black Order No.	Price Ref. #	Size (in)	Wt (lbs)
N18*4G	MM00013	N18*4B	MM00014	1/8 x 4	0.08
N18*412G	MM00015			1/8 x 4-1/2	0.09
N18*5G	MM00016			1/8 x 5	0.1
N18*512G	MM00017			1/8 x 5-1/2	0.1
N18*6G	MM00018			1/8 x 6	0.1

N14*5G	MM00034	N14*5B	MM00035	1/4 x 5	0.2
N14*512G	MM00036			1/4 x 5-1/2	0.2
N14*6G	MM00037	N14*6B	MM00038	1/4 x 6	0.2
N14*12G	MM00039			1/4 x 12	0.4
N14*18G	MM00040			1/4 x 18	0.6
N14*24G	MM00041			1/4 x 24	0.9
N14*36G	MM00042			1/4 x 36	1.3
N14*48G	MM00043			1/4 x 48	1.7

N38*4G	MM00055	N38*4B	MM00056	3/8 x 4	0.2
N38*412G	MM00057			3/8 x 4-1/2	0.2
N38*5G	MM00058	N38*5B	MM00059	3/8 x 5	0.3
N38*512G	MM00060	N38*512B	MM00061	3/8 x 5-1/2	0.3
N38*6G	MM00062	N38*6B	MM00063	3/8 x 6	0.3

N12*6G	MM00084	N12*6B	MM00085	1/2 x 6	0.4
N12*7G	MM00086	N12*7B	MM00087	1/2 x 7	0.5
N12*8G	MM00088	N12*8B	MM00089	1/2 x 8	0.6
N12*10G	MM00090			1/2 x 10	0.7
N12*12G	MM00091	N12*12B	MM00092	1/2 x 12	0.8
N12*18G	MM00093	N12*18B	MM00094	1/2 x 18	1.3
N12*24G	MM00095	N12*24B	MM00096	1/2 x 24	1.7
N12*30G	MM00097	N12*30B	MM00098	1/2 x 30	2.1
N12*36G	MM00099	N12*36B	MM00100	1/2 x 36	2.5
N12*48G	MM00101	N12*48B	MM00102	1/2 x 48	3.4
N12*60G	MM00103	N12*60B	MM00104	1/2 x 60	4.3
N12*120G	MM00105	N12*120B	MM00106	1/2 x 120	8.5

N34*6G	MM00127	N34*6B	MM00128	3/4 x 6	0.5
N34*8G	MM00129	N34*8B	MM00130	3/4 x 8	0.7
N34*10G	MM00131	N34*10B	MM00132	3/4 x 10	0.9
N34*12G	MM00133	N34*12B	MM00134	3/4 x 12	1.1
N34*18G	MM00135	N34*18B	MM00136	3/4 x 18	1.7
N34*24G	MM00137	N34*24B	MM00138	3/4 x 24	2.2
N34*30G	MM00139	N34*30B	MM00140	3/4 x 30	2.8
N34*36G	MM00141	N34*36B	MM00142	3/4 x 36	3.4
N34*48G	MM00143	N34*48B	MM00144	3/4 x 48	4.5
N34*60G	MM00145	N34*60B	MM00146	3/4 x 60	5.6
N34*120G	MM00147	N34*120B	MM00148	3/4 x 120	11.3

1" Nipples

Galv. Order No.	Price Ref. #	Black Order No.	Price Ref. #	Size (in)	Wt (lbs)
N1*CLG	MM00149	N1*CLB	MM00150	1 x close	0.2
N1*2G	MM00151	N1*2B	MM00152	1 x 2	0.2
N1*212G	MM00153	N1*212B	MM00154	1 x 2-1/2	0.2
N1*3G	MM00155	N1*3B	MM00156	1 x 3	0.3
N1*312G	MM00157	N1*312B	MM00158	1 x 3-1/2	0.4
N1*4G	MM00159	N1*4B	MM00160	1 x 4	0.5
N1*412G	MM00161	N1*412B	MM00162	1 x 4-1/2	0.5
N1*5G	MM00163	N1*5B	MM00164	1 x 5	0.6
N1*512G	MM00165	N1*512B	MM00166	1 x 5-1/2	0.7
N1*6G	MM00167	N1*6B	MM00168	1 x 6	0.7

1-1/4" Nipples

N114*CLG	MM00189	N114*CLB	MM00190	1-1/4 x close	0.2
N114*2G	MM00191	N114*2B	MM00192	1-1/4 x 2	0.3
N114*212G	MM00193	N114*212B	MM00194	1-1/4 x 2-1/2	0.4
N114*3G	MM00195	N114*3B	MM00196	1-1/4 x 3	0.5
N114*312G	MM00197	N114*312B	MM00198	1-1/4 x 3-1/2	0.6
N114*4G	MM00199	N114*4B	MM00200	1-1/4 x 4	0.7
N114*412G	MM00201	N114*412B	MM00202	1-1/4 x 4-1/2	0.8
N114*5G	MM00203	N114*5B	MM00204	1-1/4 x 5	0.8
N114*512G	MM00205	N114*512B	MM00206	1-1/4 x 5-1/2	0.9
N114*6G	MM00207	N114*6B	MM00208	1-1/4 x 6	1.0

1-1/2" Nipples

N112*CLG	MM00229	N112*CLB	MM00230	1-1/2 x close	0.3
N112*2G	MM00231	N112*2B	MM00232	1-1/2 x 2	0.3
N112*212G	MM00233	N112*212B	MM00234	1-1/2 x 2-1/2	0.4
N112*3G	MM00235	N112*3B	MM00236	1-1/2 x 3	0.6
N112*312G	MM00237	N112*312B	MM00238	1-1/2 x 3-1/2	0.7
N112*4G	MM00239	N112*4B	MM00240	1-1/2 x 4	0.8
N112*412G	MM00241	N112*412B	MM00242	1-1/2 x 4-1/2	0.9
N112*5G	MM00243	N112*5B	MM00244	1-1/2 x 5	1.0
N112*512G	MM00245	N112*512B	MM00246	1-1/2 x 5-1/2	1.2
N112*6G	MM00247	N112*6B	MM00248	1-1/2 x 6	1.2

2" Nipples

N2*CLG	MM00269	N2*CLB	MM00270	2 x close	0.5
N2*212G	MM00271	N2*212B	MM00272	2 x 2-1/2	0.6
N2*3G	MM00273	N2*3B	MM00274	2 x 3	0.8
N2*312G	MM00275	N2*312B	MM00276	2 x 3-1/2	0.9
N2*4G	MM00277	N2*4B	MM00278	2 x 4	1.1
N2*412G	MM00279	N2*412B	MM00280	2 x 4-1/2	1.2
N2*5G	MM00281	N2*5B	MM00282	2 x 5	1.4
N2*512G	MM00283	N2*512B	MM00284	2 x 5-1/2	1.5
N2*6G	MM00285	N2*6B	MM00286	2 x 6	1.7
N2*8G	MM00287	N2*8B	MM00288	2 x 8	2.3

2-1/2" Nipples

N212*CLG	MM00307	N212*CLB	MM00308	2-1/2 x close	0.7
N212*3G	MM00309	N212*3B	MM00310	2-1/2 x 3	0.9
N212*4G	MM00311	N212*4B	MM00312	2-1/2 x 4	1.7
N212*5G	MM00313	N212*5B	MM00314	2-1/2 x 5	2.2

3" Nipples

N3*CLG	MM00320	N3*CLB	MM00321	3 x close	0.9
N3*3G	MM00322	N3*3B	MM00323	3 x 3	1.3
N3*4G	MM00324	N3*4B	MM00325	3 x 4	1.9
N3*5G	MM00326	N3*5B	MM00327	3 x 5	2.4

4" Nipples

N4*CLG	MM00335	N4*CLB	MM00336	4 x close	1.7
N4*4G	MM00337	N4*4B	MM00338	4 x 4	2.6
N4*5G	MM00339	N4*5B	MM00339	4 x 5	3.5
N4*6G	MM00340	N4*6B	MM00341	4 x 6	4.1

Galv. Order No.	Price Ref. #	Black Order No.	Price Ref. #	Size (in)	Wt (lbs)
N1*8G	MM00169	N1*8B	MM00170	1 x 8	1.0
N1*10G	MM00171	N1*10B	MM00172	1 x 10	1.3
N1*12G	MM00173	N1*12B	MM00174	1 x 12	1.6
N1*18G	MM00175	N1*18B	MM00176	1 x 18	2.4
N1*24G	MM00177	N1*24B	MM00178	1 x 24	3.2
N1*30G	MM00179	N1*30B	MM00180	1 x 30	4.1
N1*36G	MM00181	N1*36B	MM00182	1 x 36	4.9
N1*48G	MM00183	N1*48B	MM00184	1 x 48	6.6
N1*60G	MM00185	N1*60B	MM00186	1 x 60	8.3
N1*120G	MM00187	N1*120B	MM00188	1 x 120	16.5

N114*8G	MM00209	N114*8B	MM00210	1-1/4 x 8	1.4
N114*10G	MM00211	N114*10B	MM00212	1-1/4 x 10	1.8
N114*12G	MM00213	N114*12B	MM00214	1-1/4 x 12	2.2
N114*18G	MM00215	N114*18B	MM00216	1-1/4 x 18	3.3
N114*24G	MM00217	N114*24B	MM00218	1-1/4 x 24	4.4
N114*30G	MM00219	N114*30B	MM00220	1-1/4 x 30	5.6
N114*36G	MM00221	N114*36B	MM00222	1-1/4 x 36	6.7
N114*48G	MM00223	N114*48B	MM00224	1-1/4 x 48	9.0
N114*60G	MM00225	N114*60B	MM00226	1-1/4 x 60	11.3
N114*120G	MM00227	N114*120B	MM00228	1-1/4 x 120	22.5

N112*8G	MM00249	N112*8B	MM00250	1-1/2 x 8	1.7
N112*10G	MM00251	N112*10B	MM00252	1-1/2 x 10	2.1
N112*12G	MM00253	N112*12B	MM00254	1-1/2 x 12	2.6
N112*18G	MM00255	N112*18B	MM00256	1-1/2 x 18	4.0
N112*24G	MM00257	N112*24B	MM00258	1-1/2 x 24	5.3
N112*30G	MM00259	N112*30B	MM00260	1-1/2 x 30	6.7
N112*36G	MM00261	N112*36B	MM00262	1-1/2 x 36	8.0
N112*48G	MM00263	N112*48B	MM00264	1-1/2 x 48	10.7
N112*60G	MM00265	N112*60B	MM00266	1-1/2 x 60	13.5
N112*120G	MM00267	N112*120B	MM00268	1-1/2 x 120	26.9

N2*10G	MM00289	N2*10B	MM00290	2 x 10	2.9
N2*12G	MM00291	N2*12B	MM00292	2 x 12	3.5
N2*18G	MM00293	N2*18B	MM00294	2 x 18	5.3
N2*24G	MM00295	N2*24B	MM00296	2 x 24	7.2
N2*30G	MM00297	N2*30B	MM00298	2 x 30	9.0
N2*36G	MM00299	N2*36B	MM00300	2 x 36	10.8
N2*48G	MM00301	N2*48B	MM00302	2 x 48	14.5
N2*60G	MM00303	N2*60B	MM00304	2 x 60	18.1
N2*120G	MM00305	N2*120B	MM00306	2 x 120	36.2

N212*6G	MM00315	N212*6B	MM00316	2-1/2 x 6	2.1
		N212*8B	MM00317	2-1/2 x 8	3.3
		N212*10B	MM00318	2-1/2 x 10	4.4
		N212*12B	MM00319	2-1/2 x 12	4.7

N3*6G	MM00328	N3*6B	MM00329	3 x 6	2.9
N3*8G	MM00330	N3*8B	MM00331	3 x 8	4.2
		N3*10B	MM00332	3 x 10	5.2
N3*12G	MM00333	N3*12B	MM00334	3 x 12	6.8

		N4*8B	MM00342	4 x 8	5.6
		N4*10B	MM00343	4 x 10	7.9
		N4*12B	MM00344	4 x 12	9.0



Iron Pipe Fittings

Elbows - 90°

Galv. Order No.	Price Ref. #	Black Order No.	Price Ref. #	Size (in)	Wt (lbs)
L18G	MM00345	L18B	MM00346	1/8	0.06
L14G	MM00347	L14B	MM00348	1/4	0.1
L38G	MM00349	L38B	MM00350	3/8	0.2
L12G	MM00351	L12B	MM00352	1/2	0.2
L34G	MM00353	L34B	MM00354	3/4	0.4
L1G	MM00355	L1B	MM00356	1	0.6

Galv. Order No.	Price Ref. #	Black Order No.	Price Ref. #	Size (in)	Wt (lbs)
L114G	MM00357	L114B	MM00358	1-1/4	0.9
L112G	MM00359	L112B	MM00360	1-1/2	1.2
L2G	MM00361	L2B	MM00362	2	1.8
L212G	MM00363	L212B	MM00364	2-1/2	3.5
L3G	MM00365	L3B	MM00366	3	5.4
L4G	MM00367	L4B	MM00368	4	9.0

Elbows - 45°

L18G45	MM00369	L18B45	MM00370	1/8	0.07
L14G45	MM00371	L14B45	MM00372	1/4	0.1
L38G45	MM00373	L38B45	MM00374	3/8	0.2
L12G45	MM00375	L12B45	MM00376	1/2	0.2
L34G45	MM00377	L34B45	MM00378	3/4	0.3
L1G45	MM00379	L1B45	MM00380	1	0.5

L114G45	MM00381	L114B45	MM00382	1-1/4	0.8
L112G45	MM00383	L112B45	MM00384	1-1/2	1.0
L2G45	MM00385	L2B45	MM00386	2	1.6
L212G45	MM00387	L212B45	MM00387	2-1/2	3.0
L3G45	MM00388	L3B45	MM00389	3	4.7
		L4B45	MM00390	4	7.4



Street Elbows - 90°

SE18G	MM00391	SE18B	MM00392	1/8	0.06
SE14G	MM00393	SE14B	MM00394	1/4	0.09
SE38G	MM00395	SE38B	MM00396	3/8	0.2
SE12G	MM00397	SE12B	MM00398	1/2	0.2
SE34G	MM00399	SE34B	MM00400	3/4	0.4
SE1G	MM00401	SE1B	MM00402	1	0.6

SE114G	MM00403	SE114B	MM00404	1-1/4	0.9
SE112G	MM00405	SE112B	MM00406	1-1/2	1.1
SE2G	MM00407	SE2B	MM00408	2	1.9
SE212G	MM00409	SE212B	MM00410	2-1/2	4.1
SE3G	MM00411	SE3B	MM00412	3	6.1
		SE4B	MM00413	4	9.9



Street Elbows - 45°

SE18G45	MM00414	SE18B45	MM00415	1/8	0.06
SE14G45	MM00416	SE14B45	MM00417	1/4	0.08
SE38G45	MM00418	SE38B45	MM00419	3/8	0.1
SE12G45	MM00420	SE12B45	MM00421	1/2	0.2
SE34G45	MM00422	SE34B45	MM00423	3/4	0.3
SE1G45	MM00424	SE1B45	MM00425	1	0.4

SE114G45	MM00426	SE114B45	MM00427	1-1/4	0.7
SE112G45	MM00428	SE112B45	MM00429	1-1/2	0.9
SE2G45	MM00430	SE2B45	MM00431	2	2.0



Tees

T18G	MM00432	T18B	MM00433	1/8	0.1
T14G	MM00434	T14B	MM00435	1/4	0.2
T38G	MM00436	T38B	MM00437	3/8	0.2
T12G	MM00438	T12B	MM00439	1/2	0.3
T34G	MM00440	T34B	MM00441	3/4	0.5
T1G	MM00442	T1B	MM00443	1	0.8

T114G	MM00444	T114B	MM00445	1-1/4	1.2
T112G	MM00446	T112B	MM00447	1-1/2	1.6
T2G	MM00448	T2B	MM00449	2	2.4
T212G	MM00450	T212B	MM00451	2-1/2	4.9
T3G	MM00452	T3B	MM00453	3	7.1
T4G	MM00454	T4B	MM00455	4	11.3



Reducing Bushings

RB1418G	MM00456	RB1418B	MM00457	1/4 x 1/8	0.04
RB3818G	MM00458	RB3818B	MM00459	3/8 x 1/8	0.05
RB3814G	MM00460	RB3814B	MM00461	3/8 x 1/4	0.04
RB1218G	MM00462	RB1218B	MM00463	1/2 x 1/8	0.09
RB1214G	MM00464	RB1214B	MM00465	1/2 x 1/4	0.09
RB1238G	MM00466	RB1238B	MM00467	1/2 x 3/8	0.1
RB3418G	MM00468	RB3418B	MM00469	3/4 x 1/8	0.2
RB3414G	MM00470	RB3414B	MM00471	3/4 x 1/4	0.2
RB3438G	MM00472	RB3438B	MM00473	3/4 x 3/8	0.1
RB3412G	MM00474	RB3412B	MM00475	3/4 x 1/2	0.1
RB114G	MM00476			1 x 1/4	0.2
RB138G	MM00477	RB138B	MM00478	1 x 3/8	0.2
RB112G	MM00479	RB112B	MM00480	1 x 1/2	0.2
RB134G	MM00481	RB134B	MM00482	1 x 3/4	0.2
RB11412G	MM00483	RB11412B	MM00484	1-1/4 x 1/2	0.8
RB11434G	MM00485	RB11434B	MM00486	1-1/4 x 3/4	0.4

RB1141G	MM00487	RB1141B	MM00488	1-1/4 x 1	0.3
RB11212G	MM00489	RB11212B	MM00490	1-1/2 x 1/2	0.4
RB11234G	MM00491	RB11234B	MM00492	1-1/2 x 3/4	0.5
RB1121G	MM00493	RB1121B	MM00494	1-1/2 x 1	0.5
RB112114G	MM00495	RB112114B	MM00496	1-1/2 x 1-1/4	0.3
RB212G	MM00497	RB212B	MM00498	2 x 1/2	0.6
RB234G	MM00499	RB234B	MM00500	2 x 3/4	0.6
RB21G	MM00501	RB21B	MM00502	2 x 1	0.7
RB2114G	MM00503	RB2114B	MM00504	2 x 1-1/4	0.8
RB2112G	MM00505	RB2112B	MM00506	2 x 1-1/2	0.7
RB212112G	MM00507	RB212112B	MM00508	2-1/2 x 1-1/2	1.4
RB2122G	MM00509	RB2122B	MM00510	2-1/2 x 2	1.0
		RB3112B	MM00511	3 x 1 x 1/2	1.4
RB32G	MM00512	RB32B	MM00513	3 x 2	2.1
RB3212G	MM00514	RB3212B	MM00515	3 x 2-1/2	1.8
		RB3123B	MM00516	3-1/2 x 3	2.0



Reducing Bushings (Continued)

Galv. Order No.	Price Ref. #	Black Order No.	Price Ref. #	Size (in)	Wt (lbs)
		RB4112B	MM00517	4 x 1-1/2	2.4
		RB42B	MM00518	4 x 2	2.6

Couplers - Regular

C18G	MM00521	C18B	MM00522	1/8	0.06
C14G	MM00523	C14B	MM00524	1/4	0.09
C38G	MM00525	C38B	MM00526	3/8	0.1
C12G	MM00527	C12B	MM00528	1/2	0.2
C34G	MM00529	C34B	MM00530	3/4	0.3
C1G	MM00531	C1B	MM00532	1	0.4

Couplers - Merchant

C18GS	MM00545	C18BS	MM00546	1/8	0.03
C14GS	MM00547	C14BS	MM00548	1/4	0.07
C38GS	MM00549	C38BS	MM00550	3/8	0.1
C12GS	MM00551	C12BS	MM00552	1/2	0.2
C34GS	MM00553	C34BS	MM00554	3/4	0.3
C1GS	MM00555	C1BS	MM00556	1	0.3

Unions

U18G	MM00566	U18B	MM00567	1/8	0.2
U14G	MM00568	U14B	MM00569	1/4	0.2
U38G	MM00570	U38B	MM00571	3/8	0.3
U12G	MM00572	U12B	MM00573	1/2	0.4
U34G	MM00574	U34B	MM00575	3/4	0.6
U1G	MM00576	U1B	MM00577	1	0.7

Crosses

CR18G	MM00589			1/8	0.1
CR14G	MM00590	CR14B	MM00591	1/4	0.2
CR38G	MM00592			3/8	0.3
CR12G	MM00593			1/2	0.4
CR34G	MM00594			3/4	0.6
CR1G	MM00595			1	0.9

Caps

CA18G	MM00601	CA18B	MM00602	1/8	0.03
CA14G	MM00603	CA14B	MM00604	1/4	0.06
CA38G	MM00605	CA38B	MM00606	3/8	0.08
CA12G	MM00607	CA12B	MM00608	1/2	0.1
CA34G	MM00609	CA34B	MM00610	3/4	0.2
CA1G	MM00611	CA1B	MM00612	1	0.3

Plugs

P18G	MM00625	P18B	MM00626	1/8	0.02
P14G	MM00627	P14B	MM00628	1/4	0.03
P38G	MM00629	P38B	MM00630	3/8	0.05
P12G	MM00631	P12B	MM00632	1/2	0.08
P34G	MM00633	P34B	MM00634	3/4	0.2
P1G	MM00635	P1B	MM00636	1	0.2

Galv. Order No.	Price Ref. #	Black Order No.	Price Ref. #	Size (in)	Wt (lbs)
		RB4212B	MM00519	4 x 2-1/2	2.8
		RB43B	MM00520	4 x 3	2.9

C114G	MM00533	C114B	MM00534	1-1/4	0.7
C112G	MM00535	C112B	MM00536	1-1/2	0.9
C2G	MM00537	C2B	MM00538	2	1.4
C212G	MM00539	C212B	MM00540	2-1/2	2.6
C3G	MM00541	C3B	MM00542	3	3.4
C4G	MM00543	C4B	MM00544	4	7.0

C114GS	MM00557	C114BS	MM00558	1-1/4	0.5
C112GS	MM00559	C112BS	MM00560	1-1/2	0.6
C2GS	MM00561	C2BS	MM00562	2	0.8
		C212BS	MM00563	2-1/2	2.1
		C3BS	MM00564	3	3.4
		C4BS	MM00565	4	4.5

U114G	MM00578	U114B	MM00579	1-1/4	1.6
U112G	MM00580	U112B	MM00581	1-1/2	1.7
U2G	MM00582	U2B	MM00583	2	2.2
U212G	MM00584	U212B	MM00585	2-1/2	4.1
U3G	MM00586	U3B	MM00587	3	5.5
		U4B	MM00588	4	8.1

CR114G	MM00596	CR114B	MM00597	1-1/4	1.4
CR112G	MM00598	CR112B	MM00599	1-1/2	1.9
CR2G	MM00600			2	2.8

CA114G	MM00613	CA114B	MM00614	1-1/4	0.4
CA112G	MM00615	CA112B	MM00616	1-1/2	0.6
CA2G	MM00617	CA2B	MM00618	2	0.9
CA212G	MM00619	CA212B	MM00620	2-1/2	1.8
CA3G	MM00621	CA3B	MM00622	3	2.6
CA4G	MM00623	CA4B	MM00624	4	4.7

P114G	MM00637	P114B	MM00638	1-1/4	0.3
P112G	MM00639	P112B	MM00640	1-1/2	0.4
P2G	MM00641	P2B	MM00642	2	0.7
		P212B	MM00643	2-1/2	1.1
P3G	MM00644	P3B	MM00645	3	1.6
P4G	MM00646	P4B	MM00647	4	3.1



Iron Pipe Fittings

Floor Flanges

Galv. Order No.	Price Ref. #	Black Order No.	Price Ref. #	Size (in)	Wt (lbs)
FF14G	MM00648			1/4	0.2
FF38G	MM00649			3/8	0.3
FF12G	MM00650			1/2	0.4
FF34G	MM00651			3/4	0.5

Galv. Order No.	Price Ref. #	Black Order No.	Price Ref. #	Size (in)	Wt (lbs)
FF1G	MM00652			1	0.6
FF114G	MM00653			1-1/4	0.9
FF112G	MM00654			1-1/2	1.1
FF2G	MM00655			2	1.6



Reducing Couplings

Galv. Order No.	Price Ref. #	Black Order No.	Price Ref. #	Size (in)	Wt (lbs)
RC1418G	MM00656	RC1418B	MM00657	1/4 x 1/8	0.07
RC3818G	MM00658			3/8 x 1/8	0.09
RC3814G	MM00659	RC3814B	MM00660	3/8 x 1/4	0.1
RC1218G	MM00661			1/2 x 1/8	0.1
RC1214G	MM00662	RC1214B	MM00663	1/2 x 1/4	0.1
RC1238G	MM00664	RC1238B	MM00665	1/2 x 3/8	0.2
RC3414G	MM00666			3/4 x 1/4	0.2
RC3438G	MM00667	RC3438B	MM00668	3/4 x 3/8	0.2
RC3412G	MM00669	RC3412B	MM00670	3/4 x 1/2	0.2
RC112G	MM00671	RC112B	MM00672	1 x 1/2	0.4
RC134G	MM00673	RC134B	MM00674	1 x 3/4	0.4
RC11412G	MM00675			1-1/4 x 1/2	0.5

Galv. Order No.	Price Ref. #	Black Order No.	Price Ref. #	Size (in)	Wt (lbs)
RC11434G	MM00676	RC11434B	MM00677	1-1/4 x 3/4	0.5
RC1141G	MM00678	RC1141B	MM00679	1-1/4 x 1	0.6
RC11234G	MM00680	RC11234B	MM00681	1-1/2 x 3/4	0.7
RC1121G	MM00682	RC1121B	MM00683	1-1/2 x 1	0.7
RC112114G	MM00684	RC112114B	MM00685	1-1/2 x 1-1/4	0.8
RC21G	MM00686	RC21B	MM00687	2 x 1	1.0
RC2114G	MM00688	RC2114B	MM00689	2 x 1-1/4	1.2
RC2112G	MM00690	RC2112B	MM00691	2 x 1-1/2	1.3
RC212114G	MM00692			2-1/2 x 1-1/4	1.4
RC212112G	MM00693	RC212112B	MM00694	2-1/2 x 1-1/2	2.2
		RC3212B	MM00695	3 x 2-1/2	3.4



Reducing Elbows

Galv. Order No.	Price Ref. #	Black Order No.	Price Ref. #	Size (in)	Wt (lbs)
RL3814G	MM00696	RL3814B	MM00697	3/8 x 1/4	0.1
RL1214G	MM00698			1/2 x 1/4	0.2
RL1238G	MM00699	RL1238B	MM00700	1/2 x 3/8	0.2
RL3412G	MM00701	RL3412B	MM00702	3/4 x 1/2	0.3
RL112G	MM00703	RL112B	MM00704	1 x 1/2	0.4
RL134G	MM00705	RL134B	MM00706	1 x 3/4	0.5

Galv. Order No.	Price Ref. #	Black Order No.	Price Ref. #	Size (in)	Wt (lbs)
RL1141G	MM00707	RL1141B	MM00708	1-1/4 x 1	0.7
RL1121G	MM00709	RL1121B	MM00710	1-1/2 x 1	0.9
RL112114G	MM00711	RL112114B	MM00712	1-1/2 x 1-1/4	1.0
RL21G	MM00713	RL21B	MM00714	2 x 1	1.4
RL2114G	MM00715	RL2114B	MM00716	2 x 1-1/4	1.5
RL2112G	MM00717	RL2112B	MM00718	2 x 1-1/2	1.5



Reducing Tees

Galv. Order No.	Price Ref. #	Black Order No.	Price Ref. #	Size (in)	Wt (lbs)
RT1238G	MM00719			1/2 x 3/8	0.3
RT3412G	MM00720	RT3412B	MM00721	3/4 x 1/2	0.4
RT112G	MM00722	RT112B	MM00723	1 x 1/2	0.6
RT134G	MM00724	RT134B	MM00725	1 x 3/4	0.7
RT11412G	MM00726	RT11412B	MM00727	1-1/4 x 1/2	0.8
RT11434G	MM00728	RT11434B	MM00729	1-1/4 x 3/4	0.9
RT1141G	MM00730	RT1141B	MM00731	1-1/4 x 1	1.0
RT11234G	MM00732	RT11234B	MM00733	1-1/2 x 3/4	1.2

Galv. Order No.	Price Ref. #	Black Order No.	Price Ref. #	Size (in)	Wt (lbs)
RT1121G	MM00734	RT1121B	MM00735	1-1/2 x 1	1.5
RT112114G	MM00736	RT112114B	MM00737	1-1/2 x 1-1/4	1.0
RT21G	MM00738			2 x 1	2.0
RT2114G	MM00739			2 x 1-1/4	2.2
RT2112G	MM00740			2 x 1-1/2	2.1

Brass Pipe Fittings



- Produced from durable brass
- Resists corrosive rust
- Excellent for potable water applications

1/8" Nipples

Order Number	Price Ref. #	Size (in)	Wt (lbs)
N18*CLBR	MM00741	1/8 x Close	0.01
N18*112BR	MM00742	1/8 x 1-1/2	0.05
N18*2BR	MM00743	1/8 x 2	0.05
N18*3BR	MM00744	1/8 x 3	0.05



Order Number	Price Ref. #	Size (in)	Wt (lbs)
N18*4BR	MM00745	1/8 x 4	0.1
N18*5BR	MM00746	1/8 x 5	0.1
N18*6BR	MM00747	1/8 x 6	0.1

1/4" Nipples

N14*CLBR	MM00748	1/4 x Close	0.05
N14*112BR	MM00749	1/4 x 1-1/2	0.15
N14*2BR	MM00750	1/4 x 2	0.05
N14*3BR	MM00751	1/4 x 3	0.1

N14*4BR	MM00752	1/4 x 4	0.2
N14*412BR	MM00753	1/4 x 4-1/2	0.2
N14*5BR	MM00754	1/4 x 5	0.2
N14*512BR	MM00755	1/4 x 5-1/2	0.2
N14*6BR	MM00756	1/4 x 6	0.2

3/8" Nipples

N38*CLBR	MM00757	3/8 x Close	0.05
N38*112BR	MM00758	3/8 x 1-1/2	0.05
N38*2BR	MM00759	3/8 x 2	0.09
N38*3BR	MM00760	3/8 x 3	0.1

N38*4BR	MM00761	3/8 x 4	0.2
N38*412BR	MM00762	3/8 x 4-1/2	0.2
N38*5BR	MM00763	3/8 x 5	0.3
N38*512BR	MM00764	3/8 x 5-1/2	0.3
N38*6BR	MM00765	3/8 x 6	0.3

1/2" Nipples

N12*CLBR	MM00766	1/2 x Close	0.45
N12*112BR	MM00767	1/2 x 1-1/2	0.10
N12*2BR	MM00768	1/2 x 2	0.13
N12*212BR	MM00769	1/2 x 2-1/2	0.2
N12*3BR	MM00770	1/2 x 3	0.2

N12*312BR	MM00771	1/2 x 3-1/2	0.3
N12*4BR	MM00772	1/2 x 4	0.3
N12*5BR	MM00773	1/2 x 5	0.4
N12*512BR	MM00774	1/2 x 5-1/2	0.4
N12*6BR	MM00775	1/2 x 6	0.5

3/4" Nipples

N34*CLBR	MM00776	3/4 x Close	0.10
N34*112BR	MM00777	3/4 x 1-1/2	0.15
N34*2BR	MM00778	3/4 x 2	0.20
N34*212BR	MM00779	3/4 x 2-1/2	0.25

N34*3BR	MM00780	3/4 x 3	0.30
N34*4BR	MM00781	3/4 x 4	0.40
N34*6BR	MM00782	3/4 x 6	0.60

1" Nipples

N1*CLBR	MM00783	1 x Close	0.15
N1*2BR	MM00784	1 x 2	0.25
N1*3BR	MM00785	1 x 3	0.35

N1*4BR	MM00786	1 x 4	0.53
N1*5BR	MM00787	1 x 5	0.65
N1*6BR	MM00788	1 x 6	0.80

1-1/4" Nipples

N114*CLBR	MM00789	1-1/4 x Close	0.3
N114*212BR	MM00790	1-1/4 x 2-1/2	0.5
N114*4BR	MM00791	1-1/4 x 4	0.8

N114*5BR	MM00792	1-1/4 x 5	1.0
N114*512BR	MM00793	1-1/4 x 5-1/2	1.1
N114*6BR	MM00794	1-1/4 x 6	1.2

1-1/2" Nipples

N112*CLBR	MM00795	1-1/2 x Close	0.4
N112*212BR	MM00796	1-1/2 x 2-1/2	0.6
N112*3BR	MM00797	1-1/2 x 3	0.7
N112*4BR	MM00798	1-1/2 x 4	0.9

N112*412BR	MM00799	1-1/2 x 4-1/2	1.1
N112*5BR	MM00800	1-1/2 x 5	1.3
N112*512BR	MM00801	1-1/2 x 5-1/2	1.4
N112*6BR	MM00802	1-1/2 x 6	1.5

2" Nipples

N2*CLBR	MM00803	2 x Close	0.5
---------	---------	-----------	-----



Brass Pipe Fittings

Elbows - 90°

Order Number	Price Ref. #	Size (in)	Wt (lbs)
L18BR	MM00804	1/8	0.05
L14BR	MM00805	1/4	0.1
L38BR	MM00806	3/8	0.2
L12BR	MM00807	1/2	0.2
L34BR	MM00808	3/4	0.4

Order Number	Price Ref. #	Size (in)	Wt (lbs)
L1BR	MM00809	1	0.6
L114BR	MM00810	1-1/4	0.9
L112BR	MM00811	1-1/2	1.2
L2BR	MM00812	2	2.0

Elbows - 45°

L18BR45	MM00813	1/8	0.05
L38BR45	MM00814	3/8	0.2
L12BR45	MM00815	1/2	0.2

L34BR45	MM00816	3/4	0.3
L1BR45	MM00817	1	0.5
L114BR45	MM00818	1-1/4	0.7



Street Elbows - 90°

SE18BR	MM00819	1/8	0.05
SE14BR	MM00820	1/4	0.1
SE38BR	MM00821	3/8	0.2
SE12BR	MM00822	1/2	0.2

SE34BR	MM00823	3/4	0.3
SE1BR	MM00824	1	0.5
SE114BR	MM00825	1-1/4	0.7
SE112BR	MM00826	1-1/2	0.8



Street Elbows - 45°

SE18BR45	MM00827	1/8	0.05
SE14BR45	MM00828	1/4	0.1
SE38BR45	MM00829	3/8	0.2
SE12BR45	MM00830	1/2	0.2

SE34BR45	MM00831	3/4	0.3
SE1BR45	MM00832	1	0.5
SE114BR45	MM00833	1-1/4	0.7
SE112BR45	MM00834	1-1/2	0.8



Tees

T18BR	MM00835	1/8	0.1
T14BR	MM00836	1/4	0.2
T38BR	MM00837	3/8	0.2
T12BR	MM00838	1/2	0.3
T34BR	MM00839	3/4	0.5

T1BR	MM00840	1	0.8
T114BR	MM00841	1-1/4	1.3
T112BR	MM00842	1-1/2	1.4
T2BR	MM00843	2	2.0



Reducing Bushings

RB1418BR	MM00844	1/4 x 1/8	0.05
RB3818BR	MM00845	3/8 x 1/8	0.03
RB3814BR	MM00846	3/8 x 1/4	0.05
RB1218BR	MM00847	1/2 x 1/8	0.05
RB1214BR	MM00848	1/2 x 1/4	0.05
RB1238BR	MM00849	1/2 x 3/8	0.05

RB3414BR	MM00850	3/4 x 1/4	0.2
RB3438BR	MM00851	3/4 x 3/8	0.2
RB3412BR	MM00852	3/4 x 1/2	0.2
RB112BR	MM00853	1 x 1/2	0.3
RB1141BR	MM00854	1-1/4 x 1	0.3
RB1121BR	MM00855	1-1/2 x 1	0.6



Couplers

C18BR	MM00856	1/8	0.05
C14BR	MM00857	1/4	0.05
C38BR	MM00858	3/8	0.1
C12BR	MM00859	1/2	0.2
C34BR	MM00860	3/4	0.3

C1BR	MM00861	1	0.4
C114BR	MM00862	1-1/4	0.6
C112BR	MM00863	1-1/2	0.8
C2BR	MM00864	2	1.2



Unions

U18BR	MM00865	1/8	0.1
U14BR	MM00866	1/4	0.2
U38BR	MM00867	3/8	0.3
U12BR	MM00868	1/2	0.5

U34BR	MM00869	3/4	0.6
U1BR	MM00870	1	0.9
U114BR	MM00871	1-1/4	1.2
U112BR	MM00872	1-1/2	1.6





Crosses

Order Number	Price Ref. #	Size (in)	Wt (lbs)
CR18BR	MM00873	1/8	0.1
CR14BR	MM00874	1/4	0.2
CR38BR	MM00875	3/8	0.2

Order Number	Price Ref. #	Size (in)	Wt (lbs)
CR12BR	MM00876	1/2	0.4
CR34BR	MM00877	3/4	0.6
CR1BR	MM00878	1	1.1

Caps

Order Number	Price Ref. #	Size (in)	Wt (lbs)
CA18BR	MM00879	1/8	0.05
CA14BR	MM00880	1/4	0.05
CA38BR	MM00881	3/8	0.05
CA12BR	MM00882	1/2	0.1

Order Number	Price Ref. #	Size (in)	Wt (lbs)
CA34BR	MM00883	3/4	0.2
CA1BR	MM00884	1	0.3
CA112BR	MM00885	1-1/2	0.4



Plugs

Order Number	Price Ref. #	Size (in)	Wt (lbs)
P18BR	MM00886	1/8	0.01
P14BR	MM00887	1/4	0.05
P38BR	MM00888	3/8	0.1

Order Number	Price Ref. #	Size (in)	Wt (lbs)
P12BR	MM00889	1/2	0.1
P34BR	MM00890	3/4	0.2
P1BR	MM00891	1	0.4



Stainless Steel Pipe Fittings



- Produced with 304 stainless steel
- Strong, chemical resistant, & will not rust
- Suitable for a wide range of applications

PIPE FITTINGS

1/8" Nipples

Order Number	Price Ref. #	Size (in)	Wt (lbs)
N18*CLS	MM00892	1/8 x Close	0.01
N18*112S	MM00893	1/8 x 1-1/2	0.04
N18*2S	MM00894	1/8 x 2	0.04
N18*212S	MM00895	1/8 x 2-1/2	0.05
N18*3S	MM00896	1/8 x 3	0.06
N18*312S	MM00897	1/8 x 3-1/2	0.07

Order Number	Price Ref. #	Size (in)	Wt (lbs)
N18*4S	MM00898	1/8 x 4	0.08
N18*412S	MM00899	1/8 x 4-1/2	0.1
N18*5S	MM00900	1/8 x 5	0.1
N18*512S	MM00901	1/8 x 5-1/2	0.1
N18*6S	MM00902	1/8 x 6	0.1



1/4" Nipples

Order Number	Price Ref. #	Size (in)	Wt (lbs)
N14*CLS	MM00903	1/4 x Close	0.02
N14*112S	MM00904	1/4 x 1-1/2	0.04
N14*2S	MM00905	1/4 x 2	0.06
N14*212S	MM00906	1/4 x 2-1/2	0.08
N14*3S	MM00907	1/4 x 3	0.1
N14*312S	MM00908	1/4 x 3-1/2	0.1

Order Number	Price Ref. #	Size (in)	Wt (lbs)
N14*4S	MM00909	1/4 x 4	0.1
N14*412S	MM00910	1/4 x 4-1/2	0.2
N14*5S	MM00911	1/4 x 5	0.2
N14*512S	MM00912	1/4 x 5-1/2	0.2
N14*6S	MM00913	1/4 x 6	0.2

3/8" Nipples

Order Number	Price Ref. #	Size (in)	Wt (lbs)
N38*CLS	MM00914	3/8 x Close	0.03
N38*112S	MM00915	3/8 x 1-1/2	0.06
N38*2S	MM00916	3/8 x 2	0.08
N38*212S	MM00917	3/8 x 2-1/2	0.1
N38*3S	MM00918	3/8 x 3	0.1
N38*312S	MM00919	3/8 x 3-1/2	0.2

Order Number	Price Ref. #	Size (in)	Wt (lbs)
N38*4S	MM00920	3/8 x 4	0.2
N38*412S	MM00921	3/8 x 4-1/2	0.2
N38*5S	MM00922	3/8 x 5	0.2
N38*512S	MM00923	3/8 x 5-1/2	0.2
N38*6S	MM00924	3/8 x 6	0.3

1/2" Nipples

Order Number	Price Ref. #	Size (in)	Wt (lbs)
N12*CLS	MM00925	1/2 x Close	0.04
N12*112S	MM00926	1/2 x 1-1/2	0.08

Order Number	Price Ref. #	Size (in)	Wt (lbs)
N12*2S	MM00927	1/2 x 2	0.1
N12*212S	MM00928	1/2 x 2-1/2	0.2

Stainless Steel Pipe Fittings



1/2" Nipples (Continued)

Order Number	Price Ref. #	Size (in)	Wt (lbs)
N12*3S	MM00929	1/2 x 3	0.2
N12*312S	MM00930	1/2 x 3-1/2	0.2
N12*4S	MM00931	1/2 x 4	0.3
N12*412S	MM00932	1/2 x 4-1/2	0.3

Order Number	Price Ref. #	Size (in)	Wt (lbs)
N12*5S	MM00933	1/2 x 5	0.3
N12*512S	MM00934	1/2 x 5-1/2	0.4
N12*6S	MM00935	1/2 x 6	0.4
N12*8S	MM00936	1/2 x 8	0.6
N12*12S	MM00937	1/2 x 12	0.8

3/4" Nipples

N34*CLS	MM00938	3/4 x Close	0.09
N34*112S	MM00939	3/4 x 1-1/2	0.1
N34*2S	MM00940	3/4 x 2	0.2
N34*212S	MM00941	3/4 x 2-1/2	0.2
N34*3S	MM00942	3/4 x 3	0.2
N34*312S	MM00943	3/4 x 3-1/2	0.3

N34*4S	MM00944	3/4 x 4	0.3
N34*412S	MM00945	3/4 x 4-1/2	0.4
N34*5S	MM00946	3/4 x 5	0.4
N34*5-1/2S	MM00947	3/4 x 5-1/2	0.5
N34*6S	MM00948	3/4 x 6	0.5
N34*12S	MM00949	3/4 x 12	0.9

1" Nipples

N1*CLS	MM00950	1 x Close	0.1
N1*2S	MM00951	1 x 2	0.2
N1*212S	MM00952	1 x 2-1/2	0.3
N1*3S	MM00953	1 x 3	0.3
N1*312S	MM00954	1 x 3-1/2	0.4
N1*4S	MM00955	1 x 4	0.5
N1*412S	MM00956	1 x 4-1/2	0.5

N1*5S	MM00957	1 x 5	0.6
N1*512S	MM00958	1 x 5-1/2	0.7
N1*6S	MM00959	1 x 6	0.7
N1*7S	MM00960	1 x 7	0.8
N1*9S	MM00961	1 x 9	1.1
N1*12S	MM00962	1 x 12	1.4
N1*18S	MM00963	1 x 18	2.2

1-1/4" Nipples

N114*CLS	MM00964	1-1/4 x Close	0.2
N114*2S	MM00965	1-1/4 x 2	0.3
N114*212S	MM00966	1-1/4 x 2-1/2	0.4
N114*3S	MM00967	1-1/4 x 3	0.4
N114*312S	MM00968	1-1/4 x 3-1/2	0.5
N114*4S	MM00969	1-1/4 x 4	0.6

N114*412S	MM00970	1-1/4 x 4-1/2	0.8
N114*5S	MM00971	1-1/4 x 5	0.8
N114*512S	MM00972	1-1/4 x 5-1/2	0.9
N114*6S	MM00973	1-1/4 x 6	0.9
N114*8S	MM00974	1-1/4 x 8	1.2
N114*12S	MM00975	1-1/4 x 12	1.8

1-1/2" Nipples

N112*CLS	MM00976	1-1/2 x Close	0.2
N112*2S	MM00977	1-1/2 x 2	0.3
N112*212S	MM00978	1-1/2 x 2-1/2	0.4
N112*3S	MM00979	1-1/2 x 3	0.6
N112*312S	MM00980	1-1/2 x 3-1/2	0.7
N112*4S	MM00981	1-1/2 x 4	0.7

N112*412S	MM00982	1-1/2 x 4-1/2	0.8
N112*5S	MM00983	1-1/2 x 5	1.1
N112*512S	MM00984	1-1/2 x 5-1/2	1.0
N112*6S	MM00985	1-1/2 x 6	1.2
N112*9S	MM00986	1-1/2 x 9	1.6
N112*10S	MM00987	1-1/2 x 10	2.2

2" Nipples

N2*CLS	MM00988	2 x Close	0.4
N2*212S	MM00989	2 x 2-1/2	0.5
N2*3S	MM00990	2 x 3	0.7
N2*312S	MM00991	2 x 3-1/2	0.8
N2*4S	MM00992	2 x 4	1.0

N2*412S	MM00993	2 x 4-1/2	1.1
N2*5S	MM00994	2 x 5	1.3
N2*512S	MM00995	2 x 5-1/2	1.4
N2*6S	MM00996	2 x 6	1.5

Elbows - 90°

L18S	MM00997	1/8	0.1
L14S	MM00998	1/4	0.1
L38S	MM00999	3/8	0.2
L12S	MM01000	1/2	0.2
L34S	MM01001	3/4	0.3

L1S	MM01002	1	0.4
L114S	MM01003	1-1/4	0.6
L112S	MM01004	1-1/2	0.8
L2S	MM01005	2	1.2
L3S	MM01006	3	3.4



Elbows - 45°

L18S45	MM01007	1/8	0.1
L14S45	MM01008	1/4	0.1
L38S45	MM01009	3/8	0.1
L12S45	MM01010	1/2	0.2

L34S45	MM01011	3/4	0.2
L1S45	MM01012	1	0.3
L114S45	MM01013	1-1/4	0.5
L112S45	MM01014	1-1/2	0.7
L2S45	MM01015	2	1.1





Street Elbows - 90°

Order Number	Price Ref. #	Size (in)	Wt (lbs)
SE18S	MM01016	1/8	0.06
SE14S	MM01017	1/4	0.09
SE38S	MM01018	3/8	0.1
SE12S	MM01019	1/2	0.2
SE34S	MM01020	3/4	0.3

Order Number	Price Ref. #	Size (in)	Wt (lbs)
SE1S	MM01021	1	0.5
SE114S	MM01022	1-1/4	0.9
SE112S	MM01023	1-1/2	1.1
SE2S	MM01024	2	1.9

Tees

T18S	MM01025	1/8	0.1
T14S	MM01026	1/4	0.2
T38S	MM01027	3/8	0.2
T12S	MM01028	1/2	0.3
T34S	MM01029	3/4	0.5

T1S	MM01030	1	0.8
T114S	MM01031	1-1/4	1.2
T112S	MM01032	1-1/2	1.6
T2S	MM01033	2	2.4



Reducing Bushings

RB1418S	MM01034	1/4 x 1/8	0.04
RB3818S	MM01035	3/8 x 1/8	0.05
RB3814S	MM01036	3/8 x 1/4	0.04
RB1218S	MM01037	1/2 x 1/8	0.09
RB1214S	MM01038	1/2 x 1/4	0.09
RB1238S	MM01039	1/2 x 3/8	0.06
RB3414S	MM01040	3/4 x 1/4	0.1
RB3438S	MM01041	3/4 x 3/8	0.1
RB3412S	MM01042	3/4 x 1/2	0.1
RB138S	MM01043	1 x 3/8	0.2
RB112S	MM01044	1 x 1/2	0.2

RB134S	MM01045	1 x 3/4	0.1
RB11412S	MM01046	1-1/4 x 1/2	0.8
RB11434S	MM01047	1-1/4 x 3/4	0.4
RB1141S	MM01048	1-1/4 x 1	0.3
RB11212S	MM01049	1-1/2 x 1/2	0.4
RB11234S	MM01050	1-1/2 x 3/4	0.5
RB1121S	MM01051	1-1/2 x 1	0.5
RB112114S	MM01052	1-1/2 x 1-1/4	0.3
RB2114S	MM01053	2 x 1-1/4	0.8
RB2112S	MM01054	2 x 1-1/2	0.7
RB3212S	MM01055	3 x 2-1/2	1.8



Couplers

C18S	MM01056	1/8	0.06
C14S	MM01057	1/4	0.09
C38S	MM01058	3/8	0.1
C12S	MM01059	1/2	0.2
C34S	MM01060	3/4	0.3

C1S	MM01061	1	0.4
C114S	MM01062	1-1/4	0.7
C112S	MM01063	1-1/2	0.9
C2S	MM01064	2	1.8



Unions

U18S	MM01065	1/8	0.2
U14S	MM01066	1/4	0.2
U38S	MM01067	3/8	0.3
U12S	MM01068	1/2	0.4
U34S	MM01069	3/4	0.6

U1S	MM01070	1	0.7
U114S	MM01071	1-1/4	1.6
U112S	MM01072	1-1/2	1.7
U2S	MM01073	2	2.2



Caps

CA18S	MM01074	1/8	0.03
CA14S	MM01075	1/4	0.06
CA38S	MM01076	3/8	0.08
CA12S	MM01077	1/2	0.1
CA34S	MM01078	3/4	0.2

CA1S	MM01079	1	0.3
CA114S	MM01080	1-1/4	0.4
CA112S	MM01081	1-1/2	0.6
CA2S	MM01082	2	0.9



Plugs

P18S	MM01083	1/8	0.02
P14S	MM01084	1/4	0.03
P38S	MM01085	3/8	0.05
P12S	MM01086	1/2	0.08
P34S	MM01087	3/4	0.2

P1S	MM01088	1	0.2
P114S	MM01089	1-1/4	0.3
P112S	MM01090	1-1/2	0.4
P2S	MM01091	2	0.7



Flare Fittings

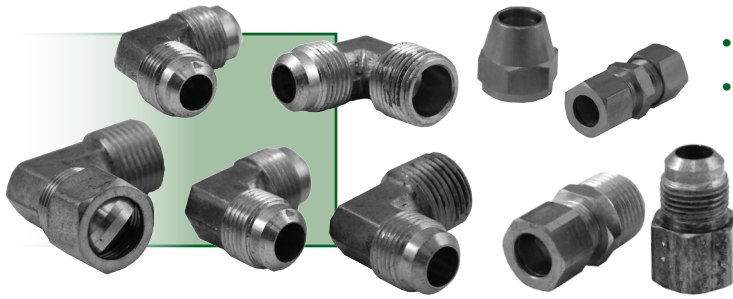

- Brass construction
- Good for air, water, and gas connections

Rod Nut

Order Number	Price Ref. #	Size (in)	Wt (lbs)
8920019	MM01092	1/4	.03
4312013	MM01093	3/16	.02
8920027	MM01094	5/16	.04
8920035	MM01095	3/8	.05

Order Number	Price Ref. #	Size (in)	Wt (lbs)
8920043	MM01096	1/2	.09
8920050	MM01097	5/8	.15
8920068	MM01098	3/4	.24

Forged Nut

8920084	MM01099	3/8	.06
8920092	MM01100	1/2	.08
8920100	MM01101	5/8	.12
8920118	MM01102	3/8 x 1/4	.06

8920126	MM01103	1/2 x 3/8	.08
8920134	MM01104	5/8 x 1/2	.12

Swivel Union

8926545	MM01105	1/4	.04
8926552	MM01106	3/8	.10
8926628	MM01107	1/2	.16

8926644	MM01108	5/8	.24
U12FL	MM01109	3/4	.34

Male Union

8920183	MM01110	1/4	.03
451029	MM01111	5/16	.05
8920209	MM01112	3/8	.09
8920217	MM01113	1/2	.14

8920225	MM01114	5/8	.20
C34FL	MM01115	3/4 OD	.35
8920233	MM01116	3/8 x 1/4	.06
8920241	MM01117	1/2 x 3/8	.10
8920258	MM01118	5/8 x 1/4	.14

Flare Tee

4312310	MM01119	3/16	.06
450995	MM01120	1/4	.08
451002	MM01121	5/16	.10
8920753	MM01122	3/8 OD	.12
8920761	MM01123	1/2 OD	.19
8920779	MM01124	5/8 OD	.30

T34FL	MM01125	3/4 OD	.53
8920795	MM01126	1/2 OD x 3/8 OD	.19
RT08-06-08FL	MM01127	1/2 x 3/8 x 1/2	.18
8920803	MM01128	5/8 OD x 1/2 OD	.28
RT10-08-10FL	MM01129	5/8 x 1/2 x 5/8	.27
RT12-10FL	MM01130	3/4 OD x 5/8 OD	.36

Branch Tee

8920829	MM01131	3/8 OD x 3/8 MIP	.13
8920837	MM01132	1/2 OD x 3/8 MIP	.19
8920845	MM01133	1/2 OD x 1/2 MIP	.24

BT08-12FL	MM01134	1/2 OD x 3/4 MIP	.22
BT10-12FL	MM01135	5/8 OD x 3/4 MIP	.36

Elbow

8920613	MM01136	3/8	.10
8920621	MM01137	1/2	.14
8920639	MM01138	5/7	.22

Male Elbow

Order Number	Price Ref. #	Size (in)	Wt (lbs)
8920522	MM01139	1/4 OD x 1/8 MIP	.04
415072	MM01140	1/4 OD x 1/4 MIP	.05
8920530	MM01141	3/8 OD x 1/4 MIP	.08
8920548	MM01142	3/8 OD x 3/8 MIP	.11
8920555	MM01143	3/8 OD x 1/2 MIP	.12
SE06-12FL	MM01144	3/8 OD x 3/4 MIP	.12
8920563	MM01145	1/2 OD x 3/8 MIP	.13
8920571	MM01146	1/2 OD x 1/2 MIP	.14

Order Number	Price Ref. #	Size (in)	Wt (lbs)
8920589	MM01147	1/2 OD x 3/4 MIP	.24
8920597	MM01148	5/8 OD x 1/2 MIP	.20
8920605	MM01149	5/8 OD x 3/4 MIP	.25
SE12-08FL	MM01150	3/4 OD x 1/2 MIP	.30
SE12-12FL	MM01151	3/4 OD x 3/4 MIP	.30

Female Elbow

410314	MM01152	1/4 OD x 1/4 FIP	.08
415241	MM01153	3/8 OD x 3/8 FIP	.10
8920654	MM01154	3/8 OD x 1/2 FIP	.14
8920662	MM01155	3/8 OD x 3/4 FIP	.12
8923872	MM01156	1/2 OD x 3/8 FIP	.12
8920670	MM01157	1/2 OD x 1/2 FIP	.18

8920688	MM01158	1/2 OD x 3/4 FIP	.20
8920696	MM01159	5/8 OD x 1/2 FIP	.20
8920704	MM01160	5/8 OD x 3/4 FIP	.28
LF12-08FL	MM01161	3/4 OD x 1/2 FIP	.42
LF12-12FL	MM01162	3/4 OD x 3/4 FIP	.40

Male Adapter

8920266	MM01163	1/4 OD x 1/8 MIP	.03
8920274	MM01164	1/4 OD x 1/4 MIP	.03
414910	MM01165	5/16 OD x 1/4 MIP	.06
434113	MM01166	3/8 OD x 1/8 MIP	.07
8920308	MM01167	3/8 OD x 1/4 MIP	.06
8920316	MM01168	3/8 OD x 3/8 MIP	.09
8920324	MM01169	3/8 OD x 1/2 MIP	.12
8920332	MM01170	3/8 OD x 3/4 MIP	.18

8920357	MM01171	1/2 OD x 3/8 MIP	.10
8920365	MM01172	1/2 OD x 1/2 MIP	.13
8920373	MM01173	1/2 OD x 3/4 MIP	.22
8920381	MM01174	5/8 OD x 1/2 MIP	.20
8920399	MM01175	5/8 OD x 3/4 MIP	.21
MA12-08FL	MM01176	3/4 OD x 1/2 MIP	.28
MA12-12FL	MM01177	3/4 OD x 3/4 MIP	.28

Female Adapter

8920415	MM01178	1/4 OD x 1/4 FIP	.08
8920423	MM01179	3/8 OD x 1/4 FIP	.08
8920431	MM01180	3/8 OD x 3/8 FIP	.108
8920449	MM01181	3/8 OD x 1/2 FIP	.16
8920456	MM01182	3/8 OD x 3/4 FIP	.17
8920464	MM01183	1/2 OD x 3/8 FIP	.14

8920472	MM01184	1/2 OD x 1/2 FIP	.12
8920480	MM01185	1/2 OD x 3/4 FIP	.17
8920498	MM01186	5/8 OD x 1/2 FIP	.12
8920506	MM01187	5/8 OD x 3/4 FIP	.17
FA12-08FL	MM01188	3/4 OD x 1/2 FIP	.32
8920514	MM01189	3/4 OD x 3/4 FIP	.27

Plug

8920860	MM01190	1/4 OD	.02
8920878	MM01191	3/8 OD	.06

8920886	MM01192	1/2 OD	.10
414279	MM01193	5/8	.14

Cap

8920142	MM01194	1/4	.02
8920159	MM01195	3/8	.03

8920167	MM01196	1/2	.14
8920175	MM01197	5/8	.20

Valve Gas Tee Handle

VG38BR	MM01198	3/8 FIP	.57
VG12BR	MM01199	1/2 FIP	.69
VG34BR	MM01200	3/4 FIP	.81
VG38BR	MM01201	3/8 OD	.57
VG12BR	MM01202	1/2 OD	.69
6117006	MM01203	3/8 OD x 1/2 FIP	.69

6117002	MM01204	1/2 OD x 1/2 FIP	.69
935124	MM01205	5/8 OD x 3/4 FIP	.81
6410201	MM01206	3/8 FIP	.57
6410301	MM01207	1/2 FIP	.69
6410401	MM01208	3/4 FIP	.81
6410501	MM01209	1 FIP	1.48

Flare Bin 72 Hole Assortment

Order Number	Price Ref. #	Description	Wt (lbs)
FLGBB	MM01210	12" deep, 34" wide and 42" tall 72 Hole Steel Bin	185

Compression Fittings

Sleeve

Order Number	Price Ref. #	Size (in)	Wt (lbs)
415937	MM01211	1/8	.01
8920902	MM01212	3/16	.01
0515619	MM01213	1/4	.01
5683636	MM01214	5/16 OD	.01

Order Number	Price Ref. #	Size (in)	Wt (lbs)
4460549	MM01215	3/8 OD	.02
3534641	MM01216	1/2	.02
8920951	MM01217	5/8 OD	.03
8925299	MM01218	7/8 OD	.03

Derlin Sleeve

3453826	MM01219	1/4	.01
440767	MM01220	5/16 OD	.01
478784	MM01221	3/8 OD	.02

478792	MM01222	1/2 OD	.02
478806	MM01223	5/8 OD	.02

Brass Insert

4444196	MM01224	1/4 OD	.02
440865	MM01225	5/16 OD	.02
2381366	MM01226	3/8	.03

478938	MM01227	1/2 OD	.03
478946	MM01228	5/8 OD	.03

Nut

478814	MM01229	1/8 OD	.01
8920969	MM01230	3/16 OD	.01
9113168	MM01231	1/4 OD	.02
8920985	MM01232	5/16 OD	.02

8920993	MM01233	3/8 OD	.04
8921009	MM01234	1/2 OD	.04
8921017	MM01235	5/8 OD	.06
457507	MM01236	7/8 OD	.10

Cap

863829	MM01237	1/4	.02
863803	MM01238	3/8	.04
863845	MM01239	1/2	.06

Union

420123	MM01240	1/8	.03
8921025	MM01241	3/16 OD	.04
8921033	MM01242	1/4 OD	.06
8921041	MM01243	5/16 OD	.06
8921538	MM01244	3/8 OD x 1/4 OD	.10
8921058	MM01245	3/8 OD	.10

8921546	MM01246	1/2 OD x 3/8 OD	.12
8921066	MM01247	1/2 OD	.16
8921553	MM01248	5/8 OD x 3/8 OD	.15
8921561	MM01249	5/8 OD x 1/2 OD	.15
8921074	MM01250	5/8 OD	.26
8921579	MM01251	7/8 OD	.36

Male Adapter

462551	MM01252	1/8 OD x 1/8 MIP	.04
8921272	MM01253	3/16 OD x 1/8 MIP	.04
431526	MM01254	3/16 OD x 1/4 MIP	.06
8921280	MM01255	1/4 OD x 1/8 MIP	.04
8921298	MM01256	1/4 OD x 1/4 MIP	.06
8921306	MM01257	5/16 OD x 1/8 MIP	.05
8921314	MM01258	5/16 OD x 1/4 MIP	.06
431571	MM01259	3/8 OD x 1/8 MIP	.06

8921348	MM01260	3/8 OD x 1/4 MIP	.07
8290926	MM01261	3/8 OD x 3/8 MIP	.08
8921355	MM01262	3/8 OD x 1/2 MIP	.12
8921363	MM01263	1/2 OD x 3/8 MIP	.12
8921371	MM01264	1/2 OD x 1/2 MIP	.12
1184779	MM01265	5/8 OD x 3/8 MIP	.24
8921389	MM01266	5/8 OD x 1/2 MIP	.24
8427940	MM01267	5/8 OD x 3/4 MIP	.26
8921587	MM01268	7/8 OD x 3/4 MIP	.28

Female Adapter

8921181	MM01269	1/4 OD x 1/8 FIP	.05
8921199	MM01270	1/4 OD x 1/4 FIP	.09
8921223	MM01271	3/8 OD x 1/4 FIP	.08
8290975	MM01272	3/8 OD x 3/8 FIP	.08

8921231	MM01273	3/8 OD x 1/2 FIP	.08
8921249	MM01274	1/2 OD x 3/8 FIP	.12
8921256	MM01275	1/2 OD x 1/2 FIP	.12

Tees

8921132	MM01276	1/4 OD	.10
8921157	MM01277	3/8 OD	.16
434906	MM01278	3/8 OD x 1/4 OD	.14

8921165	MM01279	1/2 OD	.24
8921173	MM01280	5/8 OD	.28

Elbows

Order Number	Price Ref. #	Size (in)	Wt (lbs)
8921082	MM01281	1/4 OD	.08
416277	MM01282	5/16	.09
8921108	MM01283	3/8 OD	.12
8921116	MM01284	1/2 OD	.19
8921124	MM01285	5/8 OD	.26
8940858	MM01286	3/16 OD x 1/8 MIP	.06
9624719	MM01287	1/8 OD x 1/8 MIP	.04
8921397	MM01288	1/4 OD x 1/8 MIP	.06

Order Number	Price Ref. #	Size (in)	Wt (lbs)
8921405	MM01289	1/4 OD x 1/4 MIP	.08
450898	MM01290	5/16 OD x 1/8 MIP	.06
8921413	MM01291	3/8 OD x 1/4 MIP	.08
8921421	MM01292	3/8 OD x 3/8 MIP	.10
8290652	MM01293	3/8 OD x 1/2 MIP	.14
2215655	MM01294	1/2 OD x 3/8 MIP	.19
1186469	MM01295	1/2 OD x 1/2 MIP	.17
8921439	MM01296	5/8 OD x 1/2 MIP	.20