

## Type L Jaw Couplers

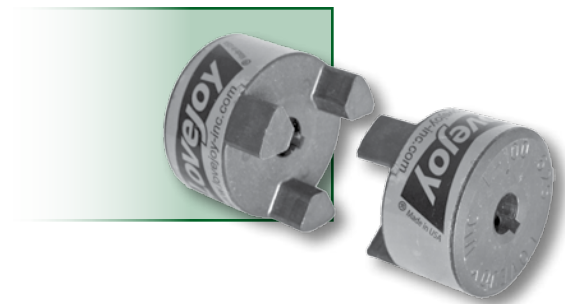

- Jaw couplers are standard shaft-to-shaft couplers for industrial applications
- Manufactured with high grade sintered iron
- Resistant to oil, dirt, sand, moisture, & grease
- Note: Two couplers and one spider are needed to make one complete unit

Order Number	Price Ref. #	Bore (in)	Overall (in)	Spider Series	Wt (lbs)
L050.25	EE00001	1/4	1-11/16	L050	0.2
L050.3125	EE00002	5/16	1-11/16	L050	0.2
L050.375	EE00003	3/8	1-11/16	L050	0.2
L050.437	EE00004	7/16	1-11/16	L050	0.2
L050.50	EE00005	1/2	1-11/16	L050	0.1
L050.625	EE00006	5/8	1-11/16	L050	0.1
L070.375	EE00007	3/8	1-15/16	L070	0.3
L070.437	EE00008	7/16	1-15/16	L070	0.3
L070.50	EE00009	1/2	1-15/16	L070	0.3
L070.5625	EE00010	9/16	1-15/16	L070	0.3
L070.625	EE00011	5/8	1-15/16	L070	0.3
L070.750	EE00012	3/4	1-15/16	L070	0.2
L075.375	EE00013	3/8	2-1/8	L075	0.5
L075.437	EE00014	7/16	2-1/8	L075	0.5
L075.50	EE00015	1/2	2-1/8	L075	0.5
L075.5625	EE00016	9/16	2-1/8	L075	0.5
L075.625	EE00017	5/8	2-1/8	L075	0.5
L075.750	EE00018	3/4	2-1/8	L075	0.4
L075.875	EE00019	7/8	2-1/8	L075	0.4
L090.437	EE00020	7/16	2-1/8	L090	0.7
L090.50	EE00021	1/2	2-1/8	L090	0.7
L090.5625	EE00022	9/16	2-1/8	L090	0.7
L090.625	EE00023	5/8	2-1/8	L090	0.6
L090.750	EE00024	3/4	2-1/8	L090	0.6
L090.875	EE00025	7/8	2-1/8	L090	0.6
L0901.00	EE00026	1	2-1/8	L090	0.6
L095.437	EE00027	7/16	2-1/2	L090	0.8
L095.50	EE00028	1/2	2-1/2	L090	0.8
L095.5625	EE00029	9/16	2-1/2	L090	0.8
L095.625	EE00030	5/8	2-1/2	L090	0.8
L095.750	EE00031	3/4	2-1/2	L090	0.7
L095.875	EE00032	7/8	2-1/2	L090	0.7

Order Number	Price Ref. #	Bore (in)	Overall (in)	Spider Series	Wt (lbs)
L095.9375	EE00033	15/16	2-1/2	L090	0.7
L0951.00	EE00034	1	2-1/2	L090	0.7
L0951.125	EE00035	1-1/8	2-1/2	L090	0.6
L100.500	EE00036	1/2	3-7/16	L100	1.5
L100.563	EE00037	9/16	3-7/16	L100	1.6
L100.625	EE00038	5/8	3-7/16	L100	1.6
L100.750	EE00039	3/4	3-7/16	L100	1.5
L100.875	EE00040	7/8	3-7/16	L100	1.5
L1001.00	EE00041	1	3-7/16	L100	1.4
L1001.125	EE00042	1-1/8	3-7/16	L100	1.3
L1001.250	EE00043	1-1/4	3-7/16	L100	1.3
L1001.375	EE00044	1-3/8	3-7/16	L100	1.2
L110.750	EE00045	3/4	4-3/16	L110	3.3
L110.875	EE00046	7/8	4-3/16	L110	3.2
L1101.00	EE00047	1	4-3/16	L110	2.9
L1101.125	EE00048	1-1/8	4-3/16	L110	3.0
L1101.250	EE00049	1-1/4	4-3/16	L110	2.9
L1101.375	EE00050	1-3/8	4-3/16	L110	2.8
L1101.4375	EE00051	1-7/16	4-3/16	L110	2.7
L1101.50	EE00052	1-1/2	4-3/16	L110	2.7
L1101.625	EE00053	1-5/8	4-3/16	L110	2.6
L150.625	EE00054	5/8	4-7/16	L150	4.2
L150.750	EE00055	3/4	4-7/16	L150	4.2
L150.875	EE00056	7/8	4-7/16	L150	4.2
L1501.00	EE00057	1	4-7/16	L150	4.1
L1501.125	EE00058	1-1/8	4-7/16	L150	4.1
L1501.250	EE00059	1-1/4	4-7/16	L150	4.0
L1501.375	EE00060	1-3/8	4-7/16	L150	3.9
L1501.4375	EE00061	1-7/16	4-7/16	L150	3.9
L1501.50	EE00062	1-1/2	4-7/16	L150	3.8
L1501.625	EE00063	1-5/8	4-7/16	L150	3.7
L1501.750	EE00064	1-3/4	4-7/16	L150	3.6
L1501.875	EE00065	1-7/8	4-7/16	L150	3.4

**Jaw Coupler Spiders**

Buna N, Urethane, & Hytrel Spiders

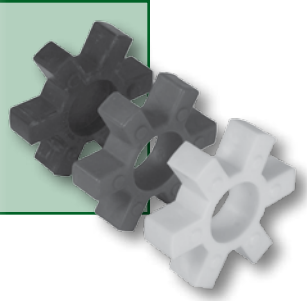

**Buna N Rubber - Black**

- Highly flexible, good oil resistance

**Urethane - Blue**

- Greater torque capacity, lower dampening effect, very good oil, and chemical resistance
- Not recommended for start/stop applications

**Hytrel - Tan**

- High torque and temperature capacity, excellent oil and chemical resistance
- Not recommended for start/stop applications

Order Number	Price Ref. #	Torque (in-lb)	Material	Wt (lbs)
L050	EE00066	26.3	Buna N	0.01
L050H	EE00067	50.0	Hytrel	0.01
L070	EE00068	43.2	Buna N	0.01
L070H	EE00069	114.0	Hytrel	0.01
L075	EE00070	90.0	Buna N	0.03
L075U	EE00071	135.0	Urethane	0.02
L075H	EE00072	227.0	Hytrel	0.02
L090	EE00073	144.0	Buna N	0.04
L090U	EE00074	216.0	Urethane	0.03
L090H	EE00075	401.0	Hytrel	0.03

Order Number	Price Ref. #	Torque (in-lb)	Material	Wt (lbs)
L100	EE00076	417.0	Buna N	0.06
L100U	EE00077	626.0	Urethane	0.06
L100H	EE00078	1134.0	Hytrel	0.06
L110	EE00079	792.0	Buna N	0.2
L110U	EE00080	1188.0	Urethane	0.2
L110H	EE00081	2268.0	Hytrel	0.2
L1500	EE00082	1240.0	Buna N	0.2
L150U	EE00083	1860.0	Urethane	0.2
L150H	EE00084	3708.0	Hytrel	0.2

**S-Flex Sleeves**

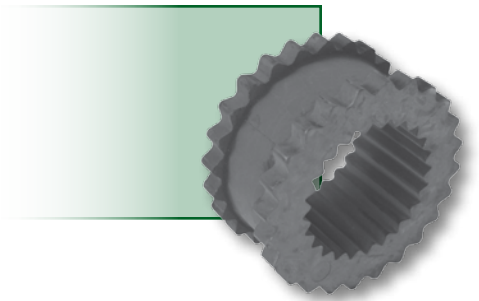

- One-piece design molded in EPDM rubber
- Pre-molded teeth along the diameter of the sleeve engage with teeth of the coupling flanges
- S-flex sleeves protect connected equipment from harmful shock loading, vibration, and shaft misalignment

Order Number	Price Ref. #	Min. Bore (in)	Torque (in-lb)	Wt (lbs)
3JE	EE00085	3/8	60	0.08
4JE	EE00086	1/2	120	0.2
5JE	EE00087	1/2	240	0.3
6JE	EE00088	5/8	450	0.5

Order Number	Price Ref. #	Min. Bore (in)	Torque (in-lb)	Wt (lbs)
7JE	EE00089	5/8	725	0.7
8JE	EE00090	3/4	1135	1.1
9JE	EE00091	7/8	1800	1.8

## Finished Bore Chain Couplers

Finished Bore, Bushing Type Couplers, & Coupler Chain

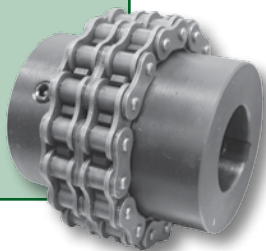

- Solid steel sprockets with hardened teeth designed for a long service life
- Two half couplers and one chain are needed to make one complete unit
- Coupler chain consists of precut lengths of Drives USA double roller chain with a connector link

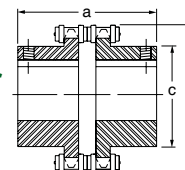

### Finished Bore Coupler Sprockets

Order Number	Price Ref. #	Bore (in)	Chain Size	No. of Teeth	a (in)	b (in)	c (in)	Wt (lbs) Half Coupler
C40128	EE00092	1/2	40	12	2-11/16	2-3/8	1-3/8	0.3
C401210	EE00093	5/8	40	12	2-11/16	2-3/8	1-3/8	0.3
C401212	EE00094	3/4	40	12	2-11/16	2-3/8	1-3/8	0.3
C401612	EE00095	3/4	40	16	2-11/16	3	2	0.8
C401614	EE00096	7/8	40	16	2-11/16	3	2	0.8
C401616	EE00097	1	40	16	2-11/16	3	2	0.8
C401618	EE00098	1-1/8	40	16	2-11/16	3	2	0.8
C401620	EE00099	1-1/4	40	16	2-11/16	3	2	0.8
C501612	EE00100	3/4	50	16	3	3-3/4	2-1/2	0.8
C501614	EE00101	7/8	50	16	3	3-3/4	2-1/2	1.8
C501616	EE00102	1	50	16	3	3-3/4	2-1/2	1.8
C501618	EE00103	1-1/8	50	16	3	3-3/4	2-1/2	1.8
C501620	EE00104	1-1/4	50	16	3	3-3/4	2-1/2	1.8
C501622	EE00105	1-3/8	50	16	3	3-3/4	2-1/2	1.8
C501624	EE00106	1-1/2	50	16	3	3-3/4	2-1/2	1.8
C501816	EE00107	1	50	18	3-5/8	4-1/8	3	2.0
C501822	EE00108	1-3/8	50	18	3-5/8	4-1/8	3	2.0
C501824	EE00109	1-1/2	50	18	3-5/8	4-1/8	3	2.0
C501828	EE00110	1-3/4	50	18	3-5/8	4-1/8	3	2.0
C601824	EE00111	1-1/2	60	18	4-9/16	5	3-5/8	5.2

### Bushing Type Coupler Sprockets

Order Number	Price Ref. #	Bushing Series	Chain Size	No. of Teeth	a (in)	b (in)	c (in)	Wt (lbs) Half Coupler
C4020XH	EE00112	H	40	20	2-5/16	3-5/8	2-1/2	0.9
C5016XH	EE00113	H	50	16	2-1/4	3-3/4	2-1/2	0.9
C5018XP	EE00114	P1	50	18	3-3/16	4-1/8	3	1.8
C6018XP	EE00115	P1	60	18	3-3/16	4-3/8	3-1/2	3.1
C6020XB	EE00116	B	60	20	4-1/16	5-1/2	4-1/8	3.5
C8018XQ	EE00117	Q1	80	18	4-5/16	5-7/8	4-1/2	6.1

NOTE: For bushings, please see page 42 and 50

### Coupler Chain - Double

Order Number	Price Ref. #	Chain Size	No. of Teeth	Wt (lbs)
C4012	EE00118	40	12	0.3
C4016	EE00119	40	16	0.5
C4020	EE00120	40	20	0.6
C5016	EE00121	50	16	1.0
C5018	EE00122	50	18	1.1

Order Number	Price Ref. #	Chain Size	No. of Teeth	Wt (lbs)
C6016	EE00123	60	16	1.9
C6018	EE00124	60	18	2.2
C6020	EE00125	60	20	2.5
C8018	EE00126	80	18	5.9

## G&G Chain Couplers

Finished Bore Couplers & Coupler Chain

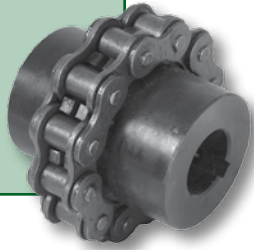

- Economical couplers that only use single chain to combine half couplers
- Two half couplers and one chain are needed to make one complete unit
- Coupler chain consists of precut lengths of Drives USA single roller chain with a connector link

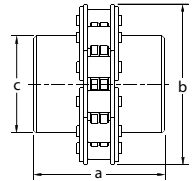

### Finished Bore Half Coupler Sprockets

Order Number	Price Ref. #	Chain Size	No. of Teeth	Bore	a (in)	b (in)	c (in)	Wt (lbs) Half Coupler
0291000	EE00127	50	10	5/8	2-1/4	2-19/32	1-9/16	0.5
0291200	EE00128	50	10	3/4	2-1/4	2-19/32	1-9/16	0.5
0291400	EE00129	50	10	7/8	2-1/4	2-19/32	1-9/16	0.5
0310000	EE00130	60	10	1/2	2-1/2	3-1/8	1-11/16	0.8
0311000	EE00131	60	10	5/8	2-1/2	3-1/8	1-11/16	0.9
0311200	EE00132	60	10	3/4	2-1/2	3-1/8	1-11/16	0.8
0311400	EE00133	60	10	7/8	2-1/2	3-1/8	1-11/16	0.7
0311500	EE00134	60	10	15/16	2-1/2	3-1/8	1-11/16	0.7
0311600	EE00135	60	10	1	2-1/2	3-1/8	1-11/16	0.7
0311800	EE00136	60	10	1-1/8	2-1/2	3-1/8	1-11/16	0.6
0320000	EE00137	60	12	1/2	2-7/8	3-9/16	2-1/8	1.5
0321000	EE00138	60	12	5/8	2-7/8	3-9/16	2-1/8	1.5
0321200	EE00139	60	12	3/4	2-7/8	3-9/16	2-1/8	1.5
0321400	EE00140	60	12	7/8	2-7/8	3-9/16	2-1/8	1.4
0321500	EE00141	60	12	15/16	2-7/8	3-9/16	2-1/8	1.4
0321600	EE00142	60	12	1	2-7/8	3-9/16	2-1/8	1.3
0321700	EE00143	60	12	1-1/16	2-7/8	3-9/16	2-1/8	1.3
0321800	EE00144	60	12	1-1/8	2-7/8	3-9/16	2-1/8	1.2
0322000	EE00145	60	12	1-1/4	2-7/8	3-9/16	2-1/8	1.2
0322200	EE00146	60	12	1-3/8	2-7/8	3-9/16	2-1/8	1.0
0322300	EE00147	60	12	1-7/16	2-7/8	3-9/16	2-1/8	0.9
0330000	EE00148	80	12	7/8	4	4-25/32	2-7/8	3.6
0331600	EE00149	80	12	1	4	4-25/32	2-7/8	3.5
0331800	EE00150	80	12	1-1/8	4	4-25/32	2-7/8	3.3
0332000	EE00151	80	12	1-1/4	4	4-25/32	2-7/8	3.2
0332200	EE00152	80	12	1-3/8	4	4-25/32	2-7/8	3.0
0332400	EE00153	80	12	1-1/2	4	4-25/32	2-7/8	2.9
0332800	EE00154	80	12	1-3/4	4	4-25/32	2-7/8	2.5

### Coupler Chain - Single

Order Number	Price Ref. #	Chain Size	No. of Teeth	Wt (lbs)
0301050	EE00155	50	10	0.38
0301060	EE00156	60	10	0.56

Order Number	Price Ref. #	Chain Size	No. of Teeth	Wt (lbs)
0301260	EE00157	60	12	0.69
0301280	EE00158	80	12	1.63



## Round Bore Shaft Couplers

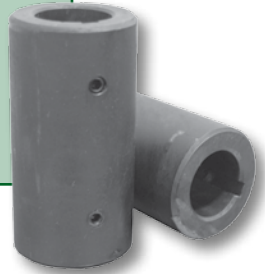

- Economical solid shaft round bore couplers
- Manufactured with durable mild steel
- Set screw keyed to grip shaft securely

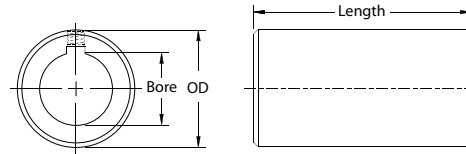

Order Number	Price Ref. #	Bore (in)	OD (in)	Length (in)	Wt (lbs)
1270800	EE00159	1/2	1-1/4	2	0.6
1271000	EE00160	5/8	1-1/2	2-1/2	1.0
1271200	EE00161	3/4	1-5/8	3	1.4
1271400	EE00162	7/8	1-3/4	3	1.3
1271600	EE00163	1	1-5/8	3	1.1
1271604	EE00164	1	1-3/4	4	2.0
1271800	EE00165	1-1/8	2	4-1/2	2.7
1271900	EE00166	1-3/16	2	4-1/2	2.5

Order Number	Price Ref. #	Bore (in)	OD (in)	Length (in)	Wt (lbs)
1272000	EE00167	1-1/4	2-1/8	4-1/2	2.9
1272005	EE00168	1-1/4	2-1/8	4-1/2	2.8
1272200	EE00169	1-3/8	2-5/16	4-1/2	3.4
1272300	EE00170	1-7/16	2-5/16	4-1/2	3.2
1272400	EE00171	1-1/2	2-1/2	4-1/2	3.9
1272600	EE00172	1-5/8	2-5/8	4-1/2	4.2
1272800	EE00173	1-3/4	2-3/4	4-1/2	4.4
1273100	EE00174	1-15/16	3-5/16	4-1/2	7.0
1273200	EE00175	2	3-5/16	4-1/2	6.9

## Coupler Hubs



- Coupler hubs are designed to connect two separate shafts with two weld hubs
- Excellent coupler for applications with two different shaft sizes
- **NOTE:** For weld hubs, see page 103

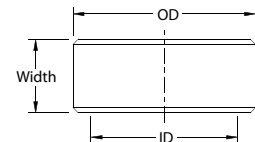

Order Number	Price Ref. #	Hub Series	OD (in)	ID (in)	Width (in)	Wt (lbs)
0123226	EE00176	W	2	1-5/8	1	0.4
0124032	EE00177	X	2-1/2	2	1	0.5

## Tire Couplers

Flanges & Tires



- Excellent for applications with shock loads, angular misalignment up to 4° and end float up to 1/4"
- Tires feature double-woven textile cords for greater torque capacity
- Two half couplers and one tire are needed to make one complete unit

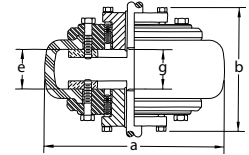

### Flanges

Order Number	Price Ref. #	Bushing Series	Max Bore	a (in)	b (in)	e (in)	g (in)	Wt (lbs) Half Coupler
MXF50JA	EE00178	JA	1-1/4	5-1/4	3-7/8	7/8	1-17/32	2.1
MXF60SH	EE00179	SH	1-5/8	6-1/2	4-23/32	1-9/32	1-25/32	3.5
MXF70SDS	EE00180	SDS	1-15/16	7-3/8	4-17/32	1-1/2	1-1/2	4.7
MXF80SK	EE00181	SK	2-1/2	8-3/8	5-13/16	1-1/2	1-1/2	6.9
MXF90SK	EE00182	SK	2-1/2	9-1/4	5-7/8	1-17/32	1-9/16	10.0
MXF100SF	EE00183	SF	2-3/4	10	6-1/8	1-23/32	1-15/32	15.0
MXF110SF	EE00184	SF	2-3/4	11	5-7/8	1-9/16	1-3/16	21.5
MXF120E	EE00185	E	3-7/16	12-3/8	7-1/4	1-3/4	1-1/4	28.0
MXF140F	EE00186	F	3-15/16	14-1/8	9-1/2	2-1/16	1-3/8	64.0
MXF160J	EE00187	J	4	16-5/8	11-1/2	2-11/16	1-3/8	100.0
MXF200J	EE00188	J	4	20	11-3/4	3-5/16	1-13/16	174.0

### Tires

Order Number	Price Ref. #	Coupler #	Wt (lbs) Half Coupler
P50	EE00189	MXF50JA	0.5
P60	EE00190	MXF60SH	1.0
P70	EE00191	MXF70SDS	1.3
P80	EE00192	MXF80SK	1.7
P90	EE00193	MXF90SK	2.0
P100	EE00194	MXF100SF	2.0

Order Number	Price Ref. #	Coupler #	Wt (lbs) Half Coupler
P110+	EE00195	MXF110SF	3.0
P120+	EE00196	MXF120E	3.8
P140	EE00197	MXF140F	4.5
P160	EE00198	MXF160J	8.7
P200+	EE00199	MXF200J	18.0

NOTE: For bushings to fit Maskaflex Tire Couplers, see QD Bushings on page 34.