



**Weasler®**

*AFTERMARKET  
PRODUCT GUIDE*

# *REPLACEMENT DRIVELINES*

*REPLACEMENT  
DRIVELINES*





**Weasler®**

# AFTERMARKET REPLACEMENT DRIVELINES

**BUSH HOG  
DEERE  
RHINO  
KING KUTTER  
CASE IH  
KMC  
VERMEER  
CNH  
NEW HOLLAND  
SCHULTE  
GEHL  
LANDPRIDE  
SHAVER  
HESSTON  
SPEECO  
AGCO  
WALLACE  
KINZE  
WOODS  
HOWSE  
BUSH WHACKER  
MTD  
AMADAS  
TONUTTI  
ALLOWAY  
SITREX**

*...and MANY MORE*



- ALL PURPOSE DRIVELINES•
- BEET HARVESTERS•
- CATFISH POND DRIVELINES•
- COMBINE HEADERS•
- DISC MOWERS•
- FERTILIZER SPREADERS•
- FINISHING MOWERS•
- FLEX WING MOWERS•
- HAMMER MILLS•
- HAY TEDDERS•
- PEANUT HARVESTERS•
- POST HOLE DIGGERS•
- ROUND BALERS•
- ROTARY CUTTERS•
- SNOWBLOWERS•
- TILLERS•



**REPLACEMENT  
DRIVELINES**

*Quality Fits. Every Time.*



**Weasler®**

**CONSTANT VELOCITY DRIVELINES**

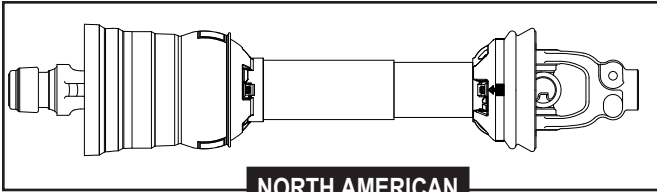

**NORTH AMERICAN**

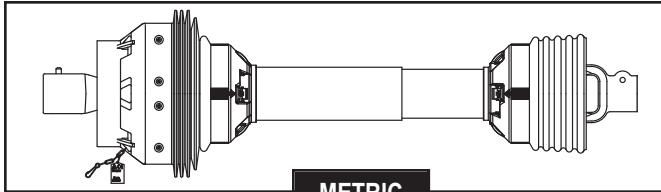

**METRIC**



**• FLEX WING MOWERS •**

Interchange with:

**• BUSH HOG® Model No.: 2415, 2515, 2615, 2720 & 3615** ALSO FITS OTHER COMPETITIVE MODELS

**NORTH AMERICAN** **COMPLETE DRIVELINE ASSEMBLY** **METRIC**

STOCK #	TRACTOR YOKE	CLAMP YOKE	SERIES	STOCK #	TRACTOR YOKE	CLAMP YOKE	SERIES
14515555	1 3/8" x 6 Spl.	1 3/4" x 20 Spl.	55R	14517955	1 3/8" x 6 Spl.	1 3/4" x 20 Spl.	W/S 2580
14615555	1 3/8" x 21 Spl.	1 3/4" x 20 Spl.	55R	14617955	1 3/8" x 21 Spl.	1 3/4" x 20 Spl.	W/S 2580
14715555	1 3/4" x 20 Spl.	1 3/4" x 20 Spl.	55R	14717955	1 3/4" x 20 Spl.	1 3/4" x 20 Spl.	W/S 2580

(OVERALL COMPRESSED LENGTH - 55")

**DRIVELINE TRACTOR HALF ASSEMBLY**

STOCK #	TRACTOR YOKE	SERIES	STOCK #	TRACTOR YOKE	SERIES
93-14505555	1 3/8" x 6 Spl.	55R	93-14517955	1 3/8" x 6 Spl.	W/S 2580
93-14605555	1 3/8" x 21 Spl.	55R	93-14617955	1 3/8" x 21 Spl.	W/S 2580
93-14705555	1 3/4" x 20 Spl.	55R	93-14717955	1 3/4" x 20 Spl.	W/S 2580

**DRIVELINE MACHINE HALF ASSEMBLY**

STOCK #	MACHINE (CLAMP) YOKE	SERIES	STOCK #	MACHINE (CLAMP) YOKE	SERIES
92-14515555	1 3/4" x 20 Spl.	55R	92-14517955	1 3/4" x 20 Spl.	W/S 2580

**REPLACEMENT DRIVELINES**

# AFTERMARKET REPLACEMENT DRIVELINES

## CONSTANT VELOCITY DRIVELINES *...continued*

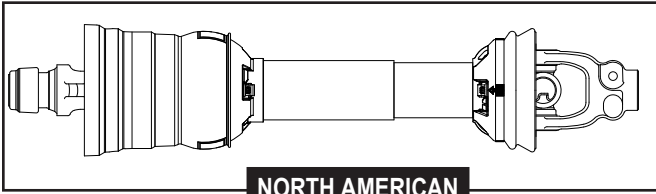

**NORTH AMERICAN**

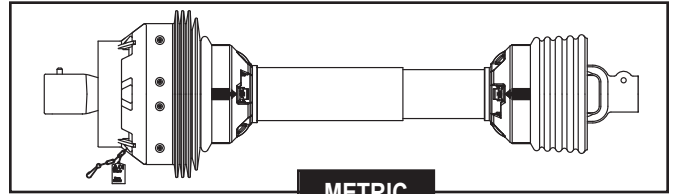

**METRIC**



**• FLEX WING MOWERS •**

Interchange with:

**• RHINO® Model No.: SR-15, SE-15**

ALSO FITS OTHER  
COMPETITIVE MODELS

**NORTH AMERICAN**

### COMPLETE DRIVELINE ASSEMBLY

**METRIC**

STOCK #	TRACTOR YOKE	CLAMP YOKE	SERIES
14505551	1 3/8" x 6 Spl.	1 3/4" x 20 Spl.	55R
14605551	1 3/8" x 21 Spl.	1 3/4" x 20 Spl.	55R
14705551	1 3/4" x 20 Spl.	1 3/4" x 20 Spl.	55R

STOCK #	TRACTOR YOKE	CLAMP YOKE	SERIES
14507951	1 3/8" x 6 Spl.	1 3/4" x 20 Spl.	W/S 2580
14607951	1 3/8" x 21 Spl.	1 3/4" x 20 Spl.	W/S 2580
14707951	1 3/4" x 20 Spl.	1 3/4" x 20 Spl.	W/S 2580

(OVERALL COMPRESSED LENGTH - 51")

### DRIVELINE TRACTOR HALF ASSEMBLY

STOCK #	TRACTOR YOKE	SERIES
93-14505551	1 3/8" x 6 Spl.	55R
93-14605551	1 3/8" x 21 Spl.	55R
93-14705551	1 3/4" x 20 Spl.	55R

STOCK #	TRACTOR YOKE	SERIES
93-14507951	1 3/8" x 6 Spl.	W/S 2580
93-14607951	1 3/8" x 21 Spl.	W/S 2580
93-14707951	1 3/4" x 20 Spl.	W/S 2580

### DRIVELINE MACHINE HALF ASSEMBLY

STOCK #	MACHINE (CLAMP) YOKE	SERIES
92-14505551	1 3/4" x 20 Spl.	55R

STOCK #	MACHINE (CLAMP) YOKE	SERIES
92-14507951	1 3/4" x 20 Spl.	W/S 2580

**REPLACEMENT  
DRIVELINES**



## CONSTANT VELOCITY DRIVELINES *...continued*

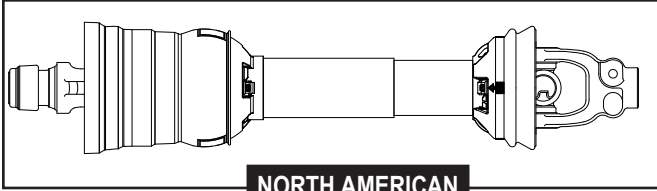

**NORTH AMERICAN**

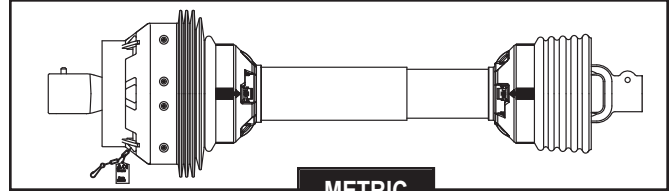

**METRIC**



### • FLEX WING MOWERS •

Interchange with:

### • DEERE® Model No.: 1517, 1518, 2018

ALSO FITS OTHER  
COMPETITIVE MODELS

**NORTH AMERICAN**

**COMPLETE DRIVELINE ASSEMBLY**

**METRIC**

STOCK#	TRACTOR YOKE	CLAMP YOKE	SERIES	STOCK #	TRACTOR YOKE	CLAMP YOKE	SERIES
14515555	1 3/8" x 6 Spl.	1 3/4" x 20 Spl.	55R	14517955	1 3/8" x 6 Spl.	1 3/4" x 20 Spl.	W/S 2580
14615555	1 3/8" x 21 Spl.	1 3/4" x 20 Spl.	55R	14617955	1 3/8" x 21 Spl.	1 3/4" x 20 Spl.	W/S 2580
14715555	1 3/4" x 20 Spl.	1 3/4" x 20 Spl.	55R	14717955	1 3/4" x 20 Spl.	1 3/4" x 20 Spl.	W/S 2580

(OVERALL COMPRESSED LENGTH - 55")

**DRIVELINE TRACTOR HALF ASSEMBLY**

STOCK#	TRACTOR YOKE	SERIES	STOCK #	TRACTOR YOKE	SERIES
93-14505555	1 3/8" x 6 Spl.	55R	93-14517955	1 3/8" x 6 Spl.	W/S 2580
93-14605555	1 3/8" x 21 Spl.	55R	93-14617955	1 3/8" x 21 Spl.	W/S 2580
93-14705555	1 3/4" x 20 Spl.	55R	93-14717955	1 3/4" x 20 Spl.	W/S 2580

**DRIVELINE MACHINE HALF ASSEMBLY**

STOCK#	MACHINE (CLAMP) YOKE	SERIES	STOCK #	MACHINE (CLAMP) YOKE	SERIES
92-14515555	1 3/4" x 20 Spl.	55R	92-14517955	1 3/4" x 20 Spl.	W/S 2580

REPLACEMENT  
DRIVELINES

# AFTERMARKET REPLACEMENT DRIVELINES

## CONSTANT VELOCITY DRIVELINES...continued



### •ROUND BALERS•

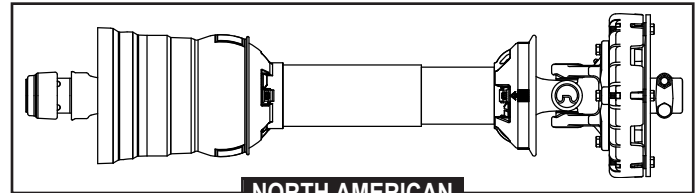

**NORTH AMERICAN**

Interchange with:

• **DEERE®** Model No.: 466, 467, 566 & 567

### COMPLETE DRIVELINE ASSEMBLY

STOCK #	MODEL #	TRACTOR YOKE	CLUTCH YOKE	FRICTION CLUTCH	SERIES	RPM
14503500	466 / 467	1 3/8" x 6 Spl.	1 3/8" x 6 Spl.	18,000 in•lb (9")	35R	540
14603500	566 / 567	1 3/8" x 21 Spl.	1 3/8" x 6 Spl.	10,000 in•lb (9")	35R	1000

(OVERALL COMPRESSED LENGTH - 58")

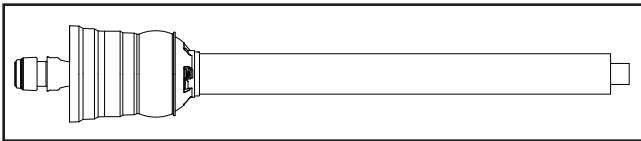

### DRIVELINE TRACTOR SHAFT HALF ASSEMBLY

STOCK#	TRACTOR YOKE	SHAFT HALF	SERIES
19503506	1 3/8" x 6 Spl.	1 11/16" x 20 Spl.	35R
19603521	1 3/8" x 21 Spl.	1 11/16" x 20 Spl.	35R

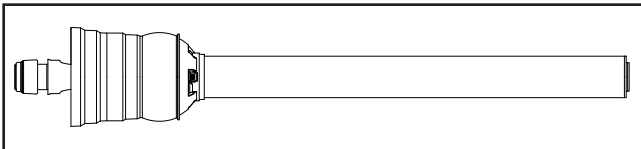

### DRIVELINE TRACTOR TUBE HALF ASSEMBLY

STOCK#	TRACTOR YOKE	TUBE HALF	SERIES
92-14503559	1 3/8" x 6 Spl.	2 1/2" O.D.	35R
92-14603559	1 3/8" x 21 Spl.	2 1/2" O.D.	35R

**NOTE:** The above two part numbers are provided with CV, tube and slip sleeve assembled. C.V. TUBE HALF to connect to TRACTOR PTO.

REPLACEMENT  
DRIVELINES

• **GEHL DELUXE MODEL No.: 2880**

### COMPLETE DRIVELINE ASSEMBLY

STOCK #	TRACTOR YOKE	CLUTCH YOKE	FRICTION CLUTCH	SERIES
14503501	1 3/8" x 6 Spl.	1 3/8" x 21 Spl.	15,000 in•lb (7")	35R

(OVERALL COMPRESSED LENGTH - 67")

### DRIVELINE TRACTOR HALF ASSEMBLY

STOCK#	TRACTOR YOKE	SERIES
19503506	1 3/8" x 6 Spl.	35R



## CONSTANT VELOCITY DRIVELINES...continued



### •ROUND BALERS•

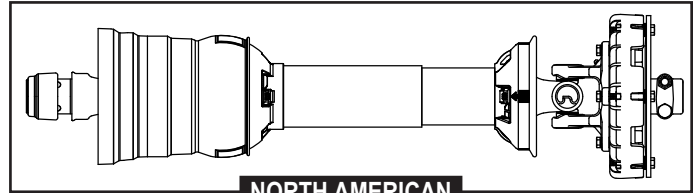

**NORTH AMERICAN**

Interchange with:

- VERMEER Model No.: 604K •
- CASE Model No.: 8455S & 8455T •
- HESSTON Model No.: 555S & 555T •

### COMPLETE DRIVELINE ASSEMBLY

STOCK #	TRACTOR YOKE	CLUTCH YOKE	FRICTION CLUTCH	SERIES	RPM
14503502	1 3/8" x 6 Spl.	1 3/8" x 6 Spl.	15,000 in•lb (7")	35R	540
14603502	1 3/8" x 21 Spl.	1 3/8" x 6 Spl.	15,000 in•lb (7")	35R	1000

(OVERALL COMPRESSED LENGTH - 58")

### DRIVELINE TRACTOR HALF ASSEMBLY

STOCK#	TRACTOR YOKE	SERIES
19503506	1 3/8" x 6 Spl.	35R
19603521	1 3/8" x 21 Spl.	35R



### •BEET HARVESTERS•

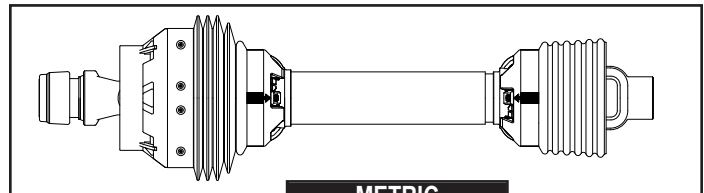

**METRIC**

• LENGTH MAY NEED TO BE MODIFIED TO FIT SPECIFIC MODELS

### COMPLETE DRIVELINE ASSEMBLY

STOCK #	TRACTOR YOKE	MACHINE YOKE	OAL COMPRESSED	SERIES
14607962	1 3/8" x 21 Spl. SSL	1 3/4" Rd. w/Keyway	62.4"	W/S 2580
14707962	1 3/4" x 20 Spl. SSL	1 3/4" Rd. w/Keyway	62.4"	W/S 2580

(OVERALL COMPRESSED LENGTH - 62.4")

REPLACEMENT DRIVELINES

# AFTERMARKET REPLACEMENT DRIVELINES

## CONSTANT VELOCITY DRIVELINES...continued

### •PEANUT HARVESTERS•

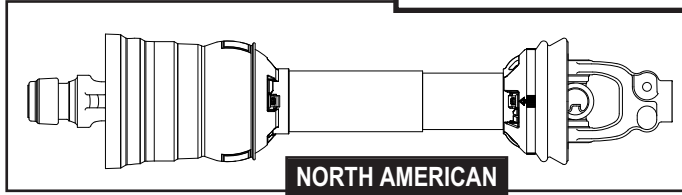

**NORTH AMERICAN**



#### COMPLETE DRIVELINE ASSEMBLY

STOCK #	TRACTOR YOKE	IMPLEMENT YOKE	SERIES
14625555	1 3/8" x 21 Spl.	1 3/8" x 21 Spl. Clamp	55R
14635555	1 3/8" x 21 Spl.	1 3/8" x 21 Spl. w/Pinhole	55R
14725555	1 3/4" x 20 Spl.	1 3/8" x 21 Spl. Clamp	55R
14735555	1 3/4" x 20 Spl.	1 3/8" x 21 Spl. w/Pinhole	55R

(OVERALL COMPRESSED LENGTH - 55")

**KMC MODEL No.:**  
33, 3350, 3355, 3360

#### DRIVELINE TRACTOR HALF ASSEMBLY

STOCK#	TRACTOR YOKE	SERIES
93-14605555	1 3/8" x 21 Spl.	55R
93-14705555	1 3/4" x 20 Spl.	55R

#### DRIVELINE MACHINE HALF ASSEMBLY

STOCK #	MACHINE YOKE	SERIES
92-14625555	1 3/8" x 21 Spl. Clamp	55R
92-14635555	1 3/8" x 21 Spl. w/Pinhole	55R

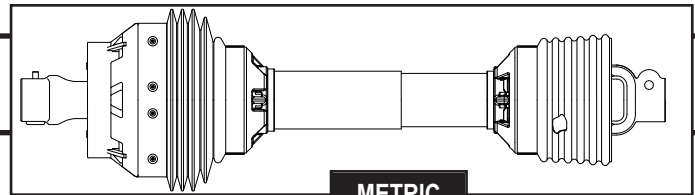

**METRIC**

#### COMPLETE DRIVELINE ASSEMBLY

**AMADAS MODEL No.:**  
9097, 9297, 9597, 9797, 9897, 9897T,  
9997A, 9997B, 9997E, 9997T,  
M2100D/M9997T, M2100A/M9997A

STOCK #	TRACTOR YOKE	IMPLEMENT YOKE	SERIES
14627955	1 3/8" x 21 Spl.	1 3/8" x 21 Spl. Clamp	W/S 2580
14637955	1 3/8" x 21 Spl.	1 3/8" x 21 Spl. w/Pinhole	W/S 2580
14727955	1 3/4" x 20 Spl.	1 3/8" x 21 Spl. Clamp	W/S 2580
14737955	1 3/4" x 20 Spl.	1 3/8" x 21 Spl. w/Pinhole	W/S 2580

(OVERALL COMPRESSED LENGTH - 55")

#### DRIVELINE TRACTOR HALF ASSEMBLY

STOCK#	TRACTOR YOKE	SERIES
93-14617955	1 3/8" x 21 Spl.	W/S 2580
93-14717955	1 3/4" x 20 Spl.	W/S 2580

#### DRIVELINE MACHINE HALF ASSEMBLY

STOCK #	MACHINE YOKE	SERIES
92-14627955	1 3/8" x 21 Clamp	W/S 2580
92-14637955	1 3/8" x 21 Spl. w/Pinhole	W/S 2580

#### COMPLETE DRIVELINE ASSEMBLY (NON-CV)

STOCK #	TRACTOR YOKE	IMPLEMENT YOKE	OAL COMPRESSED	SERIES
14007955	1 3/4" x 20 Spl. QD	1 3/8" x 21 Spl. w/Pinhole	55"	W/S 2500

(Star Tubing)

**REPLACEMENT  
DRIVELINES**



## METRIC DRIVELINES

Interchange with Bondioli & Pavesi and Walterscheid

### •COMBINE HEADERS•

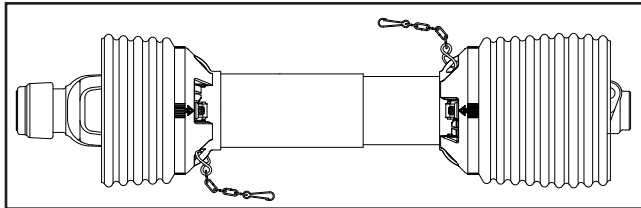

- LENGTH MAY NEED TO BE MODIFIED TO FIT SPECIFIC HEADERS
- CHAINS INCLUDED

STOCK #	COMBINE YOKE	HEADER YOKE	OAL COMPRESSED	DESCRIPTION	SERIES
14007631	1 3/8" x 21 Spl.	1 1/8" Hex Clamp	31"	Deere Headers using (1) Driveline per Header	W/S 2400
14007633	1 1/8" Hex SSL	1 1/8" Hex Clamp	33"	Case IH Combine using Deere Header	W/S 2400
14007635	1 3/8" x 21 Spl.	1 1/8" Hex Clamp	35"	Deere Headers using (2) Drivelines per Header	W/S 2400

#### NORTH AMERICAN DRIVELINE OPTION

14013531	1 3/8" x 21 Spl.	1 1/8" Hex Clamp	31"	90, 900 & 600 Series Platforms	35R
14013533	1 3/8" x 21 Spl.	1 1/8" Hex Clamp	33"	Belt Pick-Up Platforms	35R

REPLACEMENT DRIVELINES

### •SNOWBLOWERS•

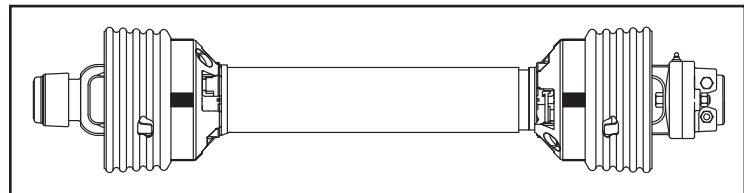

STOCK #	TRACTOR YOKE	IMPLEMENT CLAMP SHEAR BOLT YOKE	OAL COMPRESSED	SHEAR VALUE	SERIES
14406231	1 3/8" x 6 Spl. SSL	1" Rd. w/Keyway	31"	8,000 in-lbs	ByPy 2
14406428	1 3/8" x 6 Spl. SSL	1 1/4" Rd. w/Keyway	28"	16,400 in-lbs	ByPy 4
14406632	1 3/8" x 6 Spl. SSL	1 1/2" Rd. w/Keyway	32"	18,600 in-lbs	ByPy 6
14406639	1 3/8" x 6 Spl. SSL	1 3/8" x 6 Spl.	39"	16,400 in-lbs	ByPy 6
14406832	1 3/8" x 6 Spl. SSL	1 1/2" Rd. w/Keyway	32"	22,000 in-lbs	ByPy 8

# AFTERMARKET REPLACEMENT DRIVELINES

## METRIC DRIVELINES...continued *Interchange with Bondioli & Pavesi and Walterscheid*

### •ALL PURPOSE•

<u>STOCK #</u>	<u>TRACTOR YOKE</u>	<u>IMPLEMENT YOKE</u>	<u>OAL COMPRESSED</u>	<u>SERIES</u>
14006137	1 3/8" x 6 Spl. QD	1 3/8" x 6 Spl. QD	37"	BYPY 1
14006247	1 3/8" x 6 Spl. QD	1 3/8" x 6 Spl. QD	47"	BYPY 2
14006438	1 3/8" x 6 Spl. QD	1 3/8" x 6 Spl. QD	38"	BYPY 4
14006448	1 3/8" x 6 Spl. QD	1 3/8" x 6 Spl. QD	48"	BYPY 4
14006455	1 3/8" x 6 Spl. QD	1 3/8" x 6 Spl. QD	55"	BYPY 4
14006543	1 3/8" x 6 Spl. QD	1 3/8" x 6 Spl. QD	43"	BYPY 5
14006555	1 3/8" x 6 Spl. QD	1 3/8" x 6 Spl. QD	55"	BYPY 5
14006642	1 3/8" x 6 Spl. QD	1 3/8" x 6 Spl. QD	42"	BYPY 6
14006644	1 3/8" x 6 Spl. QD	1 3/8" x 6 Spl. QD	44"	BYPY 6
14006655	1 3/8" x 6 Spl. QD	1 3/8" x 6 Spl. QD	55"	BYPY 6
14006657	1 3/8" x 6 Spl. QD	1 3/8" x 6 Spl. QD	57"	BYPY 6
14006846	1 3/8" x 6 Spl. QD	1 3/8" x 6 Spl. QD	46"	BYPY 8
14006857	1 3/8" x 6 Spl. QD	1 3/8" x 6 Spl. QD	57"	BYPY 8
14016542	1 3/8" x 6 Spl. QD	1 3/8" x 6 Spl. QD	42"	BYPY 5
14016666	1 3/8" x 21 Spl. QD	1 3/8" Rd. w/Pinhole	66"	BYPY 6
14066644	1 3/8" x 21 Spl. QD	1 3/8" x 21 Spl. QD	44"	BYPY 6
14066846	1 3/8" x 21 Spl. QD	1 3/8" x 21 Spl. QD	46"	BYPY 8
14107155	1 3/8" x 6 Spl. QD	30-mm Friction Clutch	55"	W/S 2100
14217939	1 3/8" x 21 Spl. QD	1 3/8" x 21 Spl. w/Clamp Yoke	39"	W/S 2500

### •CATFISH POND DRIVELINE•

<u>STOCK #</u>	<u>TRACTOR YOKE</u>	<u>IMPLEMENT YOKE</u>	<u>OAL COMPRESSED</u>	<u>SERIES</u>
14006424	1 3/8" x 6 Spl. QD	1 1/2" Rd.	48"	BYPY 4
14006524	1 3/8" x 6 Spl. QD	1 1/2" Rd.	48"	BYPY 5
14006624	1 3/8" x 6 Spl. QD	1 1/2" Rd.	48"	BYPY 6
14016524	1 3/8" x 21 Spl. QD	1 1/2" Rd.	48"	BYPY 5
14016624	1 3/8" x 21 Spl. QD	1 1/2" Rd.	48"	BYPY 6

### •DISC MOWER•

<u>STOCK #</u>	<u>TRACTOR YOKE</u>	<u>IMPLEMENT YOKE</u>	<u>OAL COMPRESSED</u>	<u>SERIES</u>
14306538	1 3/8" x 6 Spl. QD	1 3/8" x 6 Spl. w/Overrunning Clutch	38"	BYPY 5
14306639	1 3/8" x 6 Spl. QD	1 3/8" x 6 Spl. w/Overrunning Clutch	39"	BYPY 6
14307645	1 3/8" x 6 Spl. QD	1 3/8" x 6 Spl. w/Overrunning Clutch	45"	W/S 2400

REPLACEMENT  
DRIVELINES



## METRIC DRIVELINES *...continued* *Interchange with Bondioli & Pavesi and Walterscheid*

### •FERTILIZER SPREADER•

<u>STOCK #</u>	<u>TRACTOR YOKE</u>	<u>IMPLEMENT YOKE</u>	<u>OAL COMPRESSED</u>	<u>SERIES</u>
14006127	1 3/8" x 6 Spl. QD	1 3/8" x 6 Spl. QD	27"	BYPY 1
14006135	1 3/8" x 6 Spl. QD	1 3/8" x 6 Spl. QD	35"	BYPY 1

### •FINISHING MOWER•

<u>STOCK #</u>	<u>TRACTOR YOKE</u>	<u>IMPLEMENT YOKE</u>	<u>OAL COMPRESSED</u>	<u>SERIES</u>
14006340	1 3/8" x 6 Spl. QD	1 3/8" x 6 Spl. QD	40"	BYPY 3
14006446	1 3/8" x 6 Spl. QD	1 3/8" x 6 Spl. QD	46"	BYPY 4
14006637	1 3/8" x 6 Spl. QD	1 3/8" x 6 Spl. QD	37"	BYPY 6

### •HAMMER MILL•

<u>STOCK #</u>	<u>TRACTOR YOKE</u>	<u>IMPLEMENT YOKE</u>	<u>OAL COMPRESSED</u>	<u>SERIES</u>
14006628	1 3/8" x 6 Spl. QD	1 3/4" Rd.	48"	BYPY 6
14006748	1 3/8" x 6 Spl. QD	1 3/4" Rd.	48"	BYPY 7

### •HAY TEDDER•

<u>STOCK #</u>	<u>TRACTOR YOKE</u>	<u>IMPLEMENT YOKE</u>	<u>OAL COMPRESSED</u>	<u>TYPE</u>	<u>SERIES</u>
14206252*	1 3/8" x 6 Spl. QD	1 3/8" x 6 Spl. w/Ratchet Clutch	52"	2-Rotor	BYPY 2
14206454**	1 3/8" x 6 Spl. QD	1 3/8" x 6 Spl. w/Ratchet Clutch	54"	4-Rotor	BYPY 4
14207939	1 3/4" x 20 Spl. QD	1 3/8" x 21 Spl. w/Ratchet Clutch	39"	--	W/S 2500

\*Light Duty \*\*Heavy Duty

### •PEANUT HARVESTER (NON-CV)•

<u>STOCK #</u>	<u>TRACTOR YOKE</u>	<u>IMPLEMENT YOKE</u>	<u>OAL COMPRESSED</u>	<u>SERIES</u>
14007955 (Star Tubing)	1 3/4" x 20 Spl. QD	1 3/8" x 21 Spl. w/Pinhole	55"	W/S 2500

REPLACEMENT  
DRIVELINES

# AFTERMARKET REPLACEMENT DRIVELINES

## METRIC DRIVELINES *...continued* *Interchange with Bondioli & Pavesi and Walterscheid*

### •POST HOLE DIGGER•

<u>STOCK #</u>	<u>TRACTOR YOKE</u>	<u>IMPLEMENT YOKE</u>	<u>OAL COMPRESSED</u>	<u>SERIES</u>
14006252	1 3/8" x 6 Spl. QD	1 1/4" Rd. w/Pinhole	52"	BYPY 2 (Light Duty)
14006453	1 3/8" x 6 Spl. QD	1 1/4" Rd. w/Pinhole	53"	BYPY 4 (Heavy Duty)

### •ROTARY CUTTER•

<u>STOCK #</u>	<u>TRACTOR YOKE</u>	<u>IMPLEMENT YOKE</u>	<u>OAL COMPRESSED</u>	<u>APPLICATION</u>	<u>SERIES</u>
14006251	1 3/8" x 6 Spl. QD	1 3/8" Rd. w/Pinhole	51"	Pull (Towed)	BYPY 2
14006432	1 3/8" x 6 Spl. QD	1 3/8" Rd. w/Pinhole	32"	4 ft. Lift (3-Pt.Hitch)	BYPY 4
14006436	1 3/8" x 6 Spl. QD	1 3/8" Rd. w/Pinhole	36"	5 ft. Lift (3-Pt.Hitch)	BYPY 4
14006442	1 3/8" x 6 Spl. QD	1 3/8" Rd. w/Pinhole	42"	6 ft. Lift (3-Pt.Hitch)	BYPY 4
14006451	1 3/8" x 6 Spl. QD	1 3/8" Rd. w/Pinhole	51"	Pull (Towed)	BYPY 4
14006542	1 3/8" x 6 Spl. QD	1 3/8" Rd. w/Pinhole	42"	6 ft. Lift (3-Pt.Hitch)	BYPY 5
14006546	1 3/8" x 6 Spl. QD	1 3/8" x 6 Spl. QD	46"	6 ft. Lift (3-Pt.Hitch)	BYPY 5
14006551	1 3/8" x 6 Spl. QD	1 3/8" Rd. w/Pinhole	51"	6 ft. Lift (3-Pt.Hitch)	BYPY 5
14006652	1 3/8" x 6 Spl. QD	1 3/8" Rd. w/Pinhole	52"	7 ft. Lift (3-Pt.Hitch)	BYPY 6

### •ROTARY CUTTER/TILLER•

<u>STOCK #</u>	<u>TRACTOR YOKE</u>	<u>IMPLEMENT CLAMP YOKE</u>	<u>OAL COMPRESSED</u>	<u>APPLICATION</u>	<u>SERIES</u>
14106233	1 3/8" x 6 Spl. QD	1 3/8" x 6 Spl. w/Fric. Clutch	33"	Pull (Towed)	BYPY 2
14106436	1 3/8" x 6 Spl. QD	1 3/8" x 6 Spl. w/Fric. Clutch	36"	Pull (Towed)	BYPY 4
14106438	1 3/8" x 6 Spl. QD	1 3/8" x 6 Spl. w/Fric. Clutch	38"	Pull (Towed)	BYPY 4
14106546	1 3/8" x 6 Spl. QD	1 3/8" x 6 Spl. w/Fric. Clutch	46"	Pull (Towed)	BYPY 5
14106654	1 3/8" x 6 Spl. QD	1 3/8" x 6 Spl. w/Fric. Clutch	54"	7 ft. Lift (3-Pt.Hitch)	BYPY 6
14106660	1 3/8" x 6 Spl. QD	1 3/4" x 20 Spl. w/Fric. Clutch	60"	7 ft. Lift (3-Pt.Hitch)	BYPY 6
14106661	1 3/4" x 20 Spl. QD	1 3/4" x 20 Spl. w/Fric. Clutch	61"	7 ft. Lift (3-Pt.Hitch)	BYPY 6



## NORTH AMERICAN DRIVELINES

### •ALL PURPOSE•

<u>STOCK #</u>	<u>TRACTOR YOKE</u>	<u>IMPLEMENT YOKE</u>	<u>OAL COMPRESSED</u>	<u>SERIES</u>
14000605	1 3/8" x 6 Spl. Spring Lok	1" Rd. w/Pinhole	32"	6R
14000638	1 3/8" x 6 Spl. QD	1" Rd. w/Pinhole	38"	6R
14003536	1 3/8" x 6 Spl. SSL	1 3/8" x 6 Spl. SSL	36"	35R
14005537	1 3/8" x 6 Spl. SSL	1 3/8" x 6 Spl. SSL	37"	55R
14005546	1 3/4" x 20 Spl. SSL	1 3/4" Rd. w/Keyway & 2 Set Screws	46"	55R

### •AUGER•

<u>STOCK #</u>	<u>TRACTOR YOKE</u>	<u>IMPLEMENT YOKE</u>	<u>OAL COMPRESSED</u>	<u>SERIES</u>
14000616	1 3/8" x 6 Spl. Spring Lok	1" Rd. w/Keyway	48"	6R
14001220	1 3/8" x 6 Spl. Spring Lok	1 1/4" Rd. w/Keyway	48"	12R
14001420	1 3/8" x 6 Spl. Spring Lok	1 1/4" Rd. w/Keyway	48"	14R

### •CATFISH POND DRIVELINE•

<u>STOCK #</u>	<u>TRACTOR YOKE</u>	<u>IMPLEMENT YOKE</u>	<u>OAL COMPRESSED</u>	<u>SERIES</u>
14003524	1 3/8" x 6 Spl. QD	1 1/2" Rd. w/Keyway	48"	35R
14004424	1 3/8" x 6 Spl. QD	1 1/2" Rd. w/Keyway	48"	44R

### •FERTILIZER SPREADER•

<u>STOCK #</u>	<u>TRACTOR YOKE</u>	<u>IMPLEMENT YOKE</u>	<u>OAL COMPRESSED</u>	<u>SERIES</u>
14000620	1 3/8" x 6 Spl. Spring Lok	1 3/8" x 6 Spl. Spring Lok	27"	6R

### •FINISHING MOWER•

<u>STOCK #</u>	<u>TRACTOR YOKE</u>	<u>IMPLEMENT YOKE</u>	<u>OAL COMPRESSED</u>	<u>SERIES</u>
14000600	1 3/8" x 6 Spl. Spring Lok	1" Rd. w/Pinhole	39"	6R

### •POSTHOLE DIGGER•

<u>STOCK #</u>	<u>TRACTOR YOKE</u>	<u>IMPLEMENT YOKE</u>	<u>OAL COMPRESSED</u>	<u>SERIES</u>
14001200	1 3/8" x 6 Spl. QD	1 1/4" Rd. w/Keyway	48"	12R

### •ROTARY CUTTER•

<u>STOCK #</u>	<u>TRACTOR YOKE</u>	<u>IMPLEMENT YOKE</u>	<u>APPLICATION</u>	<u>OAL COMPRESSED</u>	<u>SERIES</u>
14001404	1 3/8" x 6 SSL	1 3/8" Rd. w/Pinhole	4 Ft. Lift-type	30"	14R
14001405	1 3/8" x 6 SSL	1 3/8" Rd. w/Pinhole	5 Ft. Lift-type	37"	14R
14001406	1 3/8" x 6 SSL	1 3/8" Rd. w/Pinhole	5 Ft. & 6 Ft. Pull-type	56"	14R
14003507	1 3/8" x 6 SSL	1 3/8" Rd. w/Pinhole	7 Ft. Pull-type	65"	35R

# AFTERMARKET REPLACEMENT DRIVELINES

## CONSTANT VELOCITY - NORTH AMERICAN

ORDER IMPLEMENT YOKE AND CROSS AND BEARING KIT SEPARATELY AS REQUIRED

### •80° CV CATEGORY 3 / 14 SERIES•

STOCK #	TRACTOR YOKE	OAL COMPRESSED	MAX. EXTENDED OPERATING LENGTH	SHAFT SIZE
14501448	1 3/8" x 6 Spl. SSL	48"	67"	1" x 1-1/8"
14501458	1 3/8" x 6 Spl. SSL	58"	77"	1" x 1-1/8"
14501467	1 3/8" x 6 Spl. SSL	67"	86"	1" x 1-1/8"
14601448	1 3/8" x 21 Spl. SSL	48"	67"	1" x 1-1/8"
14601458	1 3/8" x 21 Spl. SSL	58"	77"	1" x 1-1/8"
14601467	1 3/8" x 21 Spl. SSL	67"	86"	1" x 1-1/8"

#### DRIVELINE TRACTOR HALF ASSEMBLY

STOCK#	TRACTOR YOKE	SERIES
19501406	1 3/8" x 6 Spl.	14R
19601421	1 3/8" x 21 Spl.	14R

#### DRIVELINE MACHINE HALF ASSEMBLY

STOCK #	OVERALL DRIVELINE LENGTH	SERIES
17501448	48"	14R
17501458	58"	14R
17501467	67"	14R

### •80° CV CATEGORY 4 / 35 SERIES•

STOCK #	TRACTOR YOKE	OAL COMPRESSED	MAX. EXTENDED OPERATING LENGTH	SHAFT SIZE
14513548	1 3/8" x 6 Spl. SSL	48"	67"	1 5/16" x 20 Spl.
14513558	1 3/8" x 6 Spl. SSL	58"	77"	1 5/16" x 20 Spl.
14513567	1 3/8" x 6 Spl. SSL	67"	84"	1 5/16" x 20 Spl.
14513573	1 3/8" x 6 Spl. SSL	73"	92"	1 5/16" x 20 Spl.
14613548	1 3/8" x 21 Spl. SSL	48"	67"	1 5/16" x 20 Spl.
14613558	1 3/8" x 21 Spl. SSL	58"	77"	1 5/16" x 20 Spl.
14613567	1 3/8" x 21 Spl. SSL	67"	84"	1 5/16" x 20 Spl.
14613573	1 3/8" x 21 Spl. SSL	73"	92"	1 5/16" x 20 Spl.
14713548	1 3/4" x 20 Spl. SSL	48"	67"	1 5/16" x 20 Spl.
14713558	1 3/4" x 20 Spl. SSL	58"	77"	1 5/16" x 20 Spl.
14713567	1 3/4" x 20 Spl. SSL	67"	84"	1 5/16" x 20 Spl.
14713573	1 3/4" x 20 Spl. SSL	73"	92"	1 5/16" x 20 Spl.

REPLACEMENT  
DRIVELINES

#### DRIVELINE TRACTOR HALF ASSEMBLY

STOCK#	TRACTOR YOKE	SERIES
19503540	1 3/8" x 6 Spl.	35R
19603540	1 3/8" x 21 Spl.	35R
19703540	1 3/4" x 20 Spl.	35R

#### DRIVELINE MACHINE HALF ASSEMBLY

STOCK #	OVERALL DRIVELINE LENGTH	SERIES
17513548	48"	35R
17513558	58"	35R
17513567	67"	35R
17513573	73"	35R
17513579	79"	35R



## CONSTANT VELOCITY - NORTH AMERICAN...continued

ORDER IMPLEMENT YOKE AND CROSS AND BEARING KIT SEPARATELY AS REQUIRED

### •80° CV CATEGORY 5 / 35/44 SERIES•

STOCK #	TRACTOR YOKE	OAL COMPRESSED	MAX. EXTENDED OPERATING LENGTH	SHAFT SIZE
14503548	1 3/8" x 6 Spl. SSL	48"	67"	1 11/16" x 20 Spl.
14503558	1 3/8" x 6 Spl. SSL	58"	77"	1 11/16" x 20 Spl.
14503567	1 3/8" x 6 Spl. SSL	67"	84"	1 11/16" x 20 Spl.
14503573	1 3/8" x 6 Spl. SSL	73"	92"	1 11/16" x 20 Spl.
14503579	1 3/8" x 6 Spl. SSL	79"	96"	1 11/16" x 20 Spl.
14504448	1 3/8" x 6 Spl. SSL	48"	67"	1 11/16" x 20 Spl.
14504458	1 3/8" x 6 Spl. SSL	58"	77"	1 11/16" x 20 Spl.
14504467	1 3/8" x 6 Spl. SSL	67"	84"	1 11/16" x 20 Spl.
14504473	1 3/8" x 6 Spl. SSL	73"	92"	1 11/16" x 20 Spl.
14504479	1 3/8" x 6 Spl. SSL	79"	96"	1 11/16" x 20 Spl.
14603548	1 3/8" x 21 Spl. SSL	48"	67"	1 11/16" x 20 Spl.
14603558	1 3/8" x 21 Spl. SSL	58"	77"	1 11/16" x 20 Spl.
14603567	1 3/8" x 21 Spl. SSL	67"	84"	1 11/16" x 20 Spl.
14603573	1 3/8" x 21 Spl. SSL	73"	92"	1 11/16" x 20 Spl.
14603579	1 3/8" x 21 Spl. SSL	79"	96"	1 11/16" x 20 Spl.
14604448	1 3/8" x 21 Spl. SSL	48"	67"	1 11/16" x 20 Spl.
14604458	1 3/8" x 21 Spl. SSL	58"	77"	1 11/16" x 20 Spl.
14604467	1 3/8" x 21 Spl. SSL	67"	84"	1 11/16" x 20 Spl.
14604473	1 3/8" x 21 Spl. SSL	73"	92"	1 11/16" x 20 Spl.
14604479	1 3/8" x 21 Spl. SSL	79"	96"	1 11/16" x 20 Spl.
14703548	1 3/4" x 20 Spl. SSL	48"	67"	1 11/16" x 20 Spl.
14703558	1 3/4" x 20 Spl. SSL	58"	77"	1 11/16" x 20 Spl.
14703567	1 3/4" x 20 Spl. SSL	67"	84"	1 11/16" x 20 Spl.
14703573	1 3/4" x 20 Spl. SSL	73"	92"	1 11/16" x 20 Spl.
14703579	1 3/4" x 20 Spl. SSL	79"	96"	1 11/16" x 20 Spl.
14704448	1 3/4" x 20 Spl. SSL	48"	67"	1 11/16" x 20 Spl.
14704458	1 3/4" x 20 Spl. SSL	58"	77"	1 11/16" x 20 Spl.
14704467	1 3/4" x 20 Spl. SSL	67"	84"	1 11/16" x 20 Spl.
14704473	1 3/4" x 20 Spl. SSL	73"	92"	1 11/16" x 20 Spl.
14704479	1 3/4" x 20 Spl. SSL	79"	96"	1 11/16" x 20 Spl.

REPLACEMENT DRIVELINES

### DRIVELINE TRACTOR HALF ASSEMBLY

STOCK#	TRACTOR YOKE	SERIES
19503506	1 3/8" x 6 Spl.	35R
19603521	1 3/8" x 21 Spl.	35R
19703520	1 3/4" x 20 Spl.	35R

### DRIVELINE MACHINE HALF ASSEMBLY

STOCK #	OVERALL DRIVELINE LENGTH	SERIES
17503548	48"	35R
17503558	58"	35R
17503567	67"	35R
17503573	73"	35R
17503579	79"	35R
17504448	48"	44R
17504458	58"	44R
17504467	67"	44R
17504473	73"	44R
17504479	79"	44R

# AFTERMARKET REPLACEMENT DRIVELINES

## CONSTANT VELOCITY - NORTH AMERICAN...continued

ORDER IMPLEMENT YOKE AND CROSS AND BEARING KIT SEPARATELY AS REQUIRED

### •80° CV CATEGORY 6 / 55 SERIES•

<u>STOCK #</u>	<u>TRACTOR YOKE</u>	<u>OAL COMPRESSED</u>	<u>MAX. EXTENDED OPERATING LENGTH</u>	<u>SHAFT SIZE</u>
14505548	1 3/8" x 6 Spl. SSL	48"	67"	1 11/16" x 20 Spl.
14505558	1 3/8" x 6 Spl. SSL	58"	80"	1 11/16" x 20 Spl.
14505567	1 3/8" x 6 Spl. SSL	67"	84"	1 11/16" x 20 Spl.
14505573	1 3/8" x 6 Spl. SSL	73"	92"	1 11/16" x 20 Spl.
14505579	1 3/8" x 6 Spl. SSL	79"	96"	1 11/16" x 20 Spl.
14605548	1 3/8" x 21 Spl. SSL	48"	67"	1 11/16" x 20 Spl.
14605558	1 3/8" x 21 Spl. SSL	58"	80"	1 11/16" x 20 Spl.
14605567	1 3/8" x 21 Spl. SSL	67"	84"	1 11/16" x 20 Spl.
14605573	1 3/8" x 21 Spl. SSL	73"	92"	1 11/16" x 20 Spl.
14605579	1 3/8" x 21 Spl. SSL	79"	96"	1 11/16" x 20 Spl.
14705548	1 3/4" x 20 Spl. SSL	48"	67"	1 11/16" x 20 Spl.
14705558	1 3/4" x 20 Spl. SSL	58"	80"	1 11/16" x 20 Spl.
14705567	1 3/4" x 20 Spl. SSL	67"	84"	1 11/16" x 20 Spl.
14705573	1 3/4" x 20 Spl. SSL	73"	92"	1 11/16" x 20 Spl.
14705579	1 3/4" x 20 Spl. SSL	79"	96"	1 11/16" x 20 Spl.

### DRIVELINE TRACTOR HALF ASSEMBLY

<u>STOCK#</u>	<u>TRACTOR YOKE</u>	<u>SERIES</u>
19505506	1 3/8" x 6 Spl.	55R
19605521	1 3/8" x 21 Spl.	55R
19705520	1 3/4" x 20 Spl.	55R

### DRIVELINE MACHINE HALF ASSEMBLY

<u>STOCK #</u>	<u>OVERALL DRIVELINE LENGTH</u>	<u>SERIES</u>
17505548	48"	55R
17505558	58"	55R
17505567	67"	55R
17505573	73"	55R
17505579	79"	55R

REPLACEMENT  
DRIVELINES

# N O T E S