



**Weasler®**

*AFTERMARKET  
PRODUCT GUIDE*

***NORTH AMERICAN  
DRIVELINES & COMPONENTS***

***N.A. DRIVELINE  
& COMPONENTS***

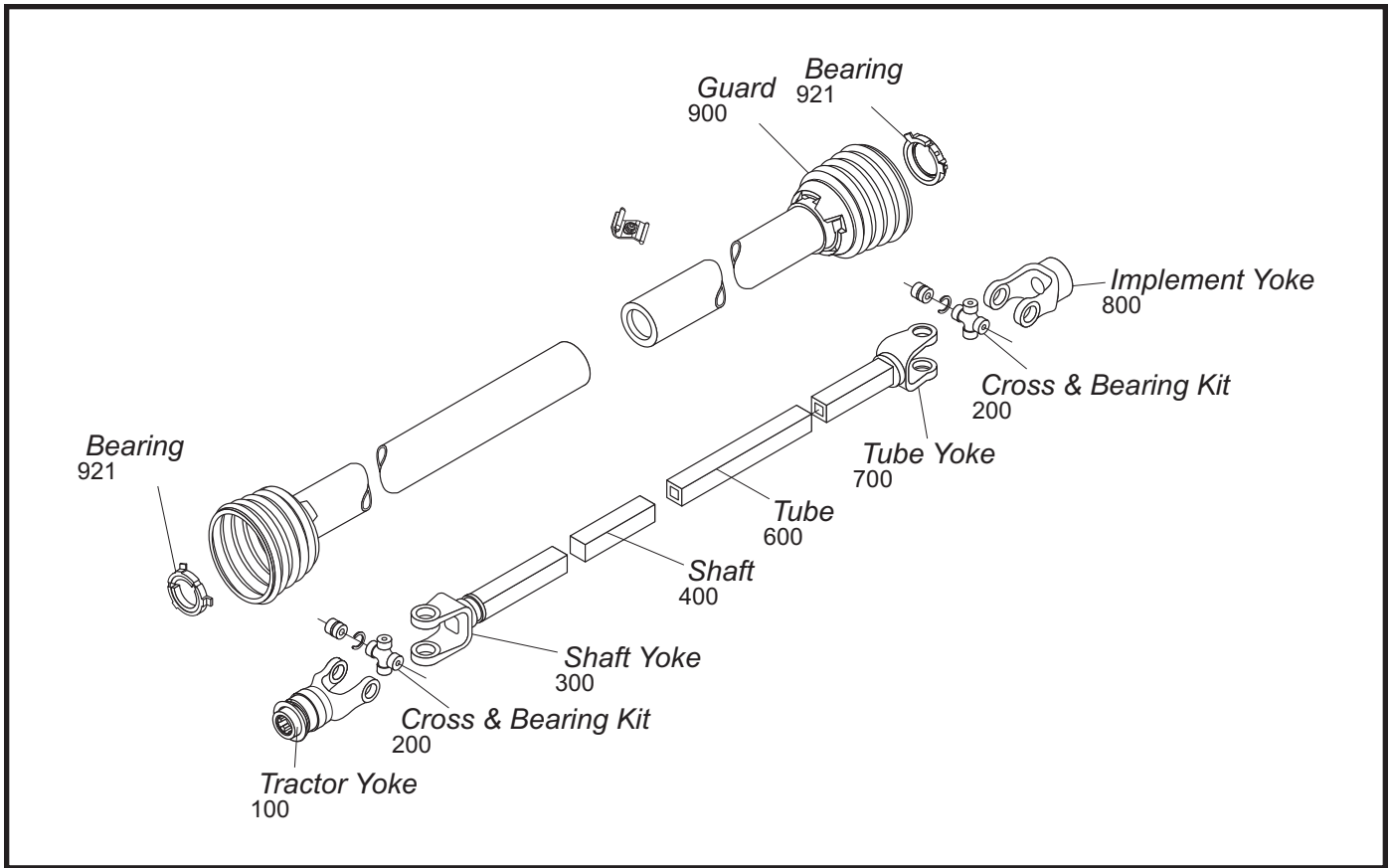

Each series has an exploded view for identification purposes. The drawing illustrates the components in the same sequence as an implement input driveline transmitting power from tractor to implement. Each component of the exploded view is identified by an eight digit stock number to insure correct identification of each component.

Example: 100 prefix denotes a Spring-Lok Tractor Yoke on the exploded view.

[When ordering a tractor yoke, be sure the stock number begins with 100.]

**Number Identification Examples:**

102 - 06 06  
 6 Spline  
 6 Series  
 QD Yoke  
 Tractor Yoke

200 - 06 00  
 6 Series  
 Cross & Bearing Kit

300 - 12 00  
 12 Series  
 Shaft Weld Yoke

400 - 16 - 18  
 \*1 1/8"  
 \*1"  
 Shaft

500 - 35 00  
 35 Series  
 Slip Sleeve

602 - 44 00  
 44 Series  
 Tube

701 - 44 00  
 44 Series  
 Tube Weld Yoke

800 - 35 24  
 \*1 1/2" Round Bore  
 35 Series  
 Implement Yoke

900 - 45 48  
 For 48" O.A. Driveline  
 Guard Type  
 Plastic Guard

(\* Expressed in 1/16th inches)

# TRANSPARENCY IDENTIFICATION SYSTEM

for Driveline Components  
(Stock No. 12002500)

The individual transparency cards will allow the user to easily identify driveline components. Cross and Bearing Kits may be identified by the bearing cap outside diameter and the width of the cross. Yokes may be identified by the hole in the ear and profile. Tubes and shafts may be identified by the end sections.

How to use the Transparency Identification System:

1. Match the part to be replaced with the corresponding transparency card for identification.
2. Select the proper stock number for the replacement part.

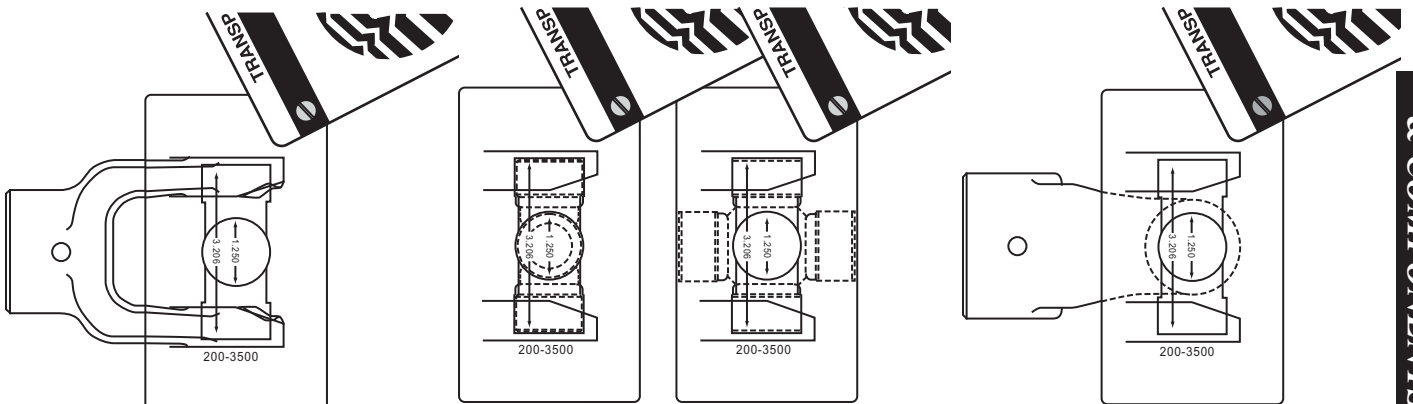
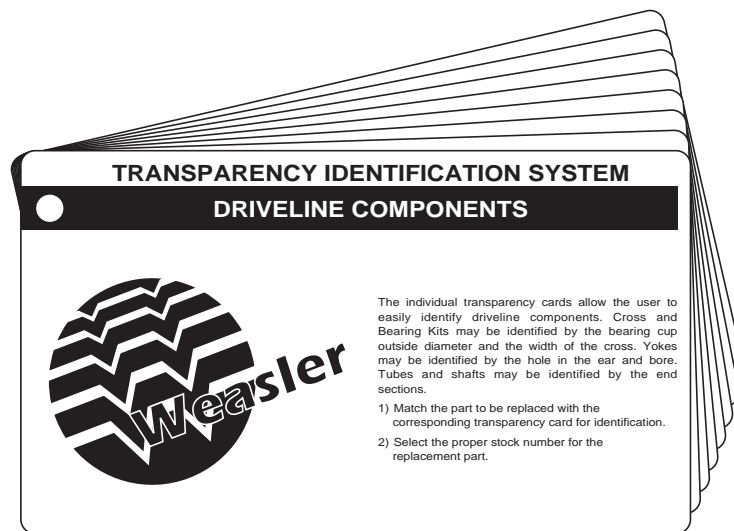

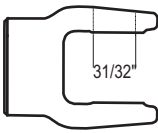

# 6 Series

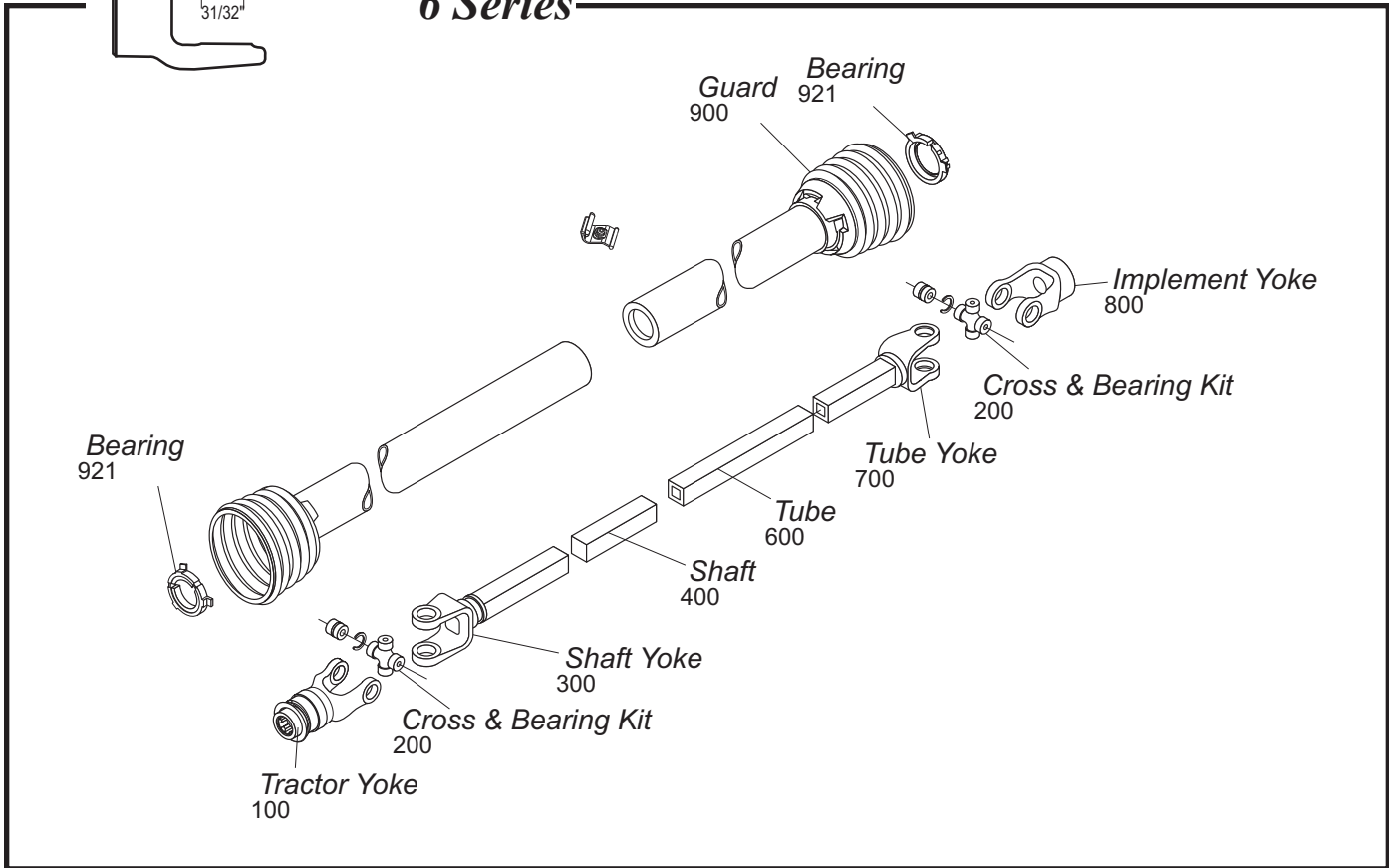

## Tractor Yoke

### Spring-Lok

Repair Kit — Page 81

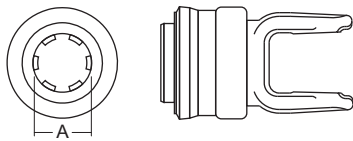

Stock Number	Dim. "A" Bore
100-0606	1 3/8" x 6 Spl.
100-0621	1 3/8" x 21 Spl.

### Spring-Lok (metal collar)

Lawn & Garden  
Repair Kit — Page 81

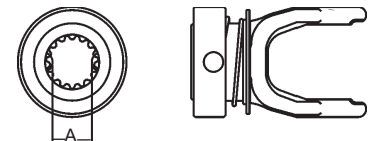

Stock Number	Dim. "A" Bore
105-0610	.98" x 10 Spl.
105-0615	1" x 15 Spl.

### Auto-Lok

Repair Kit — Page 81

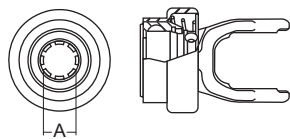

Stock Number	Dim. "A" Bore
101-0610	.981" x 10 Spl.
101-0615	1" x 15 Spl.

### Male Spline

Lawn & Garden

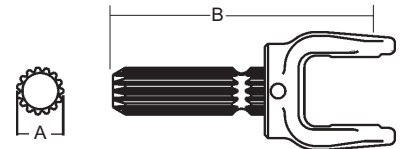

Stock Number	Dim. "A"	Dim. "B"
106-0615	1" x 15 Spl.	5.38

### Quick Disconnect

Repair Kit — Page 81

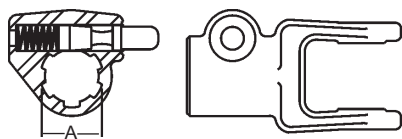

Stock Number	Dim. "A" Bore
102-0606	1 3/8" x 6 Spl.
102-0621	1 3/8" x 21 Spl.

### Cross & Bearing Kit (R-Kit)

Snap Ring Located in Bushing

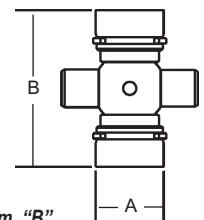

Stock Number	Dim. "A"	Dim. "B"
200-0600	31/32"	2 9/32"

**Extended Lubrication Cross & Bearing Kit (E-Kit)**

Snap Ring Located in Bushing

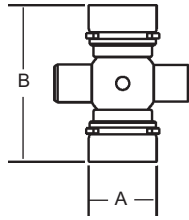

Stock Number	Dim. "A"	Dim. "B"
201-0600	3 1/32"	2 9/32"

**Shaft Weld Yoke**

With Bearing Groove  
(Guard must rotate freely on yoke)

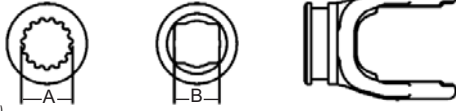

Stock Number	Dim. "A" Bore	Dim. "B" Bore	
300-0600		3/4" x 7/8"	(2 1/2" CL)
302-0600	1" x 15 Spl.		
303-0600		3/4" x 7/8"	(2 1/4" CL)

Without Bearing Groove



Stock Number	Dim. "A" Bore
301-0600	1" x 15 Spl.

**Shaft**

3/4" x 7/8" Rectangular

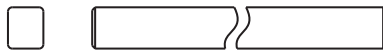

Stock Number	Length
400-1214	6'
401-1214	10'
404-1214	3'

1" x 15 Spline  
(Induction Hardened)



Stock Number	Length
404-1615H	3'

**Slip Sleeve**

With Grease Groove

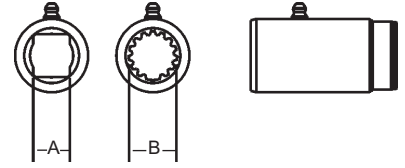

Stock Number	Length	Dim. "A" Bore	Dim. "B" Bore	Fits Tube Size
510-0600	4"	3/4" x 7/8" Rect		1 1/2" (.065 Wall)
510-0615	3"		1" x 15 Spl.	1 1/2" (.065 Wall)

**Tube**



1" x 1 1/8" Rectangular O.D.

Stock Number	Length	Fits Shaft
600-1618	6'	3/4" x 7/8"
601-1618	10'	3/4" x 7/8"
604-1618	3'	3/4" x 7/8"

1 1/2" Round (.065 Wall) O.D.



Stock Number	Length
602-0600	6'
604-0600	3'

**Tube Weld Yoke**

With Bearing Groove  
(Guard must rotate freely on yoke)

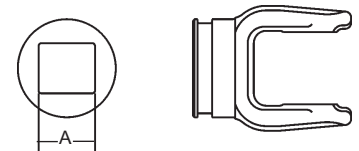

Stock Number	Dim. "A" Bore	Fits Tube Size
700-0600	1" x 1 1/8"	
701-0600		1 1/2" (.065 Wall)

(Guard must rotate freely on yoke)

Stock Number	Fits Tube Size
702-0600 (without Bearing Groove)	1 1/2" (.065 Wall)
703-0600 (with Groove)	1 1/2" (.065 Wall)

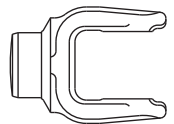

# 6 Series (cont'd.)

## Implement Yoke

### Round Bore

With Keyway & Set Screw

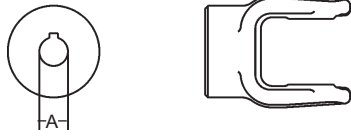

Stock Number	Dim. "A" Bore	Standard Keyway
800-0610	5/8"	3/16"
800-0612	3/4"	3/16"
800-0613	13/16"	3/16"
800-0614	7/8"	3/16"
800-0615	15/16"	1/4"
800-0616	1"	1/4"
800-0618	1 1/8"	1/4"
800-0619	1 3/16"	1/4"
800-0620	1 1/4"	1/4"

### Square Bore

With Set Screw

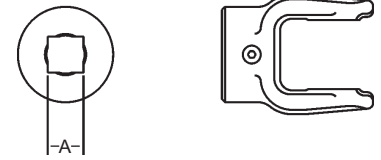

Stock Number	Dim. "A" Bore
804-0612	3/4"
804-0614	7/8"
804-0616	1"
804-0618	1 1/8"
804-0620	1 1/4"

### Spline Bore

With 1/4" Pin Hole

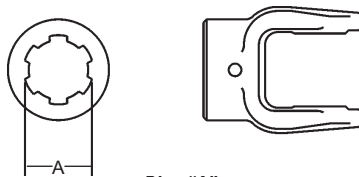

Stock Number	Dim. "A" Bore
801-0606	1 3/8" x 6 Spl.
801-0618	1 1/8" x 6 Spl.

### Round Bore

Double Keyway & Set Screw

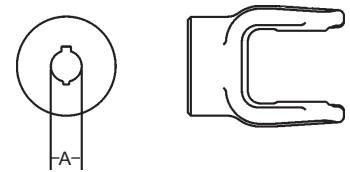

Stock Number	Dim. "A" Bore	Double Keyway
806-0612	3/4"	3/16" & 1/4"
806-0613	13/16"	3/16" & 1/4"
806-0614	7/8"	3/16" & 1/4"
806-0616	1"	3/16" & 1/4"
806-0618	1 1/8"	1/4" & 5/16"
806-0619	1 3/16"	1/4" & 5/16"
806-0620	1 1/4"	1/4" & 5/16"

### Shear Pin

With 1/4" Pin Hole

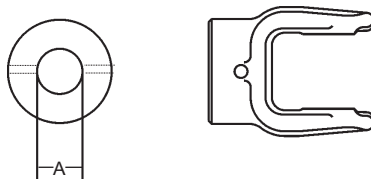

Stock Number	Dim. "A" Bore
802-0616	1"
802-0618	1 1/8"
802-0620	1 1/4"

### Clamp Yoke

With Bolt Hole & Set Screw

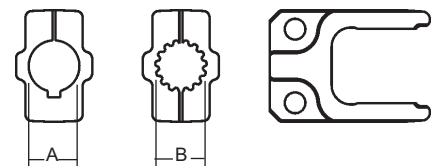

Stock Number	Dim "A" Bore	Dim "B" Bore	Keyway
807-0614	7/8"		3/16"
807-0615		1" x 15 Spl.	
807-0616	1"		1/4"

### Stock Bore

With Hub O. D. Turned



Stock Number	Dim "A" Bore
809-0608	1/2"

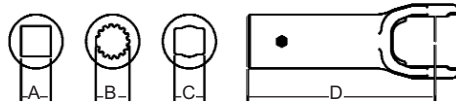

**Slip Sleeve Yoke**

Stock Number	Dim. "A" Bore	Dim. "B" Bore	Dim. "C" Bore	Dim "D" Length
808-0612	3/4" Sq.			5 1/2"
808-0614	7/8" Sq.			5 1/2"
812-0615		1" x 15 Spl.		5 1/2"
813-0600			3/4" x 7/8" Rect.	5 1/2"

**Yoke & Tube Assembly**

1" x 1 1/8" Tube

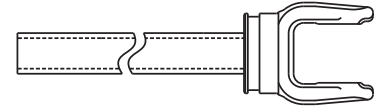

Stock Number	Fits Shaft	Centerline to End of Tube Dimension
11000648	3/4" x 7/8"	38.75"

**Yoke & Shaft Assembly**

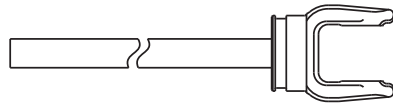

Stock Number	Shaft Size	Centerline to End of Shaft Dimension
10000610	1" x 15 Spl.	12.50"
10000648	3/4" x 7/8"	38.75"

**Guard**

Order Bearings As Required

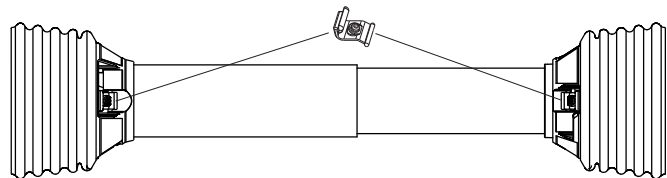

Stock Number	Overall Driveline Length	Bearing Kit (4-per kit)
900-2548	48"	921-0600
900-2560	60"	921-0600

Assembly instructions included with guard

Note: When installing Guards observe the following:

- 1) Install proper nylon bearing (See Page 13)
- 2) Guards must rotate freely on yokes

**Easy Lock™ Replacement Kit**

Part Number: 13005000 (4-per Kit)



# 6 Series (cont'd.)

## Universal Joints



### Round To Round

Furnished with Keyway & Set Screw

Stock Number	Dim. "A" Bore
15120612	3/4"
15160616	1"

## Drivelines

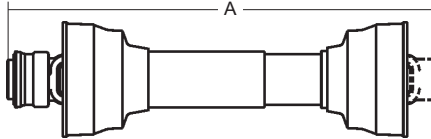

Drivelines are furnished without Cross & Bearing Kit and Implement Yoke. Select kit and Implement Yoke as required. When Cross & Bearing Kit and Implement Yoke are assembled, the overall compressed length of the driveline will be 48".

Stock Number	Tractor Yoke	Overall Compressed Length Dim. "A"
14000648	1 3/8" x 6 Spl. Spring Lok	48"

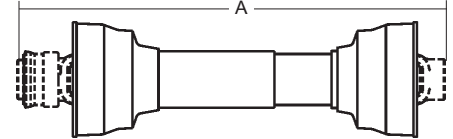

Drivelines are furnished without Cross & Bearing Kit and Outboard Yokes. Select kit and outboard yokes as required. When cross & bearing kit and outboard yokes are assembled, the overall compressed length of the driveline will be 48".

Stock Number	Overall Compressed Length Dim. "A"
14010648	48"

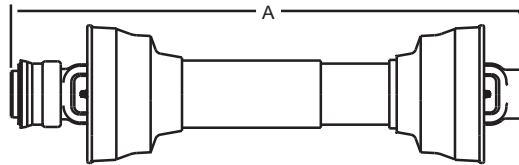

Stock Number	Tractor Yoke	Implement Yoke	Overall Compressed Length Dim. "A"	Application
14000600	1 3/8" x 6 Spl. Spring Lok	1" Round with 1/2" Pin Hole	39"	Finishing Mower
14000605	1 3/8" x 6 Spl. Spring Lok	1" Round with 5/16" Pin Hole	39"	All Purpose
14000616	1 3/8" x 6 Spl. Spring Lok	1" Round 1/4" Keyway	48"	Auger
14000620	1 3/8" x 6 Spl. Spring Lok	1 3/8" x 6 Spl. Spring Lok	27 1/4"	Fertilizer Spreader
14000638	1 3/8" x 6 Spl. Q.D.	1" Round with Pinhole	38"	All Purpose

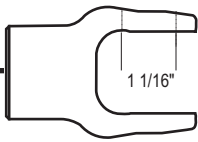

# 12 Series

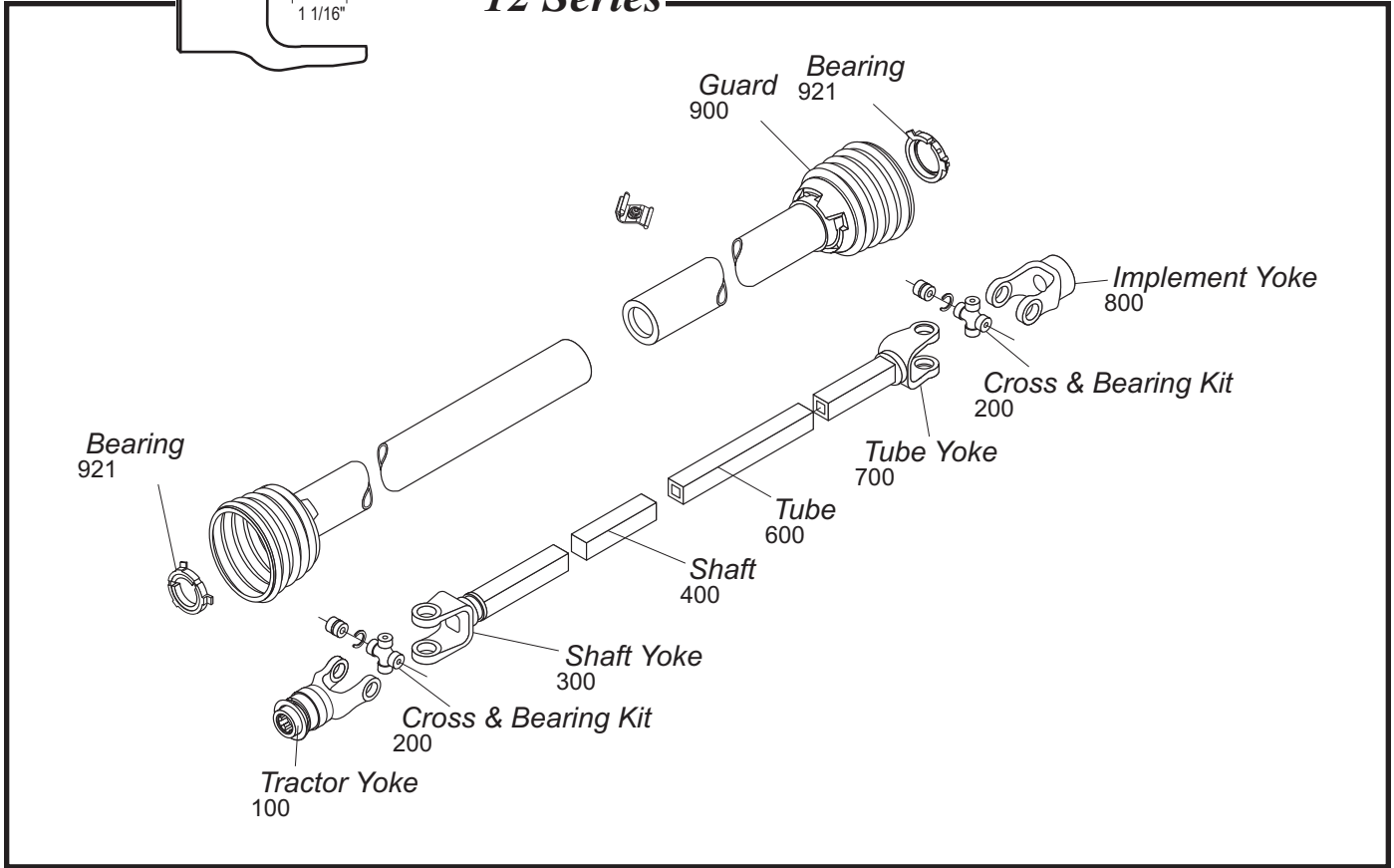

## Tractor Yoke

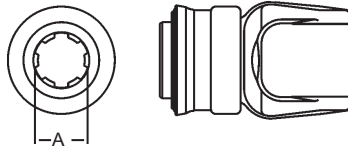

**Spring-Lok**  
Repair Kit — Page 81

Stock Number	Dim. "A" Bore
100-1206	1 3/8" x 6 Spl.
100-1221	1 3/8" x 21 Spl.

**Ball Shear Device**  
With Spring-Lok  
Repair Kit — Page 81

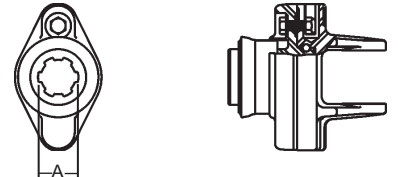

Stock Number	Dim. "A" Bore	Shear Bolt
104-1206	1 3/8" x 6 Spl.	5/16" - 18 Gr. 5
104-1221	1 3/8" x 21 Spl.	5/16" - 18 Gr. 5

**Quick Disconnect**  
Repair Kit — Page 81

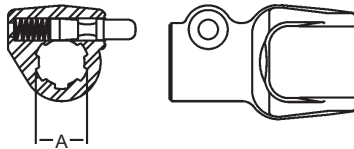

Stock Number	Dim. "A" Bore
102-1206	1 3/8" x 6 Spl.
102-1221	1 3/8" x 21 Spl.

## Cross & Bearing Kit (R-Kit)

Snap Ring Located in Bushing

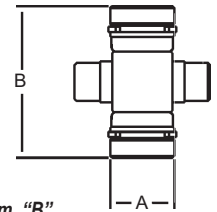

Stock Number	Dim. "A"	Dim. "B"
200-1200	1 1/16"	2 1/2"

## Extended Lubrication Cross & Bearing Kit (E-Kit)

Snap Ring Located in Bushing

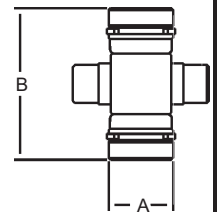

Stock Number	Dim. "A"	Dim. "B"
201-1200	1 1/16"	2 1/2"

# 12 Series (cont'd.)

## Shaft Weld Yoke

With Bearing Groove  
(Guard must rotate freely on yoke)



Stock Number	Dim. "A" Bore
300-1200	1" x 1 1/8"
301-1200	15/16" Sq.

## Tube Weld Yoke

With Bearing Groove  
(Guard must rotate freely on yoke)

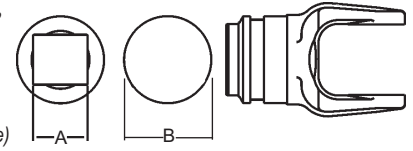

Stock Number	Dim. "A" Bore	Dim. "B" Fits Tube Size
700-1200	1 1/4" x 1 3/8"	
701-1200		2" (.083 Wall)
702-1200		15/16" Sq.

## Shaft



1" x 1 1/8" Rectangular

Stock Number	Length
400-1618	6'
401-1618	10'
404-1618	3'

## Implement Yoke

Round Bore  
With Keyway & Set Screw

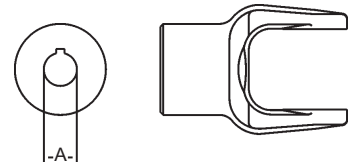

Stock Number	Dim. "A" Bore	Standard Keyway
800-1212	3/4"	3/16"
800-1214	7/8"	3/16"
800-1215	15/16"	1/4"
800-1216	1"	1/4"
800-1218	1 1/8"	1/4"
800-1219	1 3/16"	1/4"
800-1220	1 1/4"	1/4"
800-1222	1 3/8"	5/16"
800-1224	1 1/2"	3/8"

## Slip Sleeve

With Grease Groove

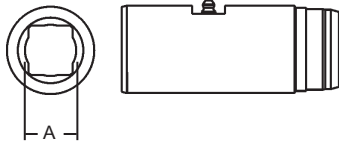

Stock Number	Dim. "A" Bore	Length	Fits Tube Size
500-1400	1" x 1 1/8" Rect.	5"	2" (.083 Wall)

## Tube

1 1/4" x 1 3/8"  
Rectangular O.D.



Stock Number	Length	Fits Shaft
600-2022	6'	1" x 1 1/8"
601-2022	10'	1" x 1 1/8"
604-2022	3'	1" x 1 1/8"

## Spline Bore

With 21/64" Pin Hole

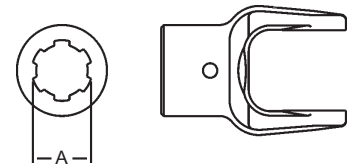

Stock Number	Dim. "A" Bore
801-1206	1 3/8" x 6 Spl.
801-1210*	1 3/16" x 10 Spl.
801-1213	.90" x 13 Spl. w/Set Screw
801-1218	1 1/8" x 6 Spl.
801-1221	1 3/8" x 21 Spl.

\*No Pin Hole

2" (.083 Wall)



Stock Number	Length
602-1400	6'
603-1400	10'
604-1400	3'

## Shear Pin

With 1/4" Pin Hole

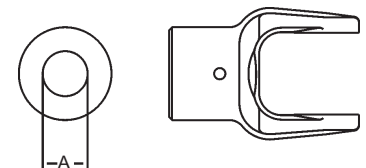

Stock Number	Dim. "A" Bore
802-1216	1"
802-1218	1 1/8"
802-1220	1 1/4"
802-1222	1 3/8"

**Square Bore**  
With Set Screw

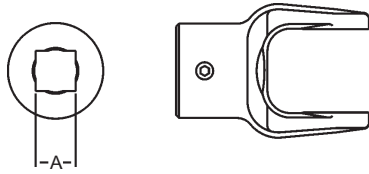

Stock Number	Dim. "A" Bore
804-1214	7/8"
804-1216	1"
804-1218	1 1/8"
804-1220	1 1/4"

**Slip Yoke**

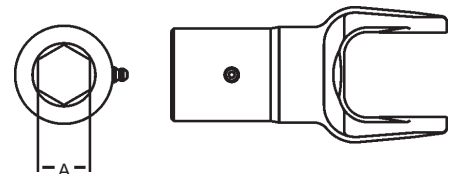

Stock Number	Dim. "A" Bore
808-1216	1" Sq.
810-1216	1" Rd. w/1/4" Keyway
810-1218	1 1/8" Rd. w/5/16" Keyway
811-1218	1 1/8" Hex

**Hexagon Bore**  
With Set Screw

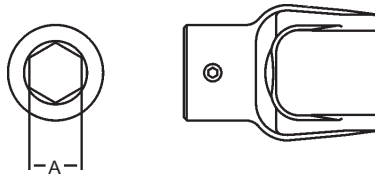

Stock Number	Dim. "A" Bore
805-1218	1 1/8"

**Yoke & Shaft Assembly**

1" x 1 1/8"  
Rectangular Shaft

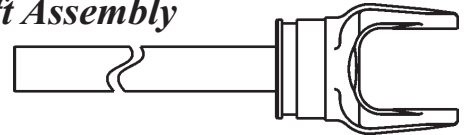

Stock Number	Centerline to End of Shaft Dimension
10001248	37.38"
10001260	49.38"

**Round Bore**  
Double Keyway & Set Screw

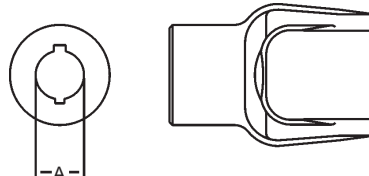

Stock Number	Dim. "A" Bore	Double Keyway
806-1216	1"	1/4" & 3/16"
806-1218	1 1/8"	1/4" & 5/16"
806-1220	1 1/4"	1/4" & 5/16"

**Yoke & Tube Assembly**

1 1/4" x 1 3/8" Tube

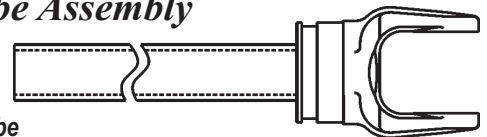

Stock Number	Fits Shaft	Centerline to End of Tube Dimension
11001248	1" x 1 1/8"	37.38"
11001260	1" x 1 1/8"	49.38"

**Stock Bore**  
With Hub O.D. Turned

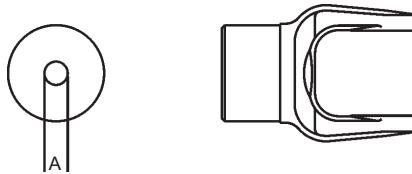

Stock Number	Dim. "A" Bore
809-1208	1/2"

**Guard**

Order Bearings As Required

Stock Number	Overall Driveline Length	Bearing Kit (4-per kit)
900-2548	48"	921-1200
900-2560	60"	921-1200

Assembly instructions included with guard

Note: When installing Guards observe the following:

- 1) Install proper nylon bearing (See Page 13)
- 2) Guards must rotate freely on yokes

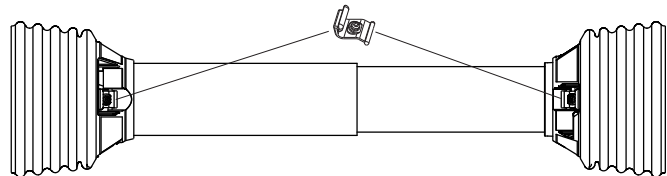

**Easy Lock™ Replacement Kit**

Part Number: 13005000 (4-per Kit)



# 12 Series (cont'd.)

## Universal Joint



### Spring Lok to Shaft Weld Yoke

Repair Kit — Page 81

Stock Number	Dim. "A" Bore	Dim. "B" Bore
15061200	1 3/8" x 6 Spl.	1" x 1 1/8" Rect.

## Drivelines

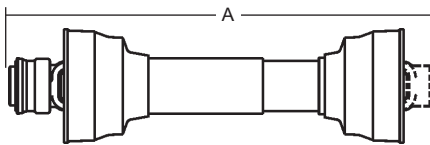

Drivelines are furnished without Cross & Bearing Kit and Implement Yoke. Select kit and implement yoke as required. When Cross & Bearing Kit and Implement Yoke are assembled, the overall compressed length of the driveline will be 48" or 60".

Stock Number	Tractor Yoke	Overall Compressed Length Dim. "A"
14001248	1 3/8" x 6 Spl. Spring-Lok	48"
14001260	1 3/8" x 6 Spl. Spring-Lok	60"

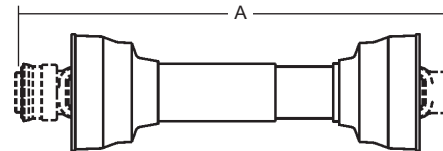

Drivelines are furnished without Cross & Bearing Kit and Outboard Yokes. Select kit and outboard yokes as required. When cross & bearing kit and outboard Yokes are assembled, the overall compressed length of the driveline will be 48" or 60".

Stock Number	Overall Compressed Length Dim. "A"
14011248	48"
14011260	60"
14021248 (With crosses installed)	48"
14031248 (With 15/16" Sq. Shaft)	48"

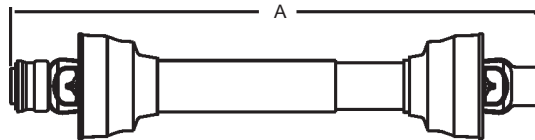

Stock Number	Tractor Yoke	Implement Yoke	Overall Compressed Length Dim. "A"	Application
14001200	1 3/8" x 6 Spl Q.D.	1 1/4" Rd 1/4" Keyway	48"	Post Hole Digger
14001220	1 3/8" x 6 Spl. Spring Lok	1 1/4" Rd 1/4" Keyway	48"	Augers

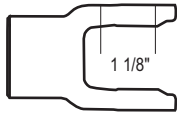

# 14 Series

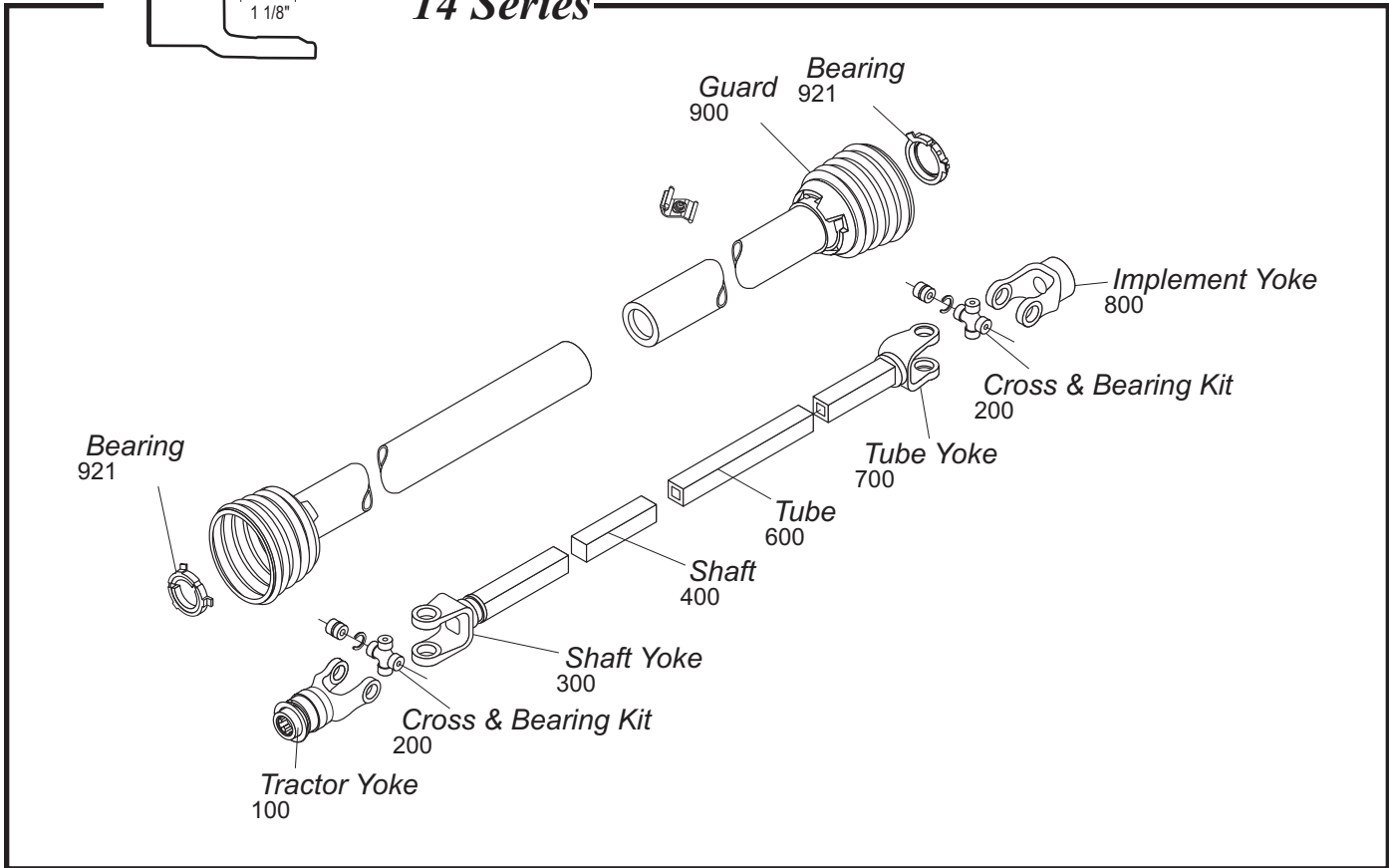

## Tractor Yoke

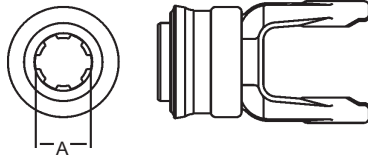

**Spring-Lok**  
Repair Kit — Page 81

Stock Number	Dim. "A" Bore
100-1406	1 3/8" x 6 Spl.
100-1421	1 3/8" x 21 Spl.

**Quick Disconnect**  
Repair Kit — Page 81

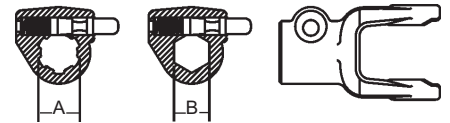

Stock Number	Dim. "A" Bore	Dim. "B" Bore
102-1406	1 3/8" x 6 Spl.	
102-1418		1 1/8" Hex
102-1421	1 3/8" x 21 Spl.	

**Safety Slide Lock**  
Repair Kit — Page 81

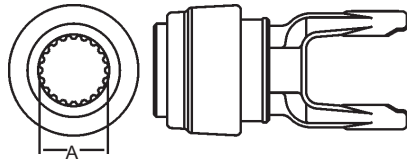

Stock Number	Dim. "A" Bore
101-1420	1 3/4" x 20 Spl.

**Ball Shear Device**  
With Spring-Lok  
Repair Kit — Page 81

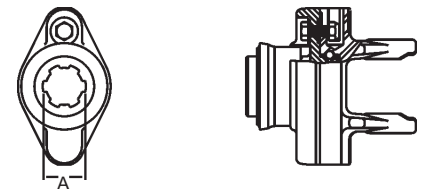

Stock Number	Dim. "A" Bore	Shear Bolt
104-1406	1 3/8" x 6 Spl.	5/16" - 18 Gr. 5
104-1421	1 3/8" x 21 Spl.	5/16" - 18 Gr. 5

# 14 Series (cont'd.)

## Cross & Bearing Kit (R-Kit)

Snap Ring Located in Yoke

Stock Number	Dim. A	Dim. B
200-1400	1 1/8"	2 5/8"

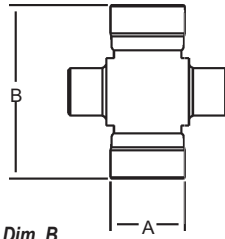

## Extended Lubrication Cross & Bearing Kit (E-Kit)

Snap Ring Located in Yoke

Stock Number	Dim. A	Dim. B
201-1400	1 1/8"	2 5/8"

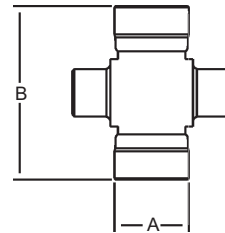

## Shaft Weld Yoke

With Bearing Groove  
(Guard must rotate freely on yoke)

Stock Number	Dim. "A" Bore	Dim. "B" Bore
300-1400	1" x 1 1/8"	
301-1400		1 5/16" x 20 Spl.

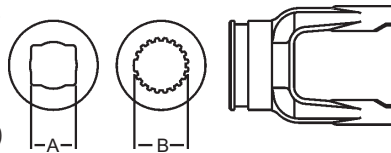

## Shaft

1" x 1 1/8" Rectangular

Stock Number	Length
400-1618	6'
401-1618	10'
404-1618	3'



1 5/16" x 20 Spline  
Induction Hardened

Stock Number	Length	Major Dim.
404-2120	3'	1.380/1.375



## Slip Sleeve

1" x 1 1/8" Rectangular  
With Grease Groove

Stock Number	Length	Fits Tube Size
500-1400	5"	2" (.083 Wall)

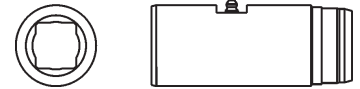

1 5/16" x 20 Spline  
With Grease Reservoir

Stock Number	Length	Fits Tube Size
501-1400	8"	2" (.083 Wall)

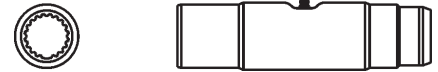

## Tube

1 1/4" x 1 3/8"  
Rectangular O.D.

Stock Number	Length	Fits Shaft
600-2022	6'	1" x 1 1/8"
601-2022	10'	1" x 1 1/8"
604-2022	3'	1" x 1 1/8"



2" Round (.083 Wall)

Stock Number	Length
602-1400	6'
603-1400	10'
604-1400	3'



## Tube Weld Yoke

With Bearing Groove  
(Guard must rotate freely on yoke)

Stock Number	Dim. "A" Bore	Dim. "B" Fits Tube Size
700-1400	1 1/4" x 1 3/8"	
701-1400		2" (.083 Wall)

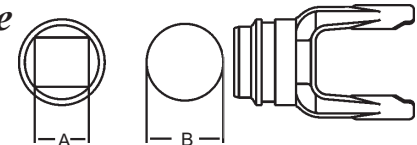

**Implement Yoke**

**Round Bore**

With Keyway & Set Screw

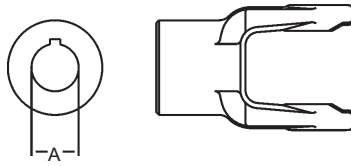

Stock Number	Dim. "A" Bore	Standard Keyway
800-1416	1"	1/4"
800-1418	1 1/8"	1/4"
800-1419	1 3/16"	1/4"
800-1420	1 1/4"	1/4"
800-1422	1 3/8"	5/16"
800-1423	1 7/16"	3/8"
800-1424	1 1/2"	3/8"

**Square Bore**

With Set Screw

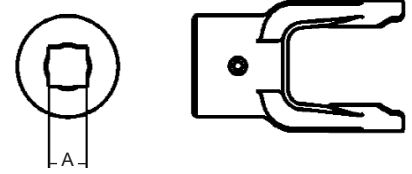

Stock Number	Dim. "A" Bore
804-1414	7/8"
804-1416	1"
804-1418	1 1/8"
804-1419	1 3/16"
804-1420	1 1/4"

**Spline Bore**

With 21/64" Pin Hole

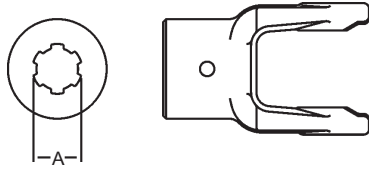

Stock Number	Dim. "A" Bore
801-1406	1 3/8" x 6 Spl.
801-1418	1 1/8" x 6 Spl.
801-1420	1 1/4" x 6 Spl.
801-1421	1 3/8" x 21 Spl.

**Hexagon Bore**

With Set Screw

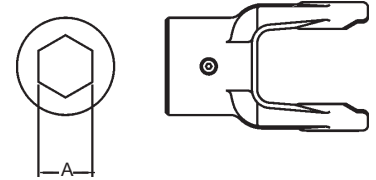

Stock Number	Dim. "A" Bore
805-1418	1 1/8"
805-1420	1 1/4"

**Shear Pin**

With 1/4" Pin Hole

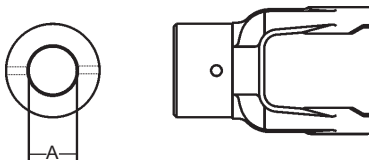

Stock Number	Dim. "A" Bore
802-1418	1 1/8"
802-1420	1 1/4"
802-1422*	1 3/8"
802-1424	1 1/2"

\* with 1/4" and 1/2" Pin Hole.

**Round Bore**

Double Keyway & Set Screw

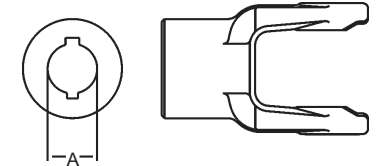

Stock Number	Dim. "A" Bore	Double Keyway
806-1418	1 1/8"	1/4" & 5/16"
806-1419	1 3/16"	1/4" & 5/16"
806-1420	1 1/4"	1/4" & 5/16"

**Torque Limiter Flange**

(Interchanges with Great Lakes Clutch)

Stock Number

803-1400

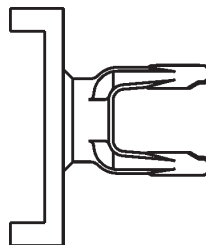

**Stock Bore**

With Hub O. D. Turned

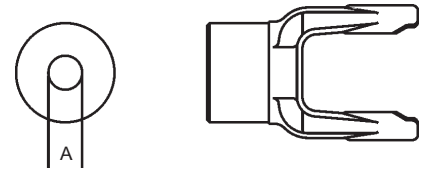

Stock Number	Dim. "A" Bore
809-1412	3/4"

# 14 Series (cont'd.)

## Guard

Order Bearings As Required

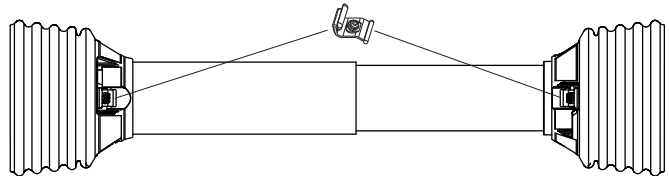

Stock Number	Overall Driveline Length	Bearing Kit (4-per kit)
900-2548	48"	921-1200
900-2560	60"	921-1200

Assembly instructions included with guard

Note: When installing Guards observe the following:

- 1) Install proper nylon bearing (See Page 13)
- 2) Guards must rotate freely on yokes

## Easy Lock™ Replacement Kit

Part Number: 13005000 (4-per Kit)



## Yoke & Shaft Assembly

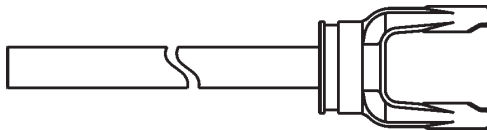

1" x 1 1/8" Shaft

Stock Number	Centerline to End of Shaft Dimension
10001438	26.12"
10001448	35.62"
10001460	47.62"

## Universal Joint

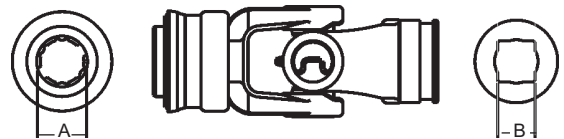

### Spring-Lok to Shaft Weld Yoke

Repair Kit — Page 81

Stock Number	Dim. "A" Bore	Dim. "B" Bore
15061400	1 3/8" x 6 Spl.	1" x 1 1/8" Rect.

## Yoke, Tube & Sleeve Assembly

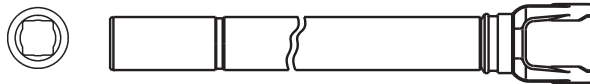

1" x 1 1/8" Rectangular

Stock Number	Centerline to End of Tube Dimension
11001438	26.12"
11001448	35.12"
11001460	48.12"

**Drivelines**

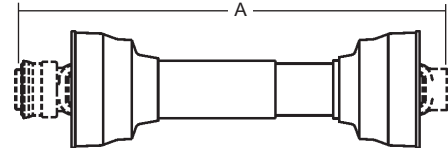
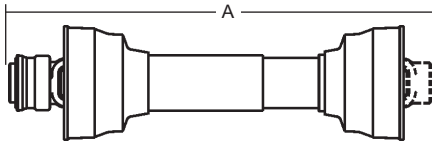

Drivelines are furnished without Cross & Bearing Kit and Implement Yoke. Select kit and implement yoke as required. When Cross & Bearing Kit and Implement Yoke are assembled, the overall compressed length of the driveline will be 48" or 60".

Drivelines are furnished without Cross & Bearing Kit and Outboard Yokes. Select kit and outboard yokes as required. When cross & bearing kit and outboard Yokes are assembled, the overall compressed length of the driveline will be 48" or 60".

Stock Number	Tractor Yoke	Overall Compressed Length Dim. "A"
14001448	1 3/8" x 6 Spl. Spring Lok	48"
14001460	1 3/8" x 6 Spl. Spring Lok	60"

Stock Number	Overall Compressed Length Dim. "A"
14011448	48"
14011460	60"
14021448 (With crosses installed)	48"

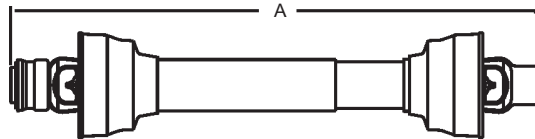

Stock Number	Tractor Yoke	Implement Yoke	Overall Compressed Length Dim. "A"	Application
14001404	1 3/8" x 6 Spl. Spring-Lok	1 3/8" Round 1/2" Shear Pin Hole	30 3/16"	4 ft. Lift Type Rotary Cutter
14001405	1 3/8" x 6 Spl. Spring-Lok	1 3/8" Round 1/2" Shear Pin Hole	37 3/16"	5 ft. Lift Type Rotary Cutter
14001406	1 3/8" x 6 Spl. Spring-Lok	1 3/8" Round 1/2" Shear Pin Hole	56 3/16"	5 & 6 ft. Pull Type Rotary Cutter
14001420	1 3/8" x 6 Spl. Spring-Lok	1 1/4" Round 1/4" Keyway	48"	Auger

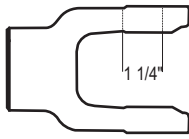

# 35 Series

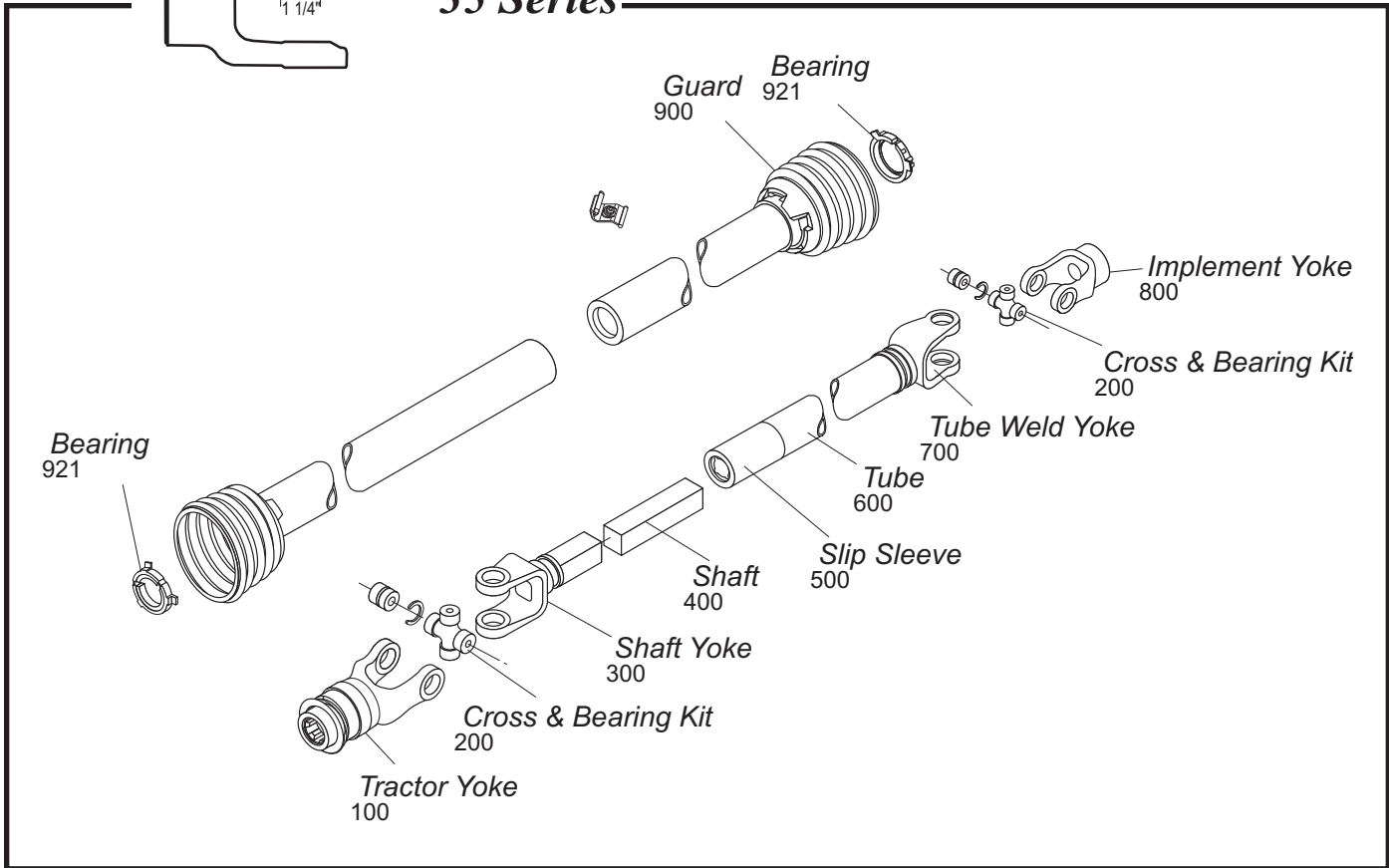

## Tractor Yoke

**Safety Slide Lock**  
Repair Kit — Page 81

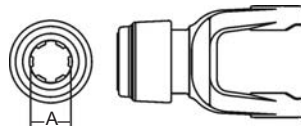

Stock Number	Dim. "A" Bore
101-3506	1 3/8" x 6 Spl.
101-3520	1 3/4" x 20 Spl.
101-3521	1 3/8" x 21 Spl.

**Ball Shear Device**  
With Safety Slide Lock  
Repair Kit — Page 81

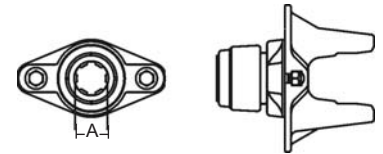

Stock Number	Dim. "A" Bore	Shear Bolt
104-3506	1 3/8" x 6 Spl.	(2) 3/8" - 16 Gr. 5
104-3520	1 3/4" x 20 Spl.	(2) 3/8" - 16 Gr. 5
104-3521	1 3/8" x 21 Spl.	(2) 3/8" - 16 Gr. 5

**Quick Disconnect**  
Repair Kit — Page 81

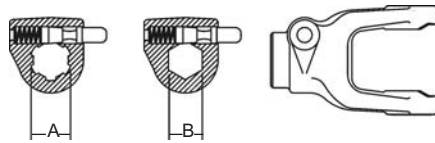

Stock Number	Dim. "A" Bore	Dim. "B" Bore
102-3505		1 1/4" Hex
102-3506	1 3/8" x 6 Spl.	
102-3518		1 1/8" Hex
102-3520	1 3/4" x 20 Spl.	
102-3521	1 3/8" x 21 Spl.	
102-3528	1 3/4" x 6 Spl.	

**Auto-Lok**  
Repair Kit — Page 81

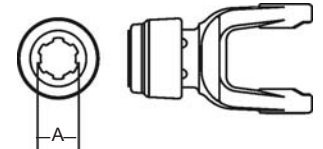

Stock Number	Dim. "A" Bore
110-3506	1 3/8" x 6 Spl.
110-3520	1 3/4" x 20 Spl.
110-3521	1 3/8" x 21 Spl.

## Cross & Bearing Kit (R-Kit)

Snap Ring Located in Yoke

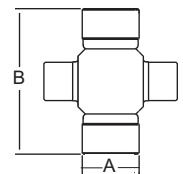

Stock Number	Dim. "A"	Dim. "B"
200-3500	1 1/4"	3 7/32"

## Extended Lubrication Cross & Bearing Kit (E-Kit)

Snap Ring Located in Yoke

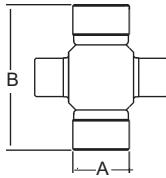

Stock Number	Dim. "A"	Dim. "B"
201-3500	1 1/4"	3 7/32"

## Slip Sleeve

With Grease Groove

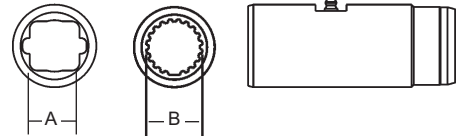

Stock Number	Length	Dim. "A" Bore	Dim. "B" Bore	Fits Tube Size
500-3500	5"	1 3/16" Sq.		2 1/8" (.120 Wall)
501-3500	5"	1 3/16" Sq.		2 1/8" (.083 Wall) & 2 1/4" (.120 Wall)
504-3500	8"	1 5/16" Sq.		2 1/2" (.120 Wall)
505-3500	5"		1 11/16" x 20 Spl.	2 1/2" (.120 Wall)

## Shaft Weld Yoke

With Bearing Groove  
(Guard must rotate freely on yoke)

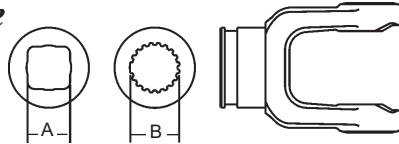

Stock Dim. Number	"A" Dim. Bore	"B" Bore
300-3500	1 3/16" Sq.	
301-3500		1 5/16" x 20 Spl.
*302-3500		1 11/16" x 20 Spl.

\* For use with 921-4400 Nylon Bearing Kit

## Spline Sleeve

With Grease Reservoir

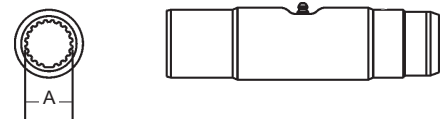

Stock Number	Length	Dim. "A" Bore	Fits Tube Size
502-3500	8"	1 5/16" x 20 Spl.	2 1/8" (.120 Wall)
503-3500	8"	1 11/16" x 20 Spl.	2 1/2" (.120 Wall)

## Shaft



1 3/16" Square

Stock Number	Length
400-0019	6'
401-0019	10'
404-0019	3'

## Tube



Stock Number	Dim. "A" Size	Length
602-3500	2 1/8" (.120 Wall)	6'
602-3501	2 1/8" (.083 Wall)	6'
603-3500	2 1/8" (.120 Wall)	10'
604-3500	2 1/8" (.120 Wall)	3'

## Spline Shaft

Induction Hardened



Stock Number	Dim. "A" Size	Length	Major Dim.
404-2120	1 5/16" x 20 Spl.	3'	1.380/1.375
404-2720	1 11/16" x 20 Spl.	3'	1.790/1.785

## Tube Weld Yoke

With Bearing Groove  
(Guard must rotate freely on yoke)

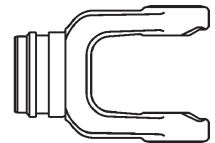

Stock Number	Fits Tube Size
701-3500	2 1/8" (.120 Wall)
702-3500	2 1/8" (.083 Wall)
703-3500 with Bore**	2 1/4" (.120 Wall)
704-3500 with Bore**	2 1/2" (.120 Wall)
705-3500 with Bore**	2 1/8" (.120 Wall)

\*\* Bore through for telescoping shaft

# 35 Series (cont'd.)

## Implement Yoke

### Round Bore

With Keyway & Set Screw

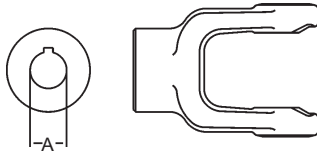

Stock Number	Dim. "A" Bore	Standard Keyway
800-3516	1"	1/4"
800-3518	1 1/8"	1/4"
800-3519	1 3/16"	1/4"
800-3520	1 1/4"	1/4"
800-3522	1 3/8"	5/16"
800-3523	1 7/16"	3/8"
800-3524	1 1/2"	3/8"
8003524H	1 1/2"	3/8" with Pinhole
800-3526	1 5/8"	3/8"
800-3528	1 3/4"	3/8"

### Square Bore

With Set Screw

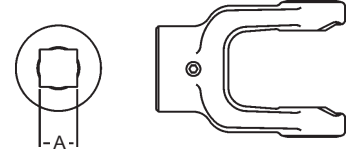

Stock Number	Dim. "A" Bore
804-3516	1"
804-3518	1 1/8"
804-3519	1 3/16"
804-3520	1 1/4"
804-3524	1 1/2"
804-3526	1 5/8"

### Spline Bore

With 21/64" Pin Hole

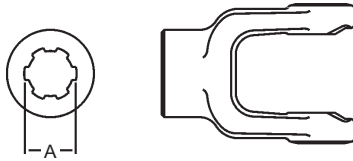

Stock Number	Dim. "A" Bore
801-3506	1 3/8" x 6 Spl.
801-3521	1 3/8" x 21 Spl.

### Round Bore

Double Keyway & Set Screw

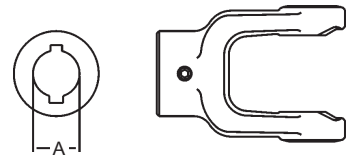

Stock Number	Dim. "A" Bore	Double Keyway
806-3519	1 3/16"	1/4" & 5/16"
806-3520	1 1/4"	1/4" & 5/16"
806-3522	1 3/8"	5/16" & 3/8"

### Shear Pin

With 1/4" Pin Hole

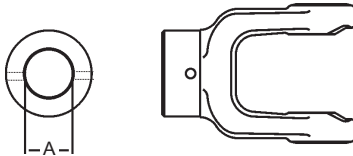

Stock Number	Dim. "A" Bore
802-3520	1 1/4"
802-3522*	1 3/8"
802-3524	1 1/2"

\* With 1/2" Pin Hole.

### Clamp Yoke

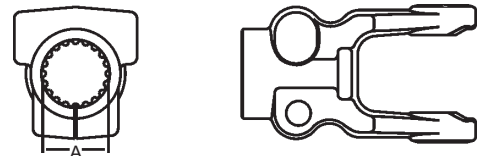

Stock Number	Dim. "A" Bore
807-3506	1 3/8" x 6 Spl.
807-3520	1 3/4" x 20 Spl.
807-3521	1 3/8" x 21 Spl.
807-3527	1 3/4" x 27 Spl.

### Torque Limiter Flange

(Interchanges with Great Lakes Clutch)

Stock Number
803-3500

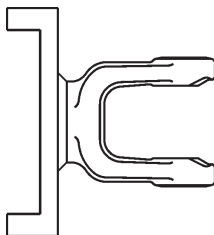

### Stock Bore

With Hub O. D. Turned

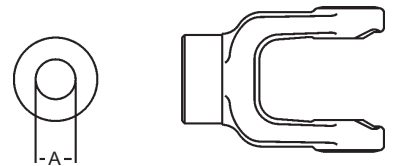

Stock Number	Dim. "A" Bore
809-3516	1"

## Guard

Order Bearings As Required

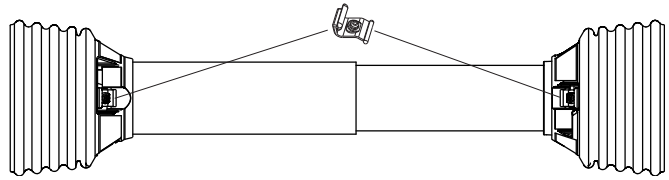

Stock Number	Overall Driveline Length	Bearing Kit (4-per kit)
900-2548	48"	921-1200
900-2560	60"	921-1200

Assembly instructions included with guard

Note: When installing Guards observe the following:

- 1) Install proper nylon bearing (See Page 13)
- 2) Guards must rotate freely on yokes

## Easy Lock™ Replacement Kit

Part Number: 13005000 (4-per Kit)



## Yoke & Shaft Assembly

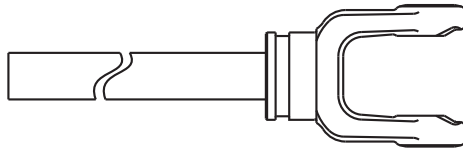

1 3/16" Square Shaft

Stock Number	Centerline to End of Shaft Dimension
10003531	17.69"
10003535	21.69"
10003542	28.69"
10003548	33.19"
10003560	44.94"

## Universal Joint

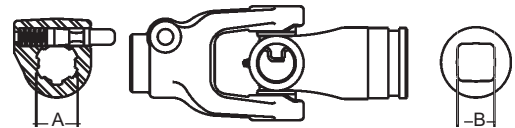

Quick Disconnect to Shaft Weld Yoke

Repair Kit — Page 81

Stock Number	Dim. "A" Bore	Dim. "B" Bore
15063500	1 3/8" x 6 Spl.	1 3/16" Sq.

## Yoke, Tube & Sleeve Assembly

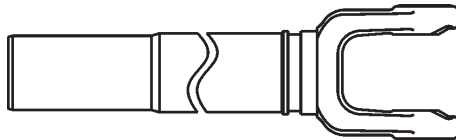

1 3/16" Square

Stock Number	Centerline to End of Tube Dimension
11003531	17.69"
11003535	21.69"
11003543	29.69"
11003548	34.69"
11003560	46.69"

# 35 Series (cont'd.)

## Drivelines

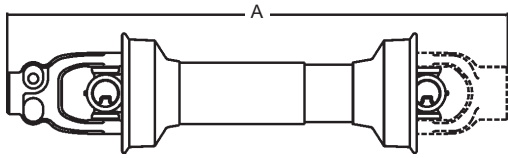

Drivelines are furnished without Cross & Bearing Kit and Implement Yoke. Select kit and yoke as required. When cross & bearing kit and yoke are assembled, the overall compressed length of the driveline will be 31", 35", 48" or 60".

Stock Number	Tractor Yoke	Overall Compressed Length Dim. "A"
14003531	1 3/8" x 6 Spl. Q.D.	31"
14003535	1 3/8" x 6 Spl. Q.D.	35"
14003548	1 3/8" x 6 Spl. Q.D.	48"
14003560	1 3/8" x 6 Spl. Q.D.	60"

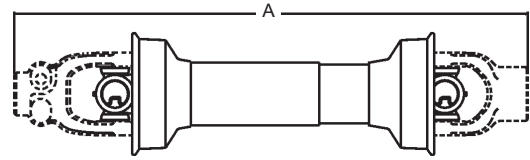

Drivelines are furnished without Cross & Bearing Kit and Outboard Yokes. Select kit and outboard yokes as required. When cross & bearing kit and outboard yokes are assembled, the overall compressed length of the driveline will be 39", 48" or 60".

Stock Number	Overall Compressed Length Dim. "A"
14013548	48"
14013560	60"
14023539 with crosses installed	39"
14023548 with crosses installed	48"

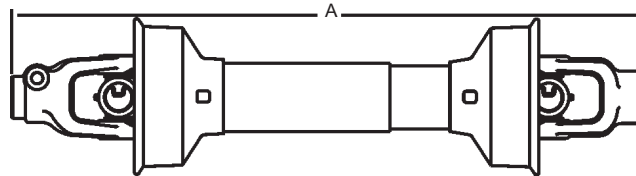

Stock Number	Tractor Yoke	Implement Yoke	Overall Compressed Length Dim. "A"	Application
14003507	1 3/8" x 6 Spl. Q.D.	1 3/8" Round 1/2" Shear Pin Hole	64 7/8"	7 ft. Pull Type Rotary Cutter
14003524	1 3/8" x 6 Spl. Q.D.	1 1/2" Round 3/8" Keyway	48"	Pumps
14003536	1 3/8" x 6 Spl. Safety Slide Lock	1 3/8" 6 Spl. Safety Slide Lock	36"	All Purpose
14013531	1 3/8" x 21 Spl. Safety Slide Lock	1 1/8" Hex Clamp	31"	Combine Header
14013533	1 3/8" x 21 Spl. Safety Slide Lock	1 1/8" Hex Clamp	33"	Combine Header

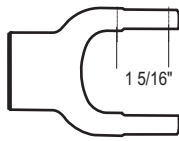

## 44 Series

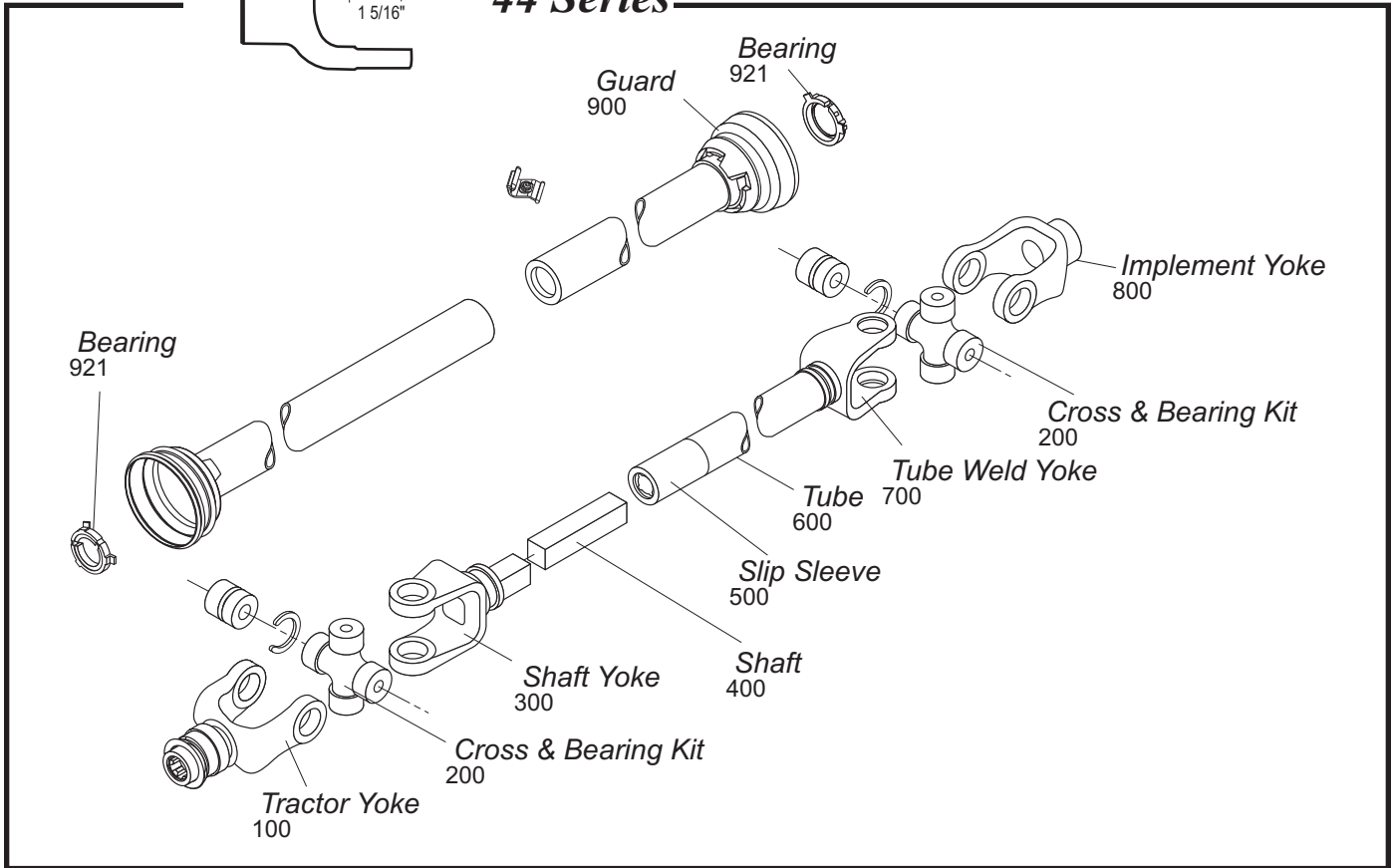

### Tractor Yoke

#### Safety Slide Lock Repair Kit — Page 81

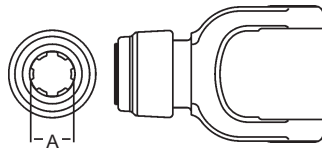

Stock Number	Dim. "A" Bore
101-4406	1 3/8" × 6 Spl.
101-4420	1 3/4" × 20 Spl.
101-4421	1 3/8" × 21 Spl.

#### Ball Shear Device With Safety Slide Lock Repair Kit — Page 81

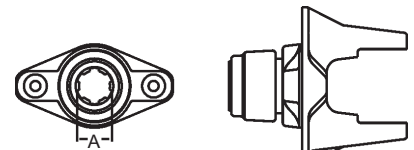

Stock Number	Dim. "A" Bore	Shear Bolt
104-4406	1 3/8" × 6 Spl.	(2) 3/8" × 16 Gr. 5
104-4420	1 3/4" × 20 Spl.	(2) 3/8" × 16 Gr. 5
104-4421	1 3/8" × 21 Spl.	(2) 3/8" × 16 Gr. 5

#### Quick Disconnect Repair Kit — Page 81

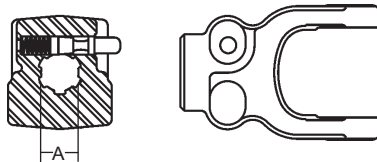

Stock Number	Dim. "A" Bore
102-4406	1 3/8" × 6 Spl.
102-4420	1 3/4" × 20 Spl.
102-4421	1 3/8" × 21 Spl.

#### Auto-Lok Repair Kit — Page 81

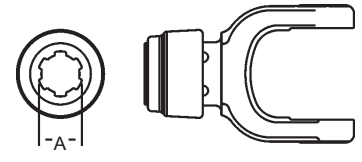

Stock Number	Dim. "A" Bore
110-4406	1 3/8" × 6 Spl.
110-4420	1 3/4" × 20 Spl.
110-4421	1 3/8" × 21 Spl.

# 44 Series (cont'd.)

## Cross & Bearing Kit (R-Kit)

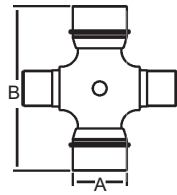

Snap Ring Located in Bushing

Stock Number	Dim. "A"	Dim. "B"
200-4400	1 5/16"	4"

## Extended Lubrication Cross & Bearing Kit (E-Kit)

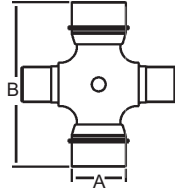

Snap Ring Located in Bushing

Stock Number	Dim. "A"	Dim. "B"
201-4400	1 5/16"	4"

## Slip Sleeve

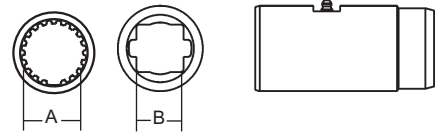

With Grease Groove

Stock Number	Length	Dim. "A"	Dim. "B"	Fits Tube Size
500-4400	5"		1 5/16" Sq.	2 1/2" (.120 Wall)
505-3500	5"	1 11/16" x 20 Spl.		2 1/2" (.120 Wall)

## Shaft Weld Yoke

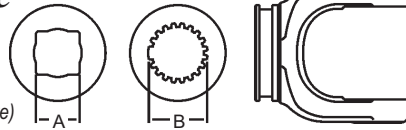

With Bearing Groove  
(Guard must rotate freely on yoke)

Stock Number	Dim. "A" Bore	Dim. "B" Bore
300-4400	1 5/16" Sq.	
302-4400		1 11/16" x 20 Spl.

## Tube

2 1/2" (.120 Wall)



Stock Number	Length
602-4400	6'
603-4400	10'
604-4400	3'

## Shaft

1 5/16" Square



Stock Number	Length
400-0021	6'
401-0021	10'
404-0021	3'

## Tube Weld Yoke

With Bearing Groove  
(Guard must rotate freely on yoke)

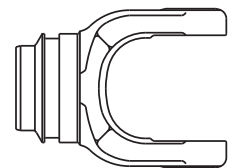

Stock Number	Fits Tube Size
701-4400	2 1/2" (.120 Wall)
*702-4400 (with bore)	2 1/2" (.120 wall)

\* Bore through for Telescoping



Spline Shaft  
Induction Hardened

Stock Number	Dim. "A"	Length	Major Dim.
404-2120	1 5/16" x 20 Spl.	3'	1.380/1.375
404-2720	1 11/16" x 20 Spl.	3'	1.790/1.785

**Implement Yoke**

**Round Bore**

With Keyway & Set Screw

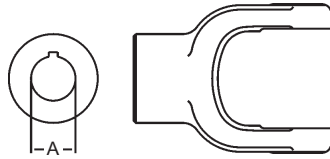

Stock Number	Dim. "A" Bore	Standard Keyway
800-4420	1 1/4"	1/4"
800-4422	1 3/8"	5/16"
800-4423	1 7/16"	3/8"
800-4424	1 1/2"	3/8"
800-4426	1 5/8"	3/8"
800-4428	1 3/4"	3/8"
800-4432	2"	1/2"

**Round Bore**

Double Keyway & Set Screw



Stock Number	Dim. "A" Bore	Double Keyway
806-4420	1 1/4"	5/16" & 1/4"
806-4422	1 3/8"	5/16" & 1/4"
806-4424	1 1/2"	5/16" & 3/8"

**Spline Bore**

With 21/64" Pin Hole

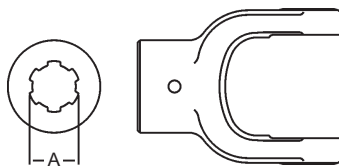

Stock Number	Dim. "A" Bore
801-4406	1 3/8" x 6 Spl.
801-4421	1 3/8" x 21 Spl.

**Clamp Yoke**

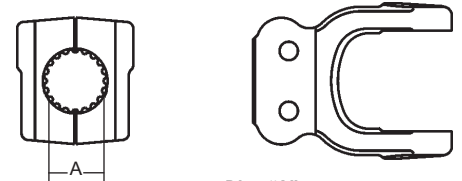

Stock Number	Dim. "A" Bore
807-4406	1 3/8" x 6 Spl.
807-4420	1 3/4" x 20 Spl.
807-4421	1 3/8" x 21 Spl.
807-4427	1 3/4" x 27 Spl.

**Torque Limiter Flange**

(Interchanges with Great Lakes Clutch)

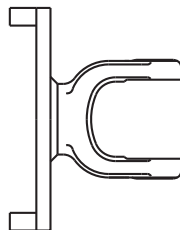

Stock Number
803-4400

**Stock Bore**

With Hub O. D. Turned

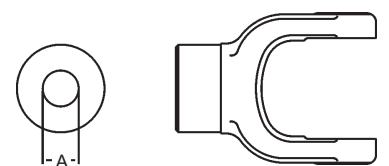

Stock Number	Dim. "A" Bore
809-4416	1"

**Square Bore**

With Set Screw

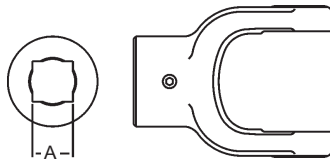

Stock Number	Dim. "A" Bore
804-4418	1 1/8"

# 44 Series (cont'd.)

## Guard

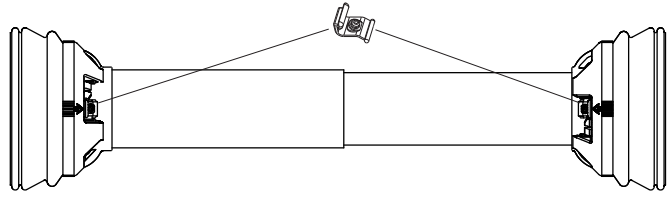

Stock Number	Overall Driveline Length	Bearing Kit (4-per kit)
902-3548	48"	921-4400
902-3560	60"	921-4400

Assembly instructions included with guard

Note: When installing Guards observe the following:

- 1) Install proper nylon bearing (See Page 13)
- 2) Guards must rotate freely on yokes

## Easy Lock™ Replacement Kit

Part Number: 13005000 (4-per Kit)



## Yoke & Shaft Assembly

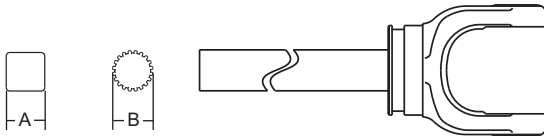

Stock Number	Dim. "A"	Dim. "B"	Centerline to End of Shaft Dimension
10004448	1 5/16" Sq.		33.12"
10004460	1 5/16" Sq.		45.12"
10014448		1 11/16" x 20 Spl.	33.12"

## Yoke, Tube & Sleeve Assembly

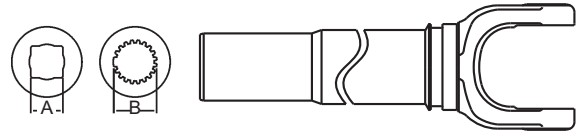

Stock Number	Dim. "A" Bore	Dim. "B" Bore	Centerline to End of Tube Dimension
11004448	1 5/16" Sq.		35.62"
11004460	1 5/16" Sq.		45.62"
11014448		1 11/16" x 20 Spl.	35.62"

**Drivelines**

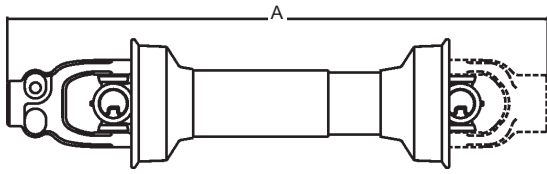

Drivelines are furnished without Cross & Bearing Kit and Implement Yoke. Select kit and yoke as required. When cross & bearing kit and yoke are assembled, the overall compressed length of the driveline will be 48" or 60".

Stock Number	Shaft Size	Tractor Yoke	Overall Compressed Length Dim. "A"
14004448	1 5/16"	1 3/8" x 6 Spl. Q.D.	48"
14004460	1 5/16"	1 3/8" x 6 Spl. Q.D.	60"
14044448	1 11/16" x 20 Spl.	1 3/8" x 6 Spl. Q.D.	48"

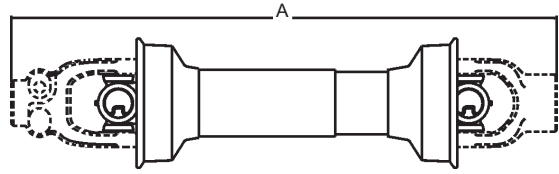

Drivelines are furnished without Cross & Bearing Kit and Outboard Yokes. Select kit and outboard yokes as required. When cross & bearing kit and outboard yokes are assembled, the overall compressed length of the driveline will be 48" or 60".

Stock Number	Shaft	Overall Compressed Length Dim. "A"
14014448	1 5/16"	48"
14014460	1 5/16"	60"
14054448	1 11/16" x 20 Spl.	48"

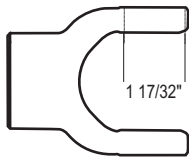

## 55 Series

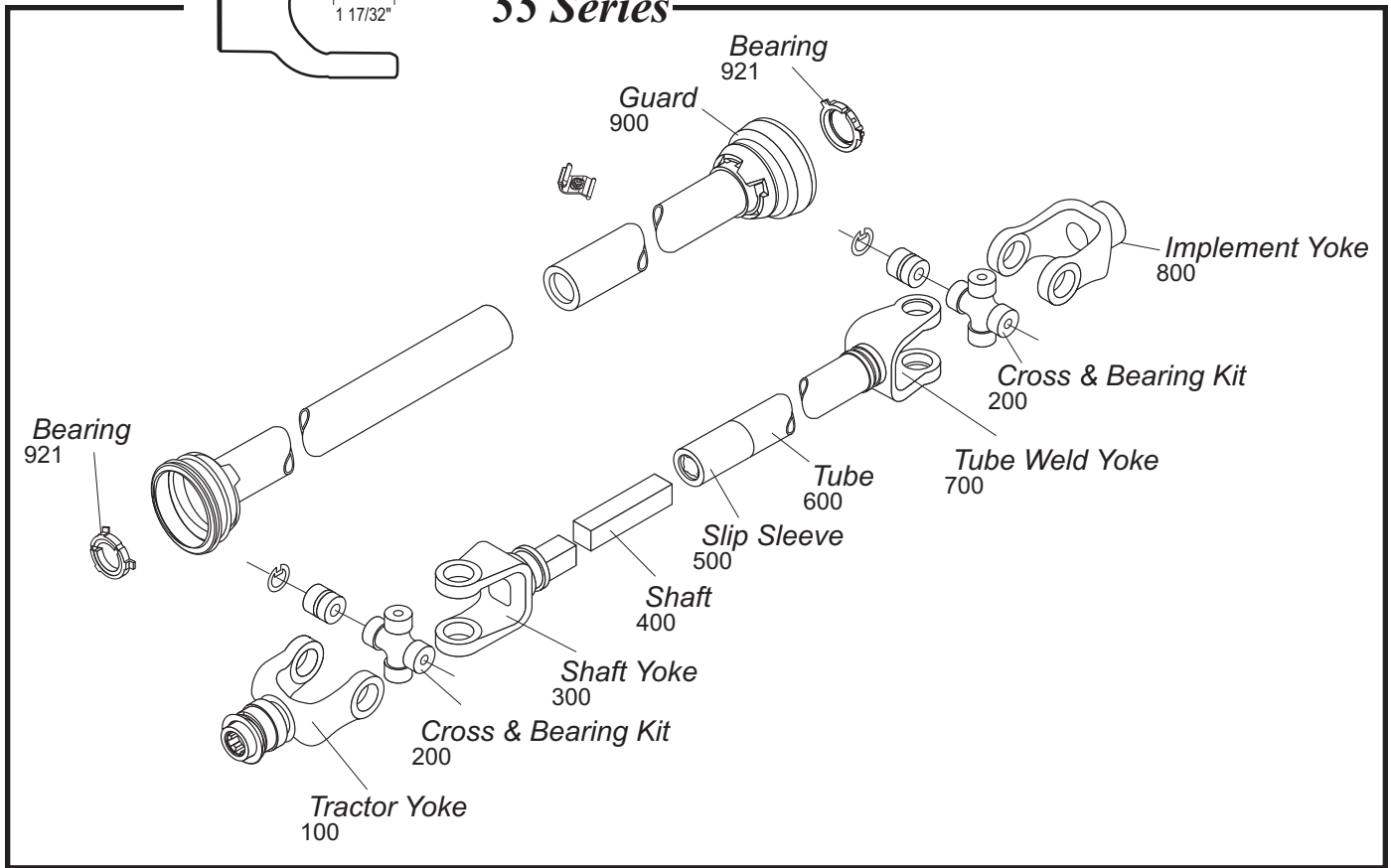

### Tractor Yoke

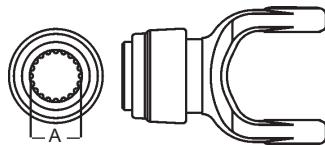

**Safety Slide Lock**  
Repair Kit — Page 81

Stock Number	Dim. "A" Bore
101-5506	1 3/8" x 6 Spl.
101-5520	1 3/4" x 20 Spl.
101-5521	1 3/8" x 21 Spl.

**Ball Shear Device**  
With Safety Slide Lock  
Repair Kit — Page 81

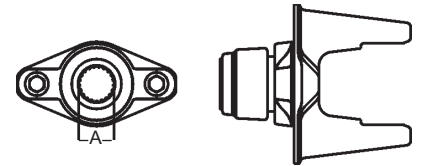

Stock Number	Dim. "A" Bore	Shear Bolt
104-5506	1 3/8" x 6 Spl.	(2) 3/8" x 16 Gr. 5
104-5520	1 3/4" x 20 Spl.	(2) 3/8" x 16 Gr. 5
104-5521	1 3/8" x 21 Spl.	(2) 3/8" x 16 Gr. 5

**Quick Disconnect**  
Repair Kit — Page 81

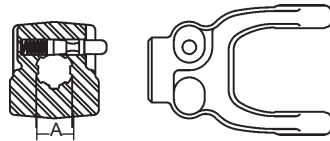

Stock Number	Dim. "A" Bore
102-5506	1 3/8" x 6 Spl.
102-5521	1 3/8" x 21 Spl.
102-5520	1 3/4" x 20 Spl.
102-5528	1 3/4" x 6 Spl.

**Auto-Lok**  
Repair Kit — Page 81

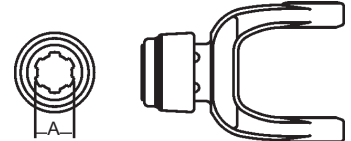

Stock Number	Dim. "A" Bore
110-5506	1 3/8" x 6 Spl.
110-5520	1 3/4" x 20 Spl.
110-5521	1 3/8" x 21 Spl.

**Cross & Bearing Kit  
(R-Kit)**

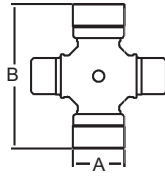

Snap Ring Located in Yoke

Stock Number	Dim. "A"	Dim. "B"
200-5500	1 17/32"	4 5/16"

**Extended Lubrication  
Cross & Bearing Kit  
(E-Kit)**

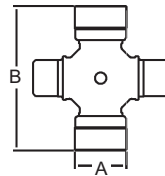

Snap Ring Located in Yoke

Stock Number	Dim. "A"	Dim. "B"
201-5500	1 17/32"	4 5/16"

**Shaft Weld Yoke**

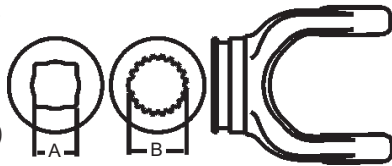

With Bearing Groove  
(Guard must rotate freely on yoke)

Stock Number	Dim. "A" Bore	Dim. "B" Bore
300-5500	1 5/16" Sq.	
301-5500*	1 3/16" Sq.	
302-5500		1 11/16" x 20 Spl.

\*Use 04-15155 Nylon Bearing

**Shaft**



1 5/16" Square

Stock Number	Length
400-0021	6'
401-0021	10'
404-0021	3'

**Spline Shaft**

Induction Hardened

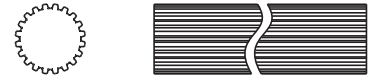

Stock Number	Dim. "A"	Length	Major Dim.
404-2120	1 5/16" x 20 Spl.	3'	1.380/1.375
404-2720	1 11/16" x 20 Spl.	3'	1.790/1.785

**Slip Sleeve**

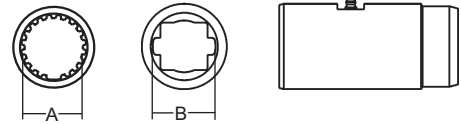

With Grease Groove

Stock Number	Dim. "A" Bore	Dim. "B" Bore	Length	Fits Tube Size
500-4400		1 5/16" Sq.	5"	2 1/2" (.120 Wall)
505-3500	1 11/16" x 20 Spl.		5"	2 1/2" (.120 Wall)

With Grease Reservoir

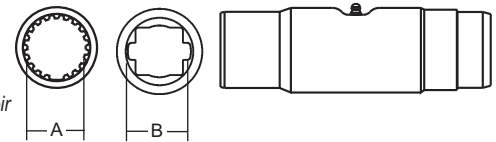

Stock Number	Dim. "A" Bore	Dim. "B" Bore	Length	Fits Tube Size
503-3500	1 11/16" x 20 Spl.		8"	2 1/2" (.120 Wall)
504-3500		1 5/16" Sq.	8"	2 1/2" (.120 Wall)

**Tube**



2 1/2" (.120 Wall)

Stock Number	Length
602-4400	6'
603-4400	10'
604-4400	3'

# 55 Series (cont'd.)

## Tube Weld Yoke

With Bearing Groove  
(Guard must rotate freely on yoke)

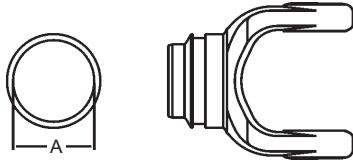

Stock Number	Fits Tube Size
701-5500	2 1/2" (.120 wall)
*704-5500 (with bore)	2 1/2" (.120 wall)

\* Bore through for Telescoping

## Clamp Yoke

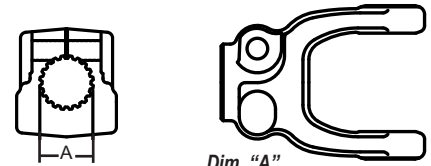

Stock Number	Dim. "A" Bore
807-5506	1 3/8" x 6 Spl.
807-5520	1 3/4" x 20 Spl.
807-5521	1 3/8" x 21 Spl.
807-5527	1 3/4" x 27 Spl.

## Implement Yoke

### Round Bore

With Keyway & Set Screw

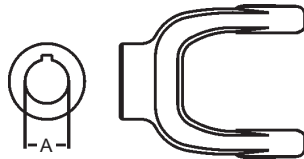

Stock Number	Dim. "A" Bore	Standard Keyway
800-5522	1 3/8"	5/16"
800-5524	1 1/2"	3/8"
800-5526	1 5/8"	3/8"
800-5528	1 3/4"	3/8"
800-5532	2"	1/2"

### Stock Bore

With Hub O. D. Turned

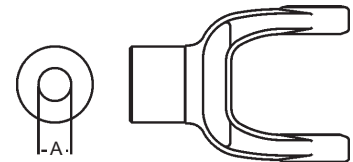

Stock Number	Dim. "A" Bore
809-5516	1"

### Spline Bore

With 21/64" Pin Hole

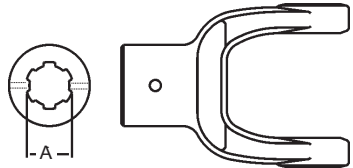

Stock Number	Dim. "A" Bore
801-5506	1 3/8" x 6 Spl.
801-5521	1 3/8" x 21 Spl.

## Guard

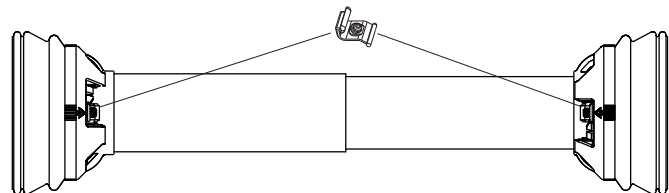

Stock Number	Overall Driveline Length	Bearing Kit (4-per kit)
902-3548	48"	921-4400
902-3560	60"	921-4400

Assembly instructions included with guard

Note: When installing Guards observe the following:

- 1) Install proper nylon bearing (See Page 13)
- 2) Guards must rotate freely on yokes

## Easy Lock™ Replacement Kit

Part Number: 13005000 (4-per Kit)



**Yoke & Shaft Assembly**

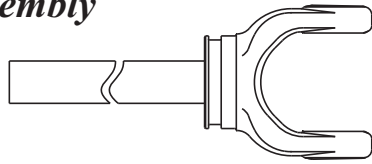

Stock Number	Shaft Size	Centerline to End of Shaft Dimension
10005548	1 5/16"	32.75"
10005560	1 5/16"	44.88"
10015548	1 11/16" x 20 Spl.	32.75"

**Yoke, Tube & Sleeve Assembly**

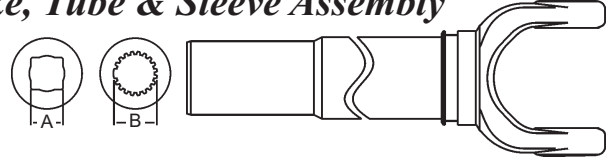

Stock Number	Dim. "A" Bore	Dim. "B" Bore	Centerline to End of Tube Dimension
11005548	1 5/16" Sq.		33.38"
11005560	1 5/16" Sq.		45.38"
11015548		1 11/16" x 20 Spl.	33.38"

**Drivelines**

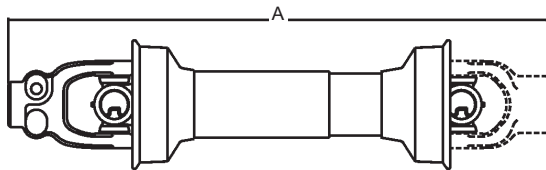

Drivelines are furnished without Cross & Bearing Kit and Implement Yoke. Select kit and yoke as required. When cross & bearing kit and yoke are assembled, the overall compressed length of the driveline will be 48" or 60".

Stock Number	Shaft Size	Tractor Yoke	Overall Compressed Length Dim. "A"
14005548	1 5/16"	1 3/8" x 6 Spl. Q.D.	48"
14005560	1 5/16"	1 3/8" x 6 Spl. Q.D.	60"
14045548	1 11/16" x 20 Spl.	1 3/8" x 6 Spl. Q.D.	48"

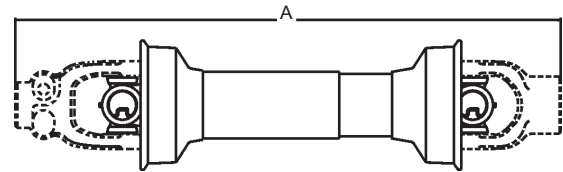

Drivelines are furnished without Cross & Bearing Kit and Outboard Yokes. Select kit and outboard yokes as required. When cross & bearing kit and outboard yokes are assembled, the overall compressed length of the driveline will be 48", 58" or 60".

Stock Number	Shaft	Overall Compressed Length Dim. "A"
14015548	1 5/16" Sq.	48"
14015560	1 5/16" Sq.	60"
14055548	1 11/16" x 20 Spl.	48"
14055558	1 11/16" x 20 Spl.	58"

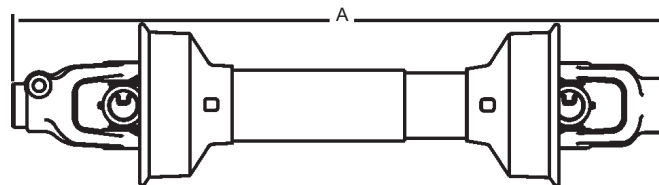

Stock Number	Tractor Yoke	Implement Yoke	Overall Compressed Length Dim. "A"	Application	Shaft Size
14005537	1 3/8" x 6 Spl. Safety Slide Lock	1 3/8" x 6 Spl. Safety Slide Lock	37"	All Purpose	1 5/16" Sq.
14005546	1 3/4" x 20 Spl. Safety Slide lock	1 3/4" Rd. w/ Keyway and (2) Set Screws	46"	All Purpose	1 11/16" x 20 Spl.

# W Series

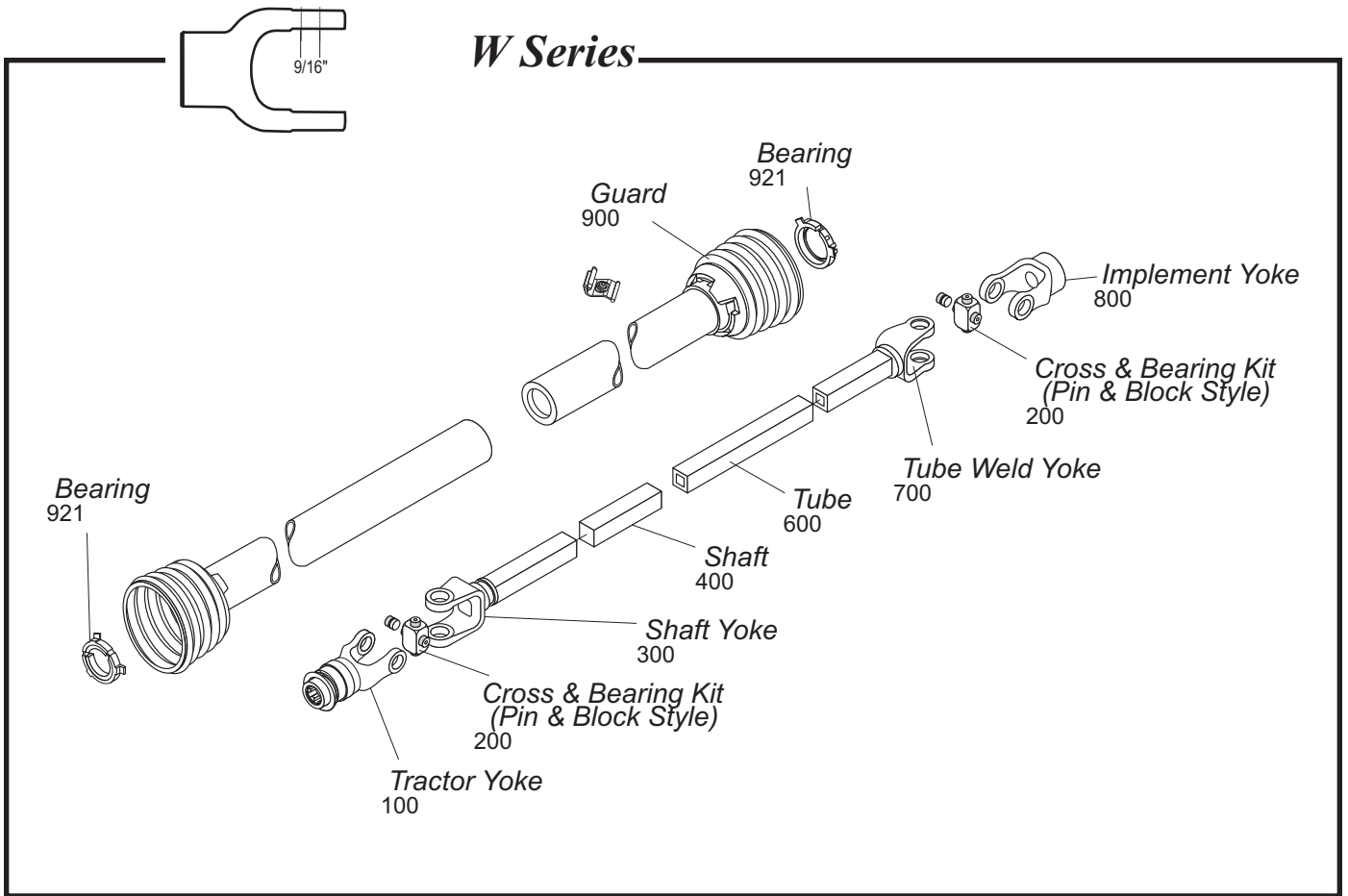

## Tractor Yoke

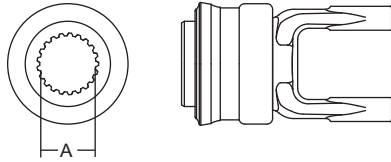

**Spring-Lok**  
Repair Kit — Page 81

Stock Number	Dim. "A" Bore
100-0721	1 3/8" x 21 Spl.

## Cross & Bearing Kit (Pin & Block Style)

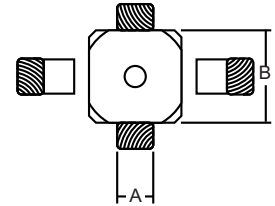

Zerk Located in Block

Stock Number	Dim. "A"	Dim. "B"
200-0700	9/16"	1 1/2"

**Quick Disconnect**  
Repair Kit — Page 81

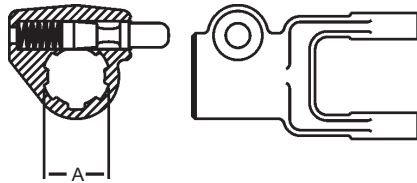

Stock Number	Dim. "A" Bore
102-0706	1 3/8" x 6 Spl.

## Shaft Weld Yoke



With Bearing Groove  
(Guard must rotate freely on yoke)

Stock Number	Dim. "A" Bore
300-0700	15/16" Sq.

**Shaft**

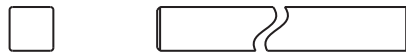

15/16" Square

Stock Number	Length	Fits Tube
400-0015	6'	1 1/4" Sq.

**Tube Weld Yoke**



With Bearing Groove  
(Guard must rotate freely on yoke)

Stock Number	Dim "A" Bore	Fits Tube Size
700-0700	15/16" Sq.	1 1/4"

**Tube**



1 1/4" Square O.D.

Stock Number	Length	Fits Shaft
600-0015	6'	15/16" Sq.

**Guard**

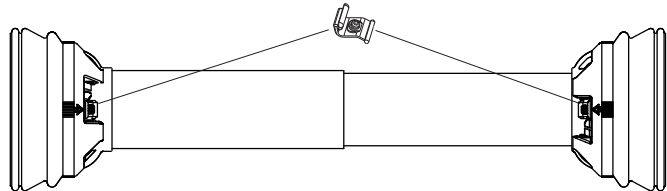

Stock Number	Overall Driveline Length	Bearing Kit (4-per kit)
900-2548	48"	921-5170

Assembly instructions included with guard  
 Note: When installing Guards observe the following:  
 1) Install proper nylon bearing (See Page 13)  
 2) Guards must rotate freely on yokes

**Easy Lock™ Replacement Kit**

Part Number: 13005000 (4-per Kit)



**Drivelines**

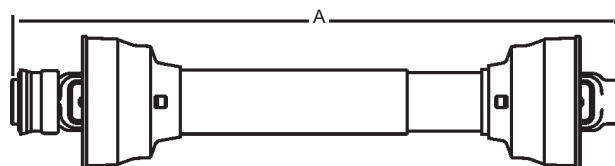

Use 12 Series driveline for all "W" Series replacement drivelines. See 12 Series (Page 30) for drivelines.

# 0675 Series

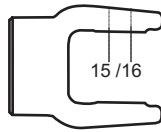

Interchanges with Neapco

## Tractor Yoke

**Spring-Lok**  
Repair Kit — Page 81

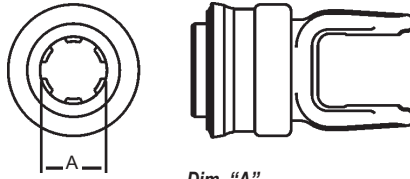

Stock Number	Dim. "A" Bore
100-0506	1 3/8" x 6 Spl.

## Implement Yoke

**Round Bore**  
With Keyway & Set Screw

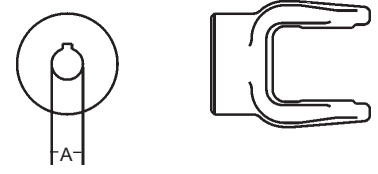

Stock Number	Dim. "A" Bore	Standard Keyway
800-0512	3/4"	3/16"

**Quick Disconnect**  
Repair Kit — Page 81

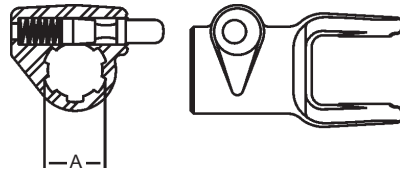

Stock Number	Dim. "A" Bore
102-0506	1 3/8" x 6 Spl.

**Spline Bore**  
With 21/64" Pin Hole

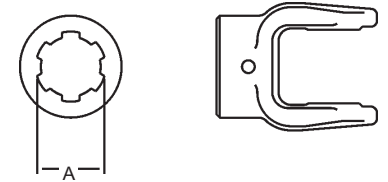

Stock Number	Dim. "A" Bore
801-0506	1 3/8" x 6 Spl.

## Cross & Bearing Kit

Snap Ring Located in Bushing

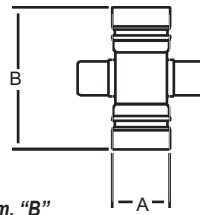

Stock Number	Dim. "A"	Dim. "B"
200-0675	15/16"	2 5/16"

**Square Bore**  
With Set Screw



Stock Number	Dim. "A" Bore
804-0512	3/4"
804-0514	7/8"
804-0516	1"

## Shaft Weld Yoke

With Bearing Groove  
(Guard must rotate freely on yoke)

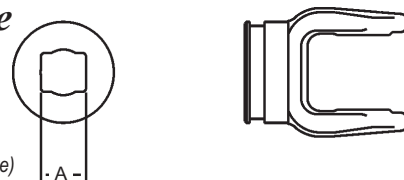

Stock Number	Dim. "A" Bore
300-0500	3/4" x 7/8"

**Round Bore**  
With Double Keyway & Set Screw

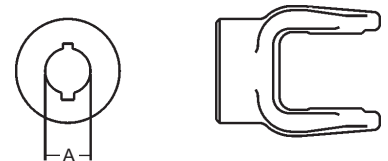

Stock Number	Dim. "A" Bore	Double Keyway
806-0514	7/8"	3/16" & 1/4"
806-0516	1"	3/16" & 1/4"
806-0518	1 1/8"	1/4" & 5/16"
806-0520	1 1/4"	1/4" & 5/16"

## Tube Weld Yoke

With Bearing Groove  
(Guard must rotate freely on yoke)

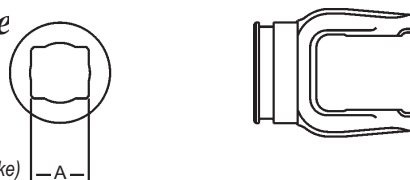

Stock Number	Dim. "A" Bore
700-0500	1" x 1 1/8"

# 1000 Series

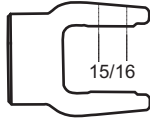

Interchanges with Spicer and Neapco

## Tractor Yoke

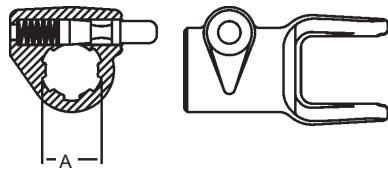

**Quick Disconnect**  
Repair Kit — Page 81

Stock Number	Dim. "A" Bore
102-1006	1 3/8" x 6 Spl.

## Cross & Bearing Kit

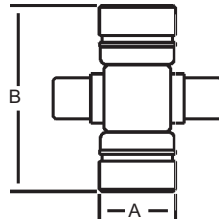

Snap Ring Located in Bushing

Stock Number	Dim. "A"	Dim. "B"
200-1000	15/16"	2 19/64"

## Shaft Weld Yoke

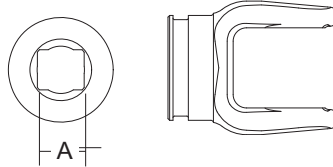

with Bearing Groove  
(Guard must rotate freely on yoke)

Stock Number	Dim. "A" Bore
300-1000	3/4" x 7/8" Rect.

## Tube Weld Yoke

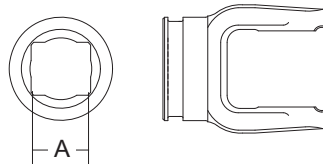

with Bearing Groove  
(Guard must rotate freely on yoke)

Stock Number	Dim. "A" Bore
700-1000	1" x 1-1/8"

## Implement Yoke

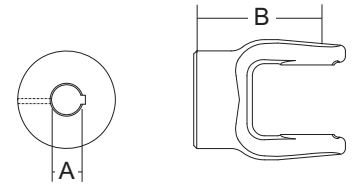

**Round Bore**  
Keyway & Set Screw

Stock Number	Dim. "A" Bore	Keyway	Dim. "B" Centerline
800-1010	5/8"	3/16" (.19)	2 1/2" (2.50)
10001-1044	5/8"	3/16" (.19)	1 11/16" (1.69)
10001-1045	3/4"	3/16" (.19)	2 1/2" (2.50)
10001-1038	3/4"	3/16" (.19)	1 11/16" (1.69)
10001-1056	3/4"	1/4" (.25)	2 1/2" (2.50)
800-1013	13/16"	1/4" (.25)	2 1/2" (2.50)
10001-1039	13/16"	1/4" (.25)	1 11/16" (1.69)
10001-1057	7/8"	3/16" (.19)	2 1/2" (2.50)
10001-1049	7/8"	1/4" (.25)	2 1/2" (2.50)
10001-1048	7/8"	1/4" (.25)	2 1/2" (2.50)
10001-1040	7/8"	1/4" (.25)	1 11/16" (1.69)
800-1015	15/16"	1/4" (.25)	2 1/2" (2.50)
800-1016	1"	3/16" (.19)	2 1/2" (2.50)
10001-1051	1"	1/4" (.25)	2 1/2" (2.50)
10001-1033	1"	1/4" (.25)	2 1/2" (2.50)
10001-1041	1"	1/4" (.25)	1 11/16" (1.69)
800-1017	1-1/16"	1/4" (.25)	2 1/2" (2.50)
10001-1053	1-1/8"	1/4" (.25)	2 1/2" (2.50)
10001-1052	1-1/8"	5/16" (.31)	2 1/2" (2.50)
800-1019	1-3/16"	5/16" (.31)	2 1/2" (2.50)
10001-1058	1-1/4"	1/4" (.25)	2 1/2" (2.50)
10001-1055	1-1/4"	5/16" (.31)	2 1/2" (2.50)
10001-1054	1-1/4"	5/16" (.31)	2 1/2" (2.50)
10001-1060	1-3/8"	5/16" (.31)	2 1/2" (2.50)
800-1022	1 3/8"	3/8"	2 1/2" (2.50)

**Spline Bore**  
with Set Screw

Stock Number	Dim. "A" Bore	Dim. "B" Centerline
801-1013	.901" x 13 Spl.	2-1/2" (2.50)
801-1018	1-1/8" x 6 Spl.	2-1/2" (2.50)

**Shear Pin**

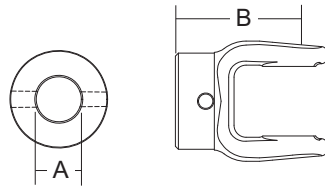

Stock Number	Dim. "A" Bore	Dim. "B" Centerline	Pinhole Size
802-1015	15/16"	2 1/2" (2.50)	11/32" (.34) #6 Taper
802-1016	1"	2 1/2" (2.50)	1/4" (.25)
10001-1059	1"	2 1/2" (2.50)	3/8" (.38)
802-1020	1 1/4"	2 1/2" (2.50)	5/16" (.31)
802-1024	1 1/2"	2 1/2" (2.50)	9/32" (.28)
10001-1034	1 1/2"	2 1/2" (2.50)	17/64" (.27)

**Round Bore**

Double Keyway & Set Screw

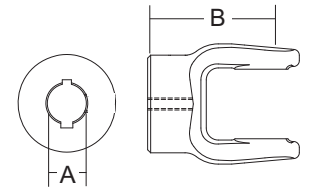

Stock Number	Dim. "A" Bore	Double Keyway	Dim. "B" Centerline
806-1012	3/4"	3/16" & 1/4"	2 1/2" (2.50)
806-1013	13/16"	3/16" & 1/4"	2 1/2" (2.50)
806-1014	7/8"	3/16" & 1/4"	2 1/2" (2.50)
806-1016	1"	3/16" & 1/4"	2 1/2" (2.50)
806-1018	1 1/8"	3/16" & 1/4"	2 1/2" (2.50)
10001-1061	1 1/8"	1/4" & 5/16"	2 1/2" (2.50)
806-1020	1 1/4"	1/4" & 5/16"	2 1/2" (2.50)
806-1019	1 3/16"	1/4" & 5/16"	2 1/2" (2.50)

**Square Bore**

with Set Screw

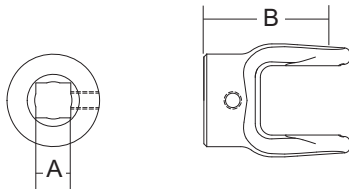

Stock Number	Dim. "A" Bore	Dim. "B" Centerline
804-1012	3/4"	2 1/2" (2.50)
10001-1042	3/4"	1 11/16" (1.69)
804-1014	7/8"	2 1/2" (2.50)
10001-1043	7/8"	1 11/16" (1.69)
804-1016	1"	2 1/2" (2.50)
804-1018	1 1/8"	2 1/2" (2.50)
10001-1037	1 1/8"	2 1/2" (2.50)

**Hexagon Bore**

with Set Screw

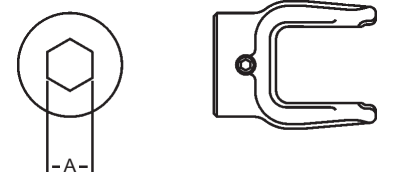

Stock Number	Dim. "A" Bore
805-1014	7/8"
805-1018	1 1/8"

**Square Bore**

with Pinhole

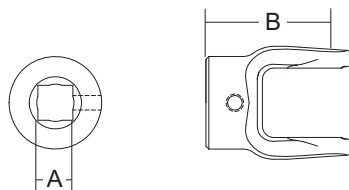

Stock Number	Dim. "A" Bore	Dim. "B" Centerline	Pinhole Size
10001-1035	3/4"	2 1/2" (2.50)	5/16" (.312)
10001-1036	1"	2 1/2" (2.50)	3/8" (3.75)

**Slip Sleeve Yoke**

**Square**

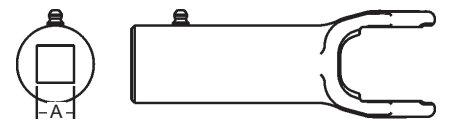

Stock Number	Dim. "A" Bore
808-1012	3/4"
808-1014	7/8"
808-1016	1"

**Slip Sleeve Yoke cont...**

**Round**

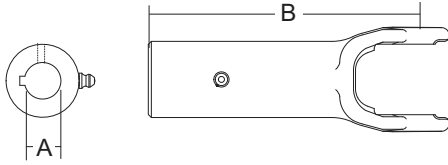

Stock Number	Dim. "A" Bore	Keyway	Dim. "B" Centerline
810-1012	3/4"	3/16"	5 1/2" (5.50)
810-1013	13/16"	1/4"	5 1/2" (5.50)
810-1014	7/8"	1/4"	5 1/2" (5.50)
810-1016	1"	1/4"	5 1/2" (5.50)
810-1018	1 1/8"	1/4"	5 1/2" (5.50)
10001-1062	1 1/8"	5/16"	5 1/2" (5.50)
810-1020	1 1/4"	1/4"	5 1/2" (5.50)
10001-1013	1 1/4"	5/16"	5 1/2" (5.50)
10001-1066	1 1/8"	1/4"	5 1/2" (5.50)

**Spline**

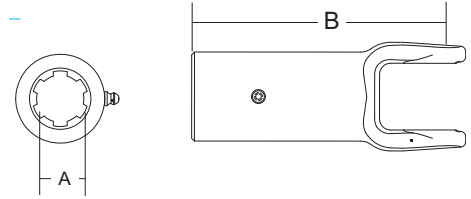

Stock Number	Dim. "A" Bore	Dim. "B" Centerline
812-1018	1 1/8" x 10 Spl.	5 1/2" (5.50)
812-1020	1 1/4" x 6 Spl.	5 1/2" (5.50)

**Hex**

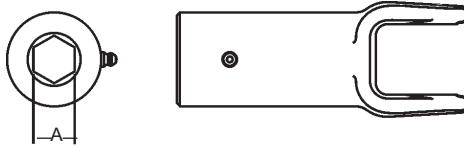

Stock Number	Dim. "A" Bore
811-1014	7/8"
811-1018	1 1/8"

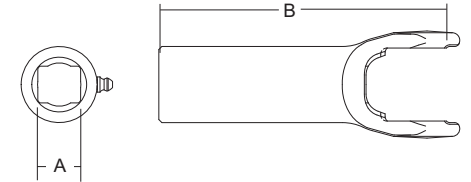

Stock Number	Dim. "A" Bore	Dim. "B" Centerline
813-1012	3/4" x 7/8"	5-1/2" (5.50)
10001-1014	7/8"	5-1/2" (5.50)
10001-1015	1"	5-1/2" (5.50)

**Guard**

Order Bearings As Required

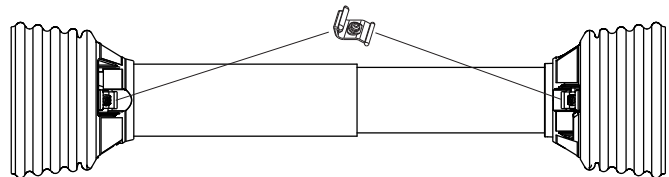

Stock Number	Overall Driveline Length	Bearing Kit (4-per kit)
900-2548	48"	921-0600
900-2560	60"	921-0600

Assembly instructions included with guard

Note: When installing Guards observe the following:

- 1) Install proper nylon bearing (See Page 13)
- 2) Guards must rotate freely on yokes

**Easy Lock™ Replacement Kit**

Part Number: 13005000 (4-per Kit)



## 1800 Series

Interchanges with Neapco

### Cross & Bearing Kit

Snap Ring Located in Bushing

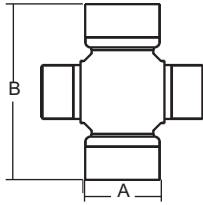

Stock Number	Dim. "A"	Dim. "B"
200-1875	1"	3 1/8"

## Vehicular Cross & Bearing Kit

Interchanges with Spicer

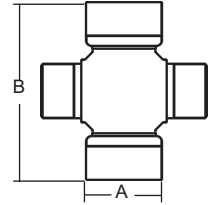

Stock Number	Spicer U - Joint Series	Dim. "A"	Dim. "B"
200-0310	1310	1 1/16"	3 7/32"
200-0350	1350	1 3/16"	3 5/8"
200-0410	1410	1 3/16"	4 3/16"

## 1 FR Series

### Cross & Bearing Kit

Snap Ring Located in Yoke

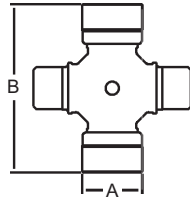

Stock Number	Dim. "A"	Dim. "B"
200-0100	7/8"	2 15/16"

## 14 Series

### Cross & Bearing Kit

Interchanges with Howse  
Snap Ring Located in Bushing

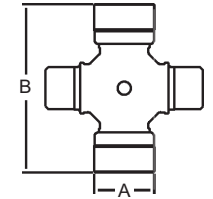

Stock Number	Dim. "A"	Dim. "B"
200-1401	1 1/8"	2 5/8"

## 3 DR Series

### Cross & Bearing Kit

Snap Ring Located in Yoke

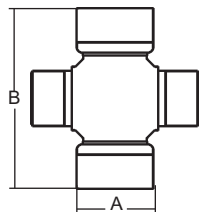

Stock Number	Dim. "A"	Dim. "B"
200-0300	1"	3 15/16"

## 35 Series

### Cross & Bearing Kit

Interchanges with Howse  
Snap Ring Located in Bushing

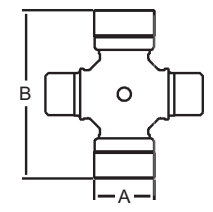

Stock Number	Dim. "A"	Dim. "B"
200-3501	1 1/4"	3 7/32"

# 2600 Series

Interchanges with Neapco & Walterscheid 1480

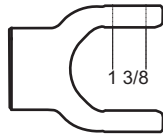

## Tractor Yoke

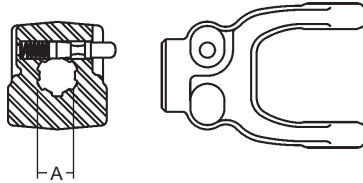

**Quick Disconnect**  
Repair Kit — Page 81

Stock Number	Dim. "A" Bore
102-2606	1 3/8" x 6 Spl.
102-2620	1 3/4" x 20 Spl.
102-2621	1 3/8" x 21 Spl.

## Shaft



1 5/16" Square

Stock Number	Length
400-0021	6'
401-0021	10'
404-0021	3'

## Cross & Bearing Kit

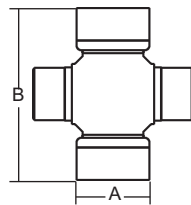

Snap Ring Located in Yoke

Stock Number	Dim. "A"	Dim. "B"
200-2600	1 3/8"	4 3/16"

## Slip Sleeve

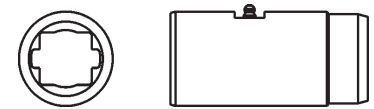

1 5/16" Square  
With Grease Groove

Stock Number	Length	Fits Tube Size
500-2600	5"	2 3/4" (.109 Wall)

## Shaft Weld Yoke

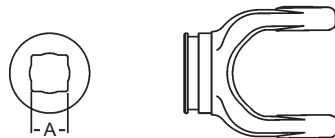

With Bearing Groove  
(Guards must rotate freely on the yoke)

Stock Number	Dim. "A" Bore
300-2600	1 5/16" Sq.

## Tube



2 3/4" (.109 Wall)

Stock Number	Length
602-2600	6'

## 2600 Series (cont'd.)

### Tube Weld Yoke

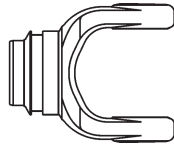

With Bearing Groove  
(Guards must rotate freely on the yoke)

Stock Number	Fits Tube Size
701-2600	2 3/4" (.109 Wall)

### Implement Yoke

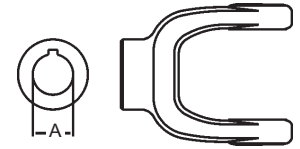

**Round Bore**  
With Keyway & Set Screw

Stock Number	Dim. "A" Bore	Standard Keyway
800-2622	1 3/8"	5/16"
800-2624	1 1/2"	3/8"
800-2628	1 3/4"	3/8"

### Guard

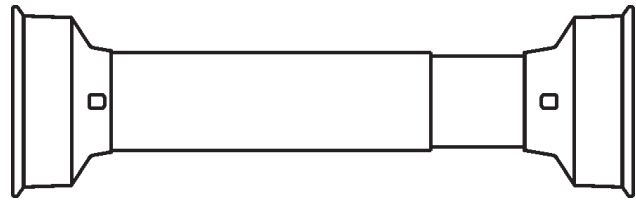

With Bearings (920-2600)

Stock Number	Overall Driveline Length
900-2648	48"

Assembly instructions included with guard

Note: When installing Guards observe the following:

- 1) Install proper nylon bearing and retainer (See page 13)
- 2) Guards must rotate freely on yokes

## Shafting



Stock Number	Size	Length
400-0012	3/4" Sq.	6'
400-0014	7/8" Sq.	6'
400-0015	15/16" Sq.	6'
400-0016	1" Sq.	6'
400-0019	1 3/16" Sq.	6'
400-0020	1 1/4" Sq.	6'
400-0021	1 5/16" Sq.	6'
400-1214	3/4" x 7/8" Rect.	6'
400-1618	1" x 1 1/8" Rect.	6'
401-0019	1 3/16" Sq.	10'
401-0021	1 5/16" Sq.	10'
401-1214	3/4" x 7/8" Rect.	10'
401-1618	1" x 1 1/8" Rect.	10'
402-0014	7/8" Hex	6'
402-0016	1" Hex	6'
402-0018	1 1/8" Hex	6'
402-0020	1 1/4" Hex	6'
404-0019	1 3/16" Sq.	3'
404-0021	1 5/16" Sq.	3'
404-1214	3/4" x 7/8" Rect.	3'
404-1615H	1" x 15 Spl. (Induction Hardened)	3'
404-1618	1" x 1 1/8" Rect.	3'
404-2120	1 5/16" x 20 Spl. (Induction Hardened)	3'
404-2720	1 11/16" x 20 Spl. (Induction Hardened)	3'

## Tubing



Stock Number	Size	Length
600-0012	1" Sq.	6'
600-0015	1 1/4" Sq. (.120 wall)	6'
600-0016	1 1/4" Sq. (.109 wall)	6'
600-0020	1 5/8" Sq.	6'
600-1618	3/4" x 7/8" Rect.	6'
600-2022	1 1/4" x 1 3/8" Rect.	6'
601-1618	3/4" x 7/8" Rect.	10'
601-2022	1 1/4" x 1 3/8" rect.	10'
602-0600	1 1/2" Rd.	6'
602-1400	2" Rd. (.083 wall)	6'
602-2600	2 3/4" Rd. (.109 wall)	6'
602-3500	2 1/8" Rd. (.120 wall)	6'
602-3501	2 1/8" Rd. (.083 wall)	6'
602-4400	2 1/2" Rd. (.120 wall)	6'
603-1400	2" Rd. (.083 wall)	10'
603-3500	2 1/8" Rd. (.120 wall)	10'
603-4400	2 1/2" Rd. (.120 wall)	10'
604-0600	1 1/2" Rd.	3'
604-1400	2" Rd. (.083 Wall)	3'
604-1618	3/4" x 7/8" Rect.	3'
604-2022	1 1/4" x 1 3/8" Rect.	3'
604-3500	2 1/8" Rd. (.120 Wall)	3'
604-4400	2 1/2" Rd. (.120 wall)	3'

## Shock Absorbing Flexible Coupling Disc

6" O.D.

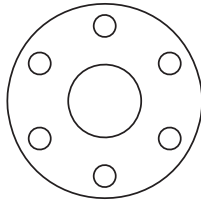

Stock Number	Description
970-2110	Disc only w/ 5/8" Holes
970-2108	Disc only w/ 1/2" Holes

## Spider

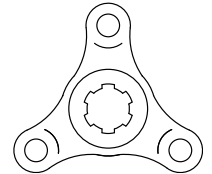

Stock Number	Description
81011-1016	1 3/8" x 6 Spl. with 5/8" Bolt Hole
81011-1053	1 3/8" x 6 Spl. with 21/64" Pinholes & 5/8" Bolt Hole
81021-1097	1 3/4" Rd. with 3/8" Keyway & 5/8" Bolt Hole

# Nylon Bearing Repair Kit

(Kit includes nylon bearing and retainer)

## NOTE!

Not all guard and bearing systems are interchangeable. When purchasing shaft weld and tube weld yokes or guards, make certain there is a proper fit between nylon bearing raceway in yoke and guard.

It is essential that the proper nylon bearing is identified and installed to insure proper performance and safety. To assist in ordering the proper nylon bearing, listed below are stock numbers and dimensions for our standard aftermarket and OEM nylon bearings.

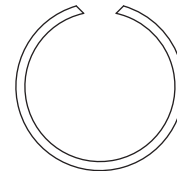
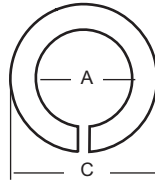
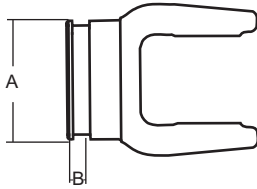

Stock Number	Dim. "A" Yoke Raceway O.D. Nylon Bearing I.D.	Dim. "B" Yoke Raceway Width Nylon Bearing Width	Dim. "C" Nylon Bearing O.D.
920-0017	2 1/8" (2.125")	3/8" (.375")	2 3/4" (2.75")
920-0069	1 3/4" (1.75")	3/8" (.375")	2 3/4" (2.75")
920-0085	2" (2.0")	3/8" (.375")	2 3/4" (2.75")
920-0102	1 3/8" (1.375")	11/32" (.3437")	2" (2.0")
920-0141	1 5/8" (1.625")	11/32" (.3437")	2 3/4" (2.75")
920-0165	2 1/8" (2.125")	3/8" (.375")	3 1/4" (3.25")
920-0195	1 3/4" (1.75")	3/8" (.375")	2 1/2" (2.50")
920-0254	1 5/8" (1.625")	11/32" (.3437")	2 1/4" (2.25")
920-0259	2" (2.0")	3/8" (.375")	3 1/4" (3.25")
920-0260	2 17/32" (2.530")	33/64" (.358")	2 49/64" (2.770")
920-0600	1 13/16" (1.825")	9/32" (.2812")	2 3/4" (2.75")
920-1200	2 1/16" (2.0625")	11/32" (.3437")	2 3/4" (2.75")
920-2600	2 7/8" (2.875")	11/32" (.3437")	3 9/16" (3.5625")
920-3500	2 1/16" (2.0625")	11/32" (.3437")	2 3/4" (2.75")
920-4400	2 5/8" (2.625")	3/8" (.375")	3 1/4" (3.25")
920-4P15	1 21/32" (1.646")	11/32" (.358")	2 3/4" (2.76")
920-4P16	1 25/32" (1.770")	11/32" (.358")	2 3/4" (2.76")
920-5071	2 1/32" (2.021")	11/32" (.358")	2 3/4" (2.76")
920-5084	2 5/32" (2.146")	11/32" (.358")	2 3/4" (2.76")
920-4N15	1 61/64" (1.947")	9/32" (.291")	2 1/4" (2.25")
920-4N16	2 1/8" (2.125")	21/64" (.341")	2 1/2" (2.50")

## NOTE!

All Series North American guards are provided without nylon bearings. To help assure the proper set of nylon bearings are installed, one nylon bearing set will be exactly the same (nylon bearing raceway dimensions) as has always been provided in our aftermarket guards. The other set will be dimensioned to retrofit the Weasler OEM raceway. Assembly instructions included with these nylon bearing kits.

## Locking Device

---

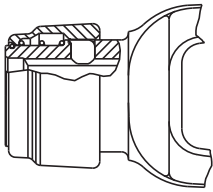

### Safety Slide Lock\*

An exclusive Weasler replacement component, the Safety Slide Lock\* yoke is locked in place by two hardened pawls with compound radii that conform to the groove

in the shaft for full contact. The device is particularly applicable where there is appreciable end thrust.

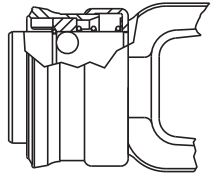

### Spring-Lok\*

The collar is spring loaded for ease of installation and positive locking to tractor shaft.

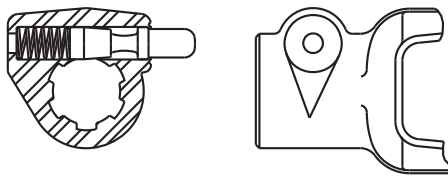

### Quick Disconnect

A smooth plunger eliminates sharp projections such as x-washers. Trails rather than leads rotation.

## Locking Device Repair Kit

---

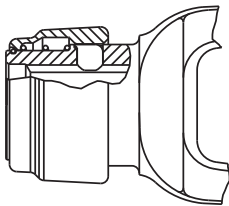

### \*Auto-Lok/Safety Slide Lock

Stock No. 13004000

Repair Kit for Weasler Auto-Lok and Safety Slide Lock  
6 Spline & 21 Spline

Stock No. 13004020

Repair Kit for Weasler Auto-Lok and Safety Slide Lock  
20 Spline

Stock No. 13004015

Repair Kit for 1" x 15 Spl.

\* This repair kit contains both balls & pawls. When repairing the "Safety Slide Lock" use the pawls only and discard the balls. When repairing the "Auto-Lok" use both the balls and the pawls.

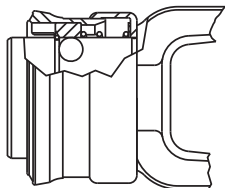

### Spring-Lok

Stock No. 13003100

Repair Kit for Weasler Spring-Lok  
6 Spline & 21 Spline

Stock No. 13003115

1" x 15 Spline

### Quick Disconnect

Stock No. 13002006

Repair Kit for Weasler and Rockwell 6 Spline  
Repair Kit for 1 3/4" x 6 Spl.

Stock No. 13002806

Stock No. 13002021

Weasler 21 Spline and  
Hex Quick Disconnect

Stock No. 13002020

Weasler 20 Spline

